

Sabula Municipal Boat Landing

Isaac Mize, Larry Phan, Caleb Wright
Department of Civil and Environmental Engineering
University of Iowa
May 5th, 2022

*Sabula:
Iowa's Island City*

Sabula: Iowa's Island City

We are excited to present our reimagining of Sabula's front door to the Mississippi River. An improved boat landing and dock, coupled with a new pavilion with restrooms and a storm shelter will create an inviting outdoor space for residents, boaters, and visitors.



Figure 1. Site Plan of the Sabula Municipal Boat Landing



Figure 2. Construction Cost Estimate

Pavilion: Featuring Restrooms and Storm Shelter

Located next to the new playground, the new pavilion design provides more space for families and events. The new pavilion features knee walls on the east side to contain toddlers, outlets, and counterspace, making this an ideal location for cookouts and family gatherings.

The new restroom facility is also conveniently located right underneath the pavilion. The restrooms are designed to withstand strong storms, creating a safe location for boaters and visitors during severe weather.

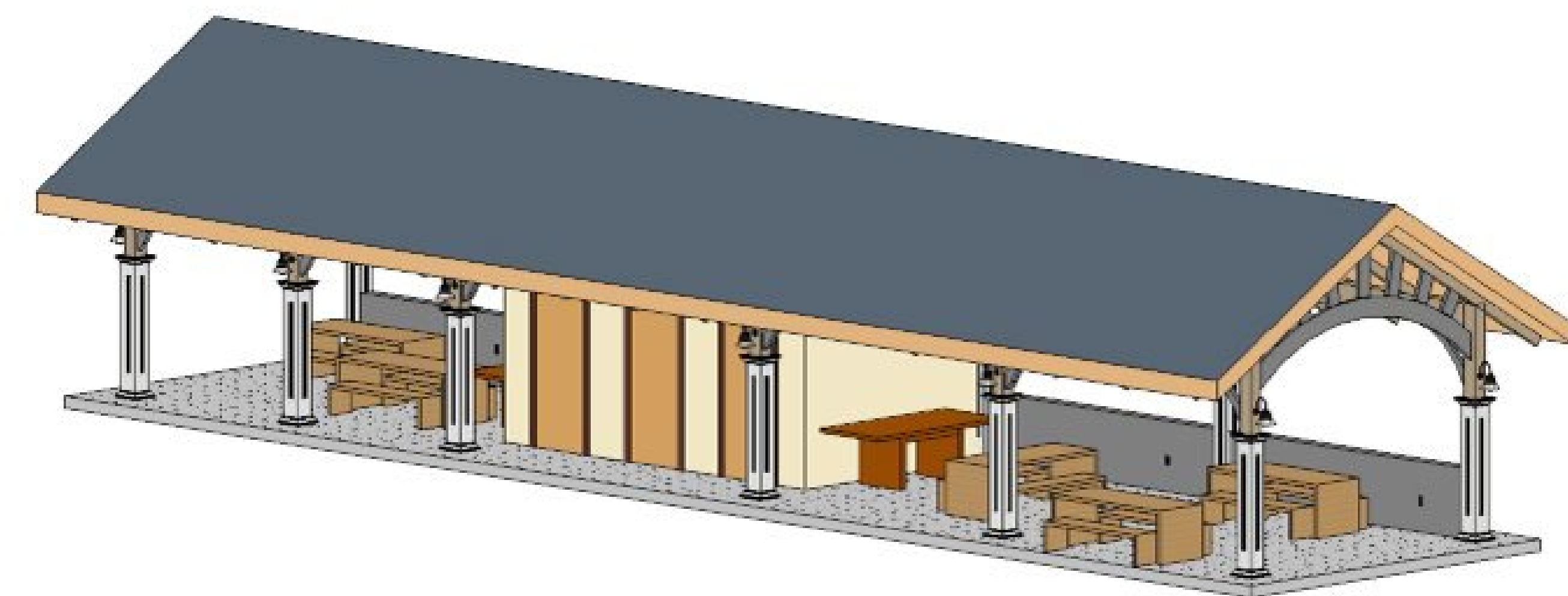

Figure 3. Architectural Render of the Pavilion and Restroom Facility

Wayfinding and Tourism Board



Figure 4. Wayfinding Board—featuring parking directions, city restaurants and amenities, and emergency information.

A Boat Ramp and More

The Sabula Municipal Boat Landing project will reinvigorate the site by improving the accessibility of the dock and ramp while also improving the site's facilities, creating an inviting and safe outdoor environment for the citizens and visitors of Sabula.

Improved Ramp and Dock Accessibility

To increase the capacity of the dock, additional dock sections have been added to the site, providing room for up to 5 boats to tie off to. The boat ramp will also be reconstructed and extended into the river, making it easier to put in and remove your boat trailer from the water. Temporary trailer parking is also available, providing a dedicated space to queue your trailer while the ramp is in use.