

CITY OF KEOKUK, IA RECREATIONAL RIVER ACCESS



Jarod Erlandson, Patrick Maston, and Nick Nelson
Civil Engineering Department Senior Design Capstone Project
The University of Iowa



Site Location

The project is located in Keokuk, IA off of River Road positioned along the Mississippi River between Prices Creek and Athens Avenue. Also, the site location is about ¼ of a mile north of the Keokuk Yacht Club and runs parallel with the BNSF Railroad.



Figure 1 (left), Figure 2 (upper right), and Figure 3 (bottom right): Figure 1 is the site location relative to city surroundings, Figure 2 is the current site condition looking eastward, and Figure 3 is a bird's eye view of the project location.

Project Features

Features of the new construction project include three boat launches, multiple docks, a parking lot, bathroom facility, green space, and two-way directional traffic flow of the parking lot and roadway. Exterior improvements such as park benches and fishing piers have been recommended to be installed as well.



Figure 4 (upper left), Figure 5 (lower left), Figure 6 (upper center), Figure 7 (lower center), and Figure 8 (right): Figures 4 and 5 are replicas of the proposed boat launch and boat dock, Figures 6 and 7 are examples of the proposed CMU block for the bathroom facility, and Figure 8 is a similar design located in Guttenberg, IA.

Project Site Plan & Detail

Several site plans located within the drawing set include the geometric layout of the access road, geometric layout of the levee, and the geometric layout of the parking lot. The drawing set also contains specific details such as soil information, boat dock details, boat launch details, etc.

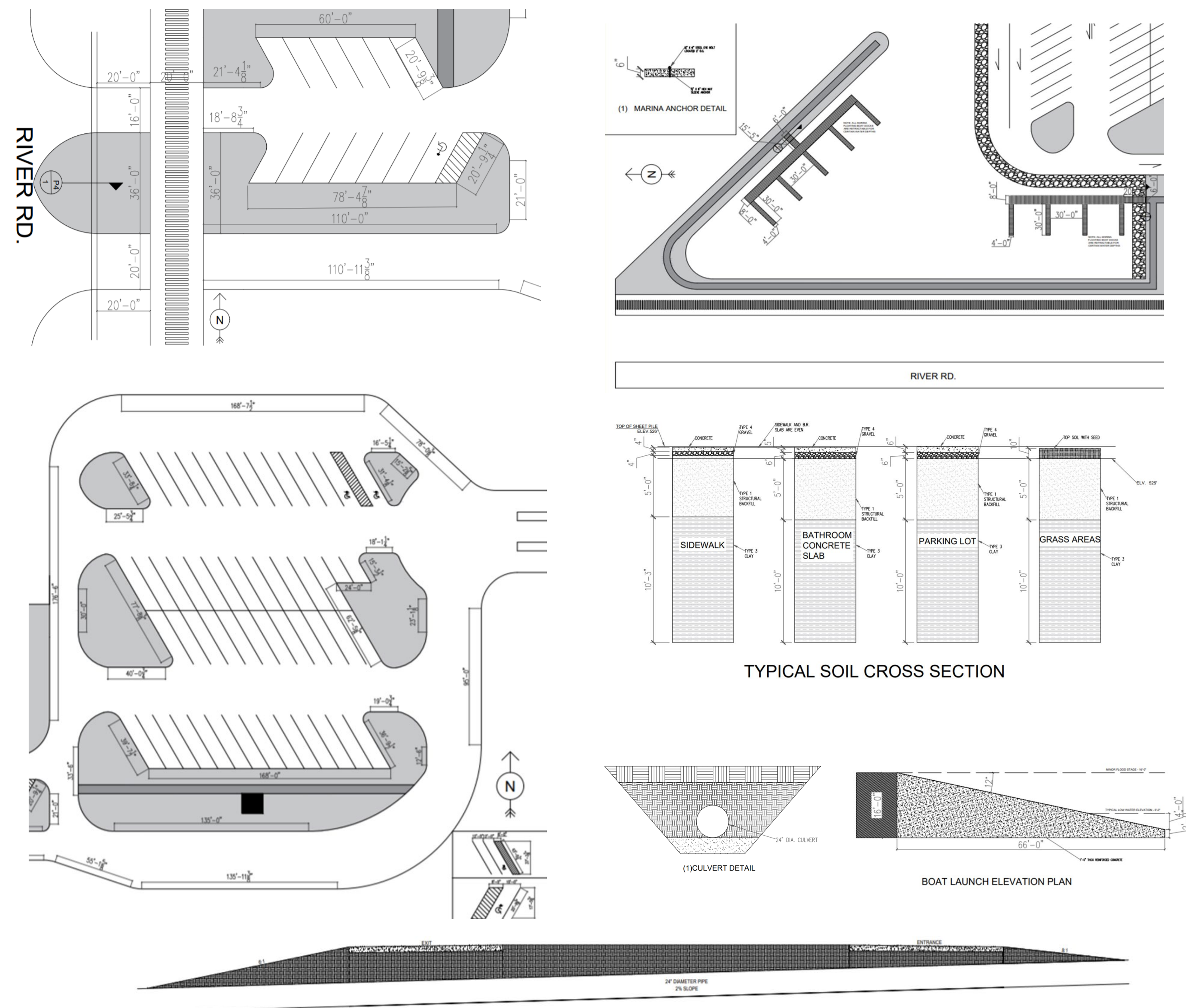

All above images can be found in the drawing set provided by the senior design team. Please see drawing set provided by the senior design team for more information regarding site plans and details.

Final Design

Final Design plans and images have been provided in both the drawing set and final report. Below are images portraying the final proposed site plan along with the proposed site elevation for the Recreational River Access Project. Additionally, the recommended project phasing, including cost information, has been provided below.

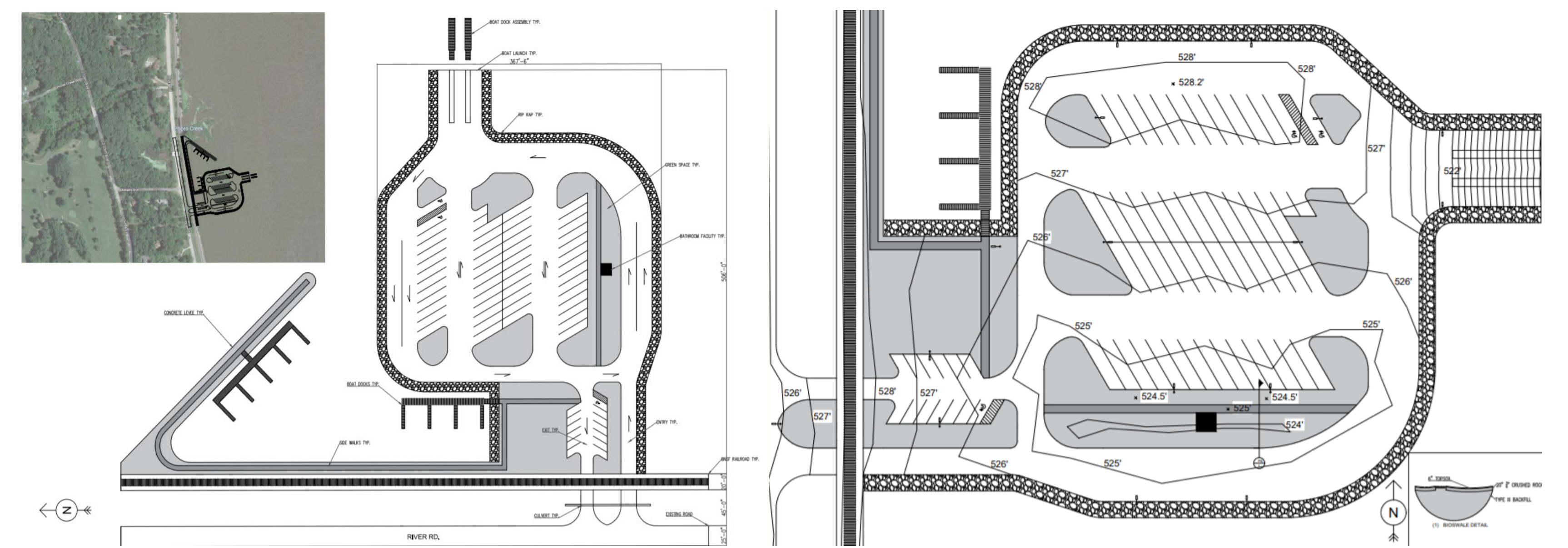

All above and below images can be found in the drawing set and final report provided by the senior design team. Please see drawing set provided by the senior design team for more information regarding site plans and details.

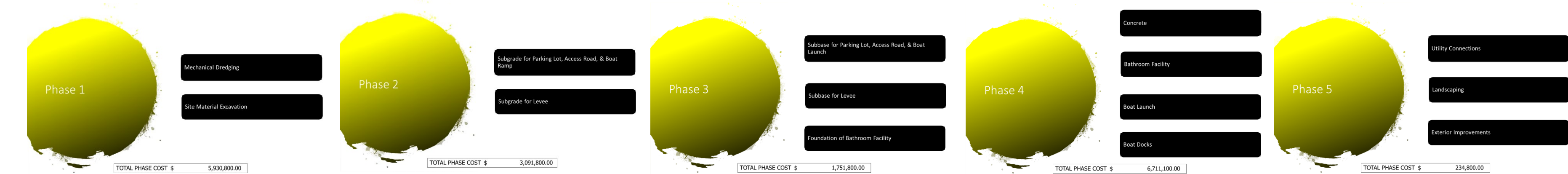

Standards, Guidelines, & Specifications

Iowa Department of Transportation Design Manual
Iowa Department of Transportation Construction Manual
Iowa Department of Transportation SUDAS Manual

RS Means Data
US Department of Commerce
US Army Corps of Engineers

Iowa DNR Division 35
Iowa DNR State Parks Design Guide