

MLDC Engineering Co.

Cedar Prairie Trail Bridge Replacement

Option 1: Western Trail Alignment

Waterloo, IA

Owner Contact Information:

Jamie Knutson – jamie.knutson@waterloo-ia.org
 Wayne Castle – wayne.castle@waterloo-ia.org

<u>Index of Drawings</u>	<u>Sheet No.</u>
Design Overview	1
Plan and Profile Sheets	2 – 4
Cross Sections	5 – 7
Total Volume Tables	8
Material Tables	9
Bridge Design	10 – 12
Site Grading Plan	13 – 14

Tabulation of Length, Elevation, and Design Data

Length: 2393.34 ft = 0.46 miles

Elevation

start: 865.4 ft
 at bridge abutments: 862.0 ft
 end: 868.03 ft

Design Data

minimum radius: 115 ft
 maximum grade: 5.00 %
 minimum sag K-value: 12
 minimum crest K-value: 26
 maximum design speed: 25 mph

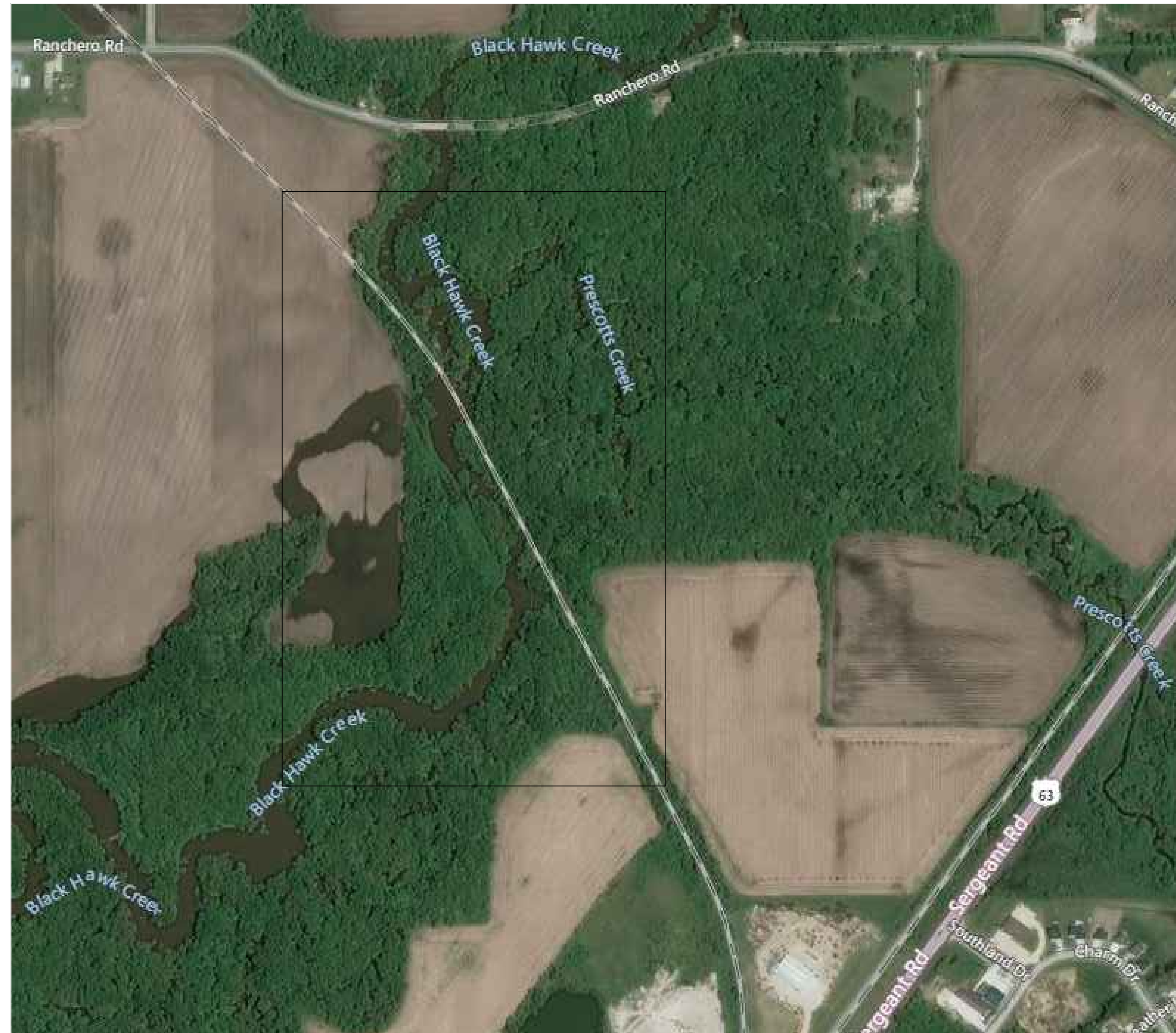

PROJECT: CEE: 4850	DATE : 05/06/21	DRAWN BY: MICHELLE NITSCHKE
		REVISION:

THE UNIVERSITY OF IOWA
CIVIL AND ENVIRONMENTAL ENGINEERING
 4105 SEAMANS CENTER FOR THE
 ENGINEERING ARTS AND SCIENCES
 103 S CAPITOL ST
 IOWA CITY, IOWA 52242
 PHONE: 319.335.5647
 FAX: 319.335.5660
 EMAIL: civil-hawks@iowa.edu

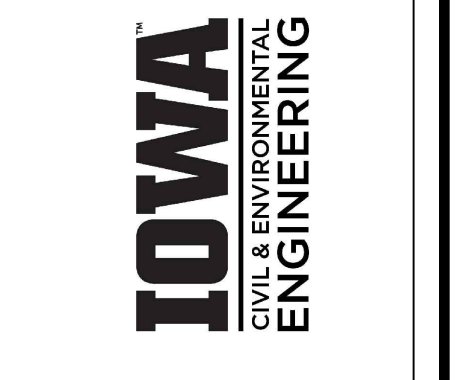

EDUCATIONAL - NOT
 FOR CONSTRUCTION

BRIDGE REPLACEMENT

CEDAR PRAIRIE TRAIL
 WATERLOO, IA

SHEET NAME
 WESTERN ALT.
 TITLE SHEET

SHEET NO.
T-1

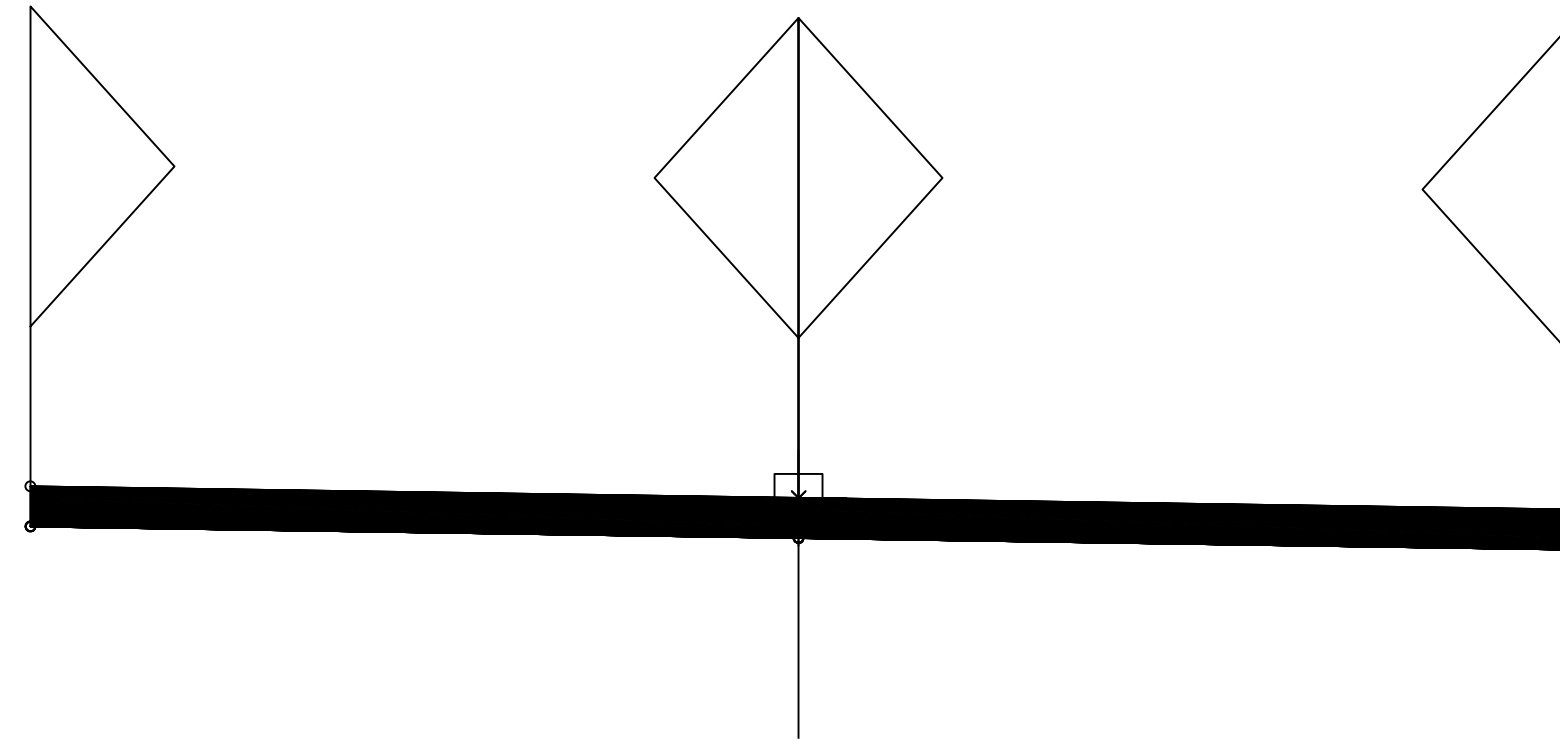

Pavement Cross Section

Trail Pavement Design

12 ft wide path – 5” asphalt

2 ft wide shoulders on either side – soil/grass

1.5% slope down toward Black Hawk Creek

*Notes: considering adding 6” subgrade below asphalt

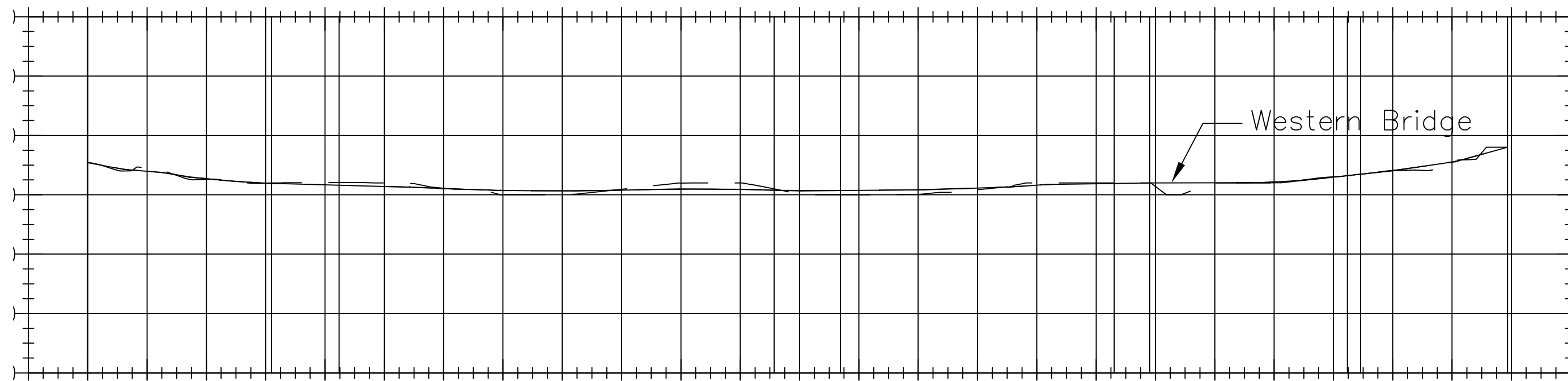

Vertical Alignment



Horizontal Alignment

PROJECT:	CEE: 4850
DATE :	05/06/2021
DRAWN BY:	MICHELLE NITSCHKE
REVISION:	

THE UNIVERSITY OF IOWA
CIVIL AND ENVIRONMENTAL ENGINEERING
 4105 SEAMANS CENTER FOR THE
 ENGINEERING ARTS AND SCIENCES
 103 S CAPITOL ST
 IOWA CITY, IOWA 52242
 PHONE: 319.335.5647
 FAX: 319.335.5660
 EMAIL: civil-hawks@iowa.edu

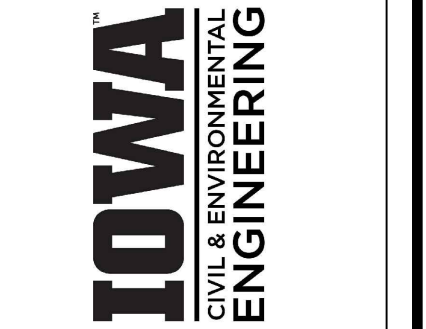

EDUCATIONAL - NOT FOR CONSTRUCTION

BRIDGE REPLACEMENT
 CEDAR PRAIRIE TRAIL
 WATERLOO, IA

SHEET NAME
 WESTERN ALT.
 DESIGN OVERVIEW

SHEET NO.
1

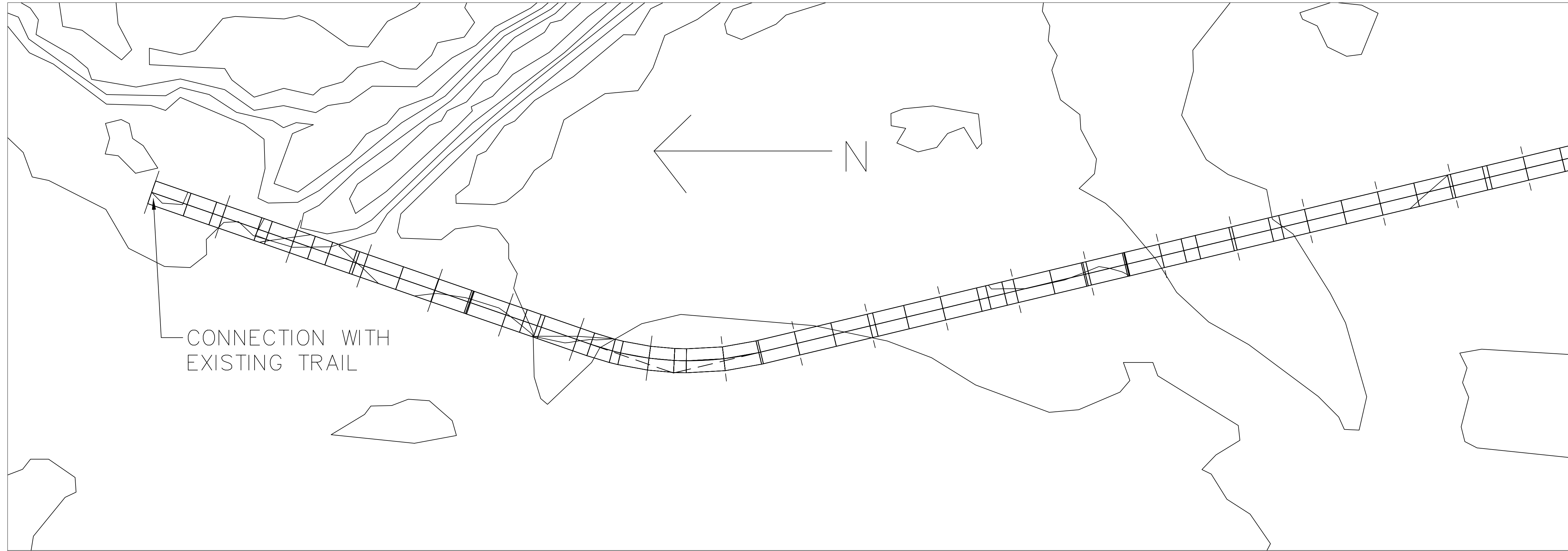

horizontal alignment PROFILE

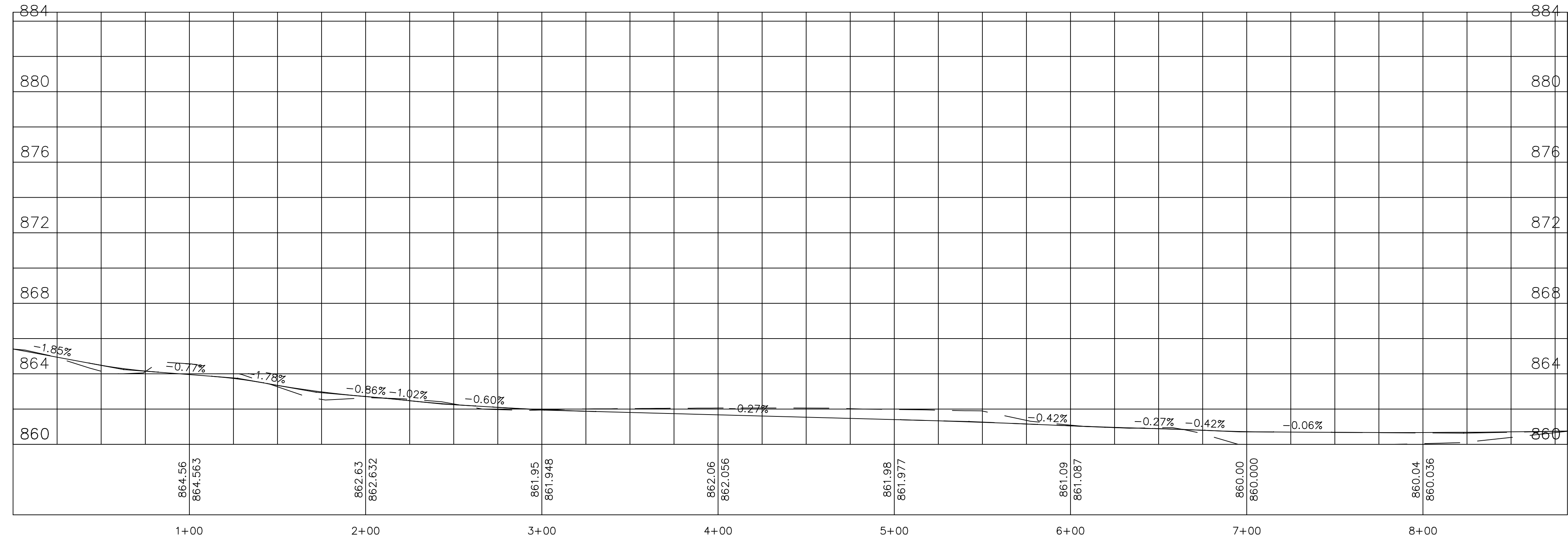

PROJECT: CEE: 4850
 DATE : 05/06/21
 DRAWN BY: MICHELLE NITSCHKE
 REVISION:

THE UNIVERSITY OF IOWA
CIVIL AND ENVIRONMENTAL ENGINEERING
 4105 SEAMANS CENTER FOR THE
 ENGINEERING ARTS AND SCIENCES
 103 S CAPITOL ST
 IOWA CITY, IOWA 52242
 PHONE: 319.335.5647
 FAX: 319.335.5660
 EMAIL: civil-hawks@iowad.edu



EDUCATIONAL - NOT FOR CONSTRUCTION

BRIDGE REPLACEMENT

CEDAR PRAIRIE TRAIL
 WATERLOO, IA

SHEET NAME
 WESTERN ALT.
 PLAN & PROFILE 1

SHEET NO.
2

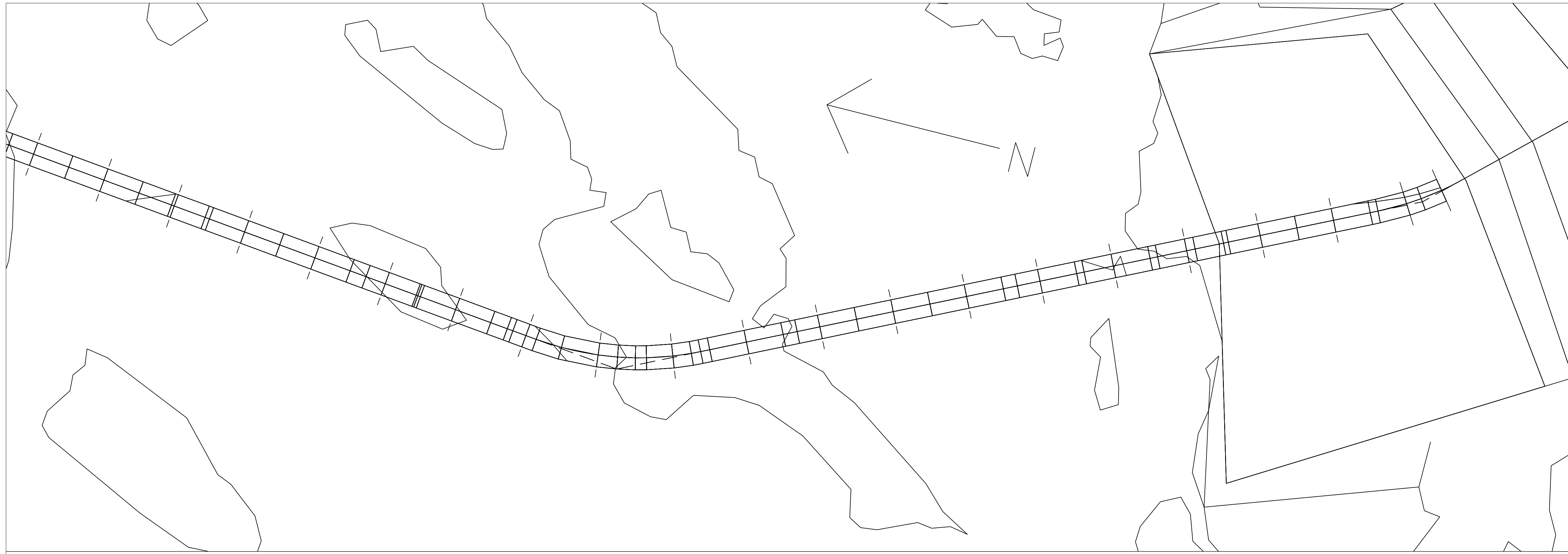

horizontal alignment PROFILE

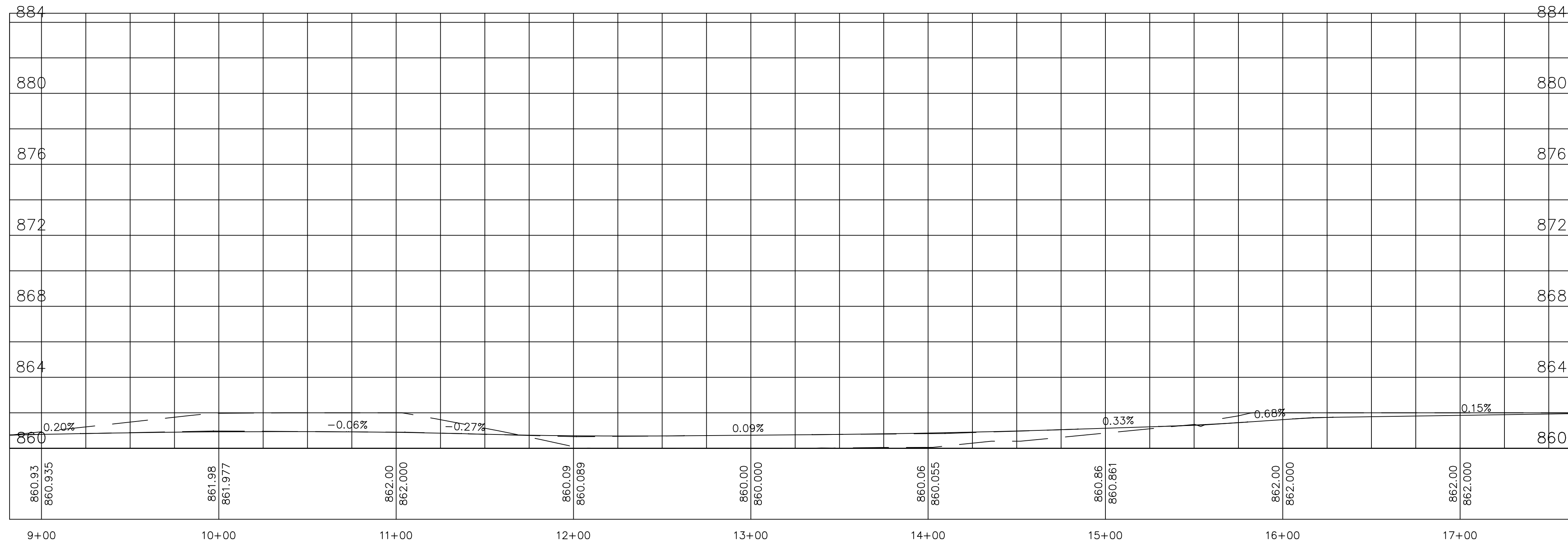

PROJECT: CEE: 4860
 DATE : 05/06/21
 DRAWN BY: MICHELLE NITSCHKE
 REVISION:

THE UNIVERSITY OF IOWA
CIVIL AND ENVIRONMENTAL ENGINEERING
 4105 SEAMANS CENTER FOR THE
 ENGINEERING ARTS AND SCIENCES
 103 S CAPITOL ST
 IOWA CITY, IOWA 52242
 PHONE: 319.335.5647
 FAX: 319.335.5660
 EMAIL: civil-hawks@iowa.edu



EDUCATIONAL - NOT FOR CONSTRUCTION

BRIDGE REPLACEMENT

CEDAR PRAIRIE TRAIL
 WATERLOO, IA

SHEET NAME
 WESTERN ALT.
 PLAN & PROFILE 2

SHEET NO.
3

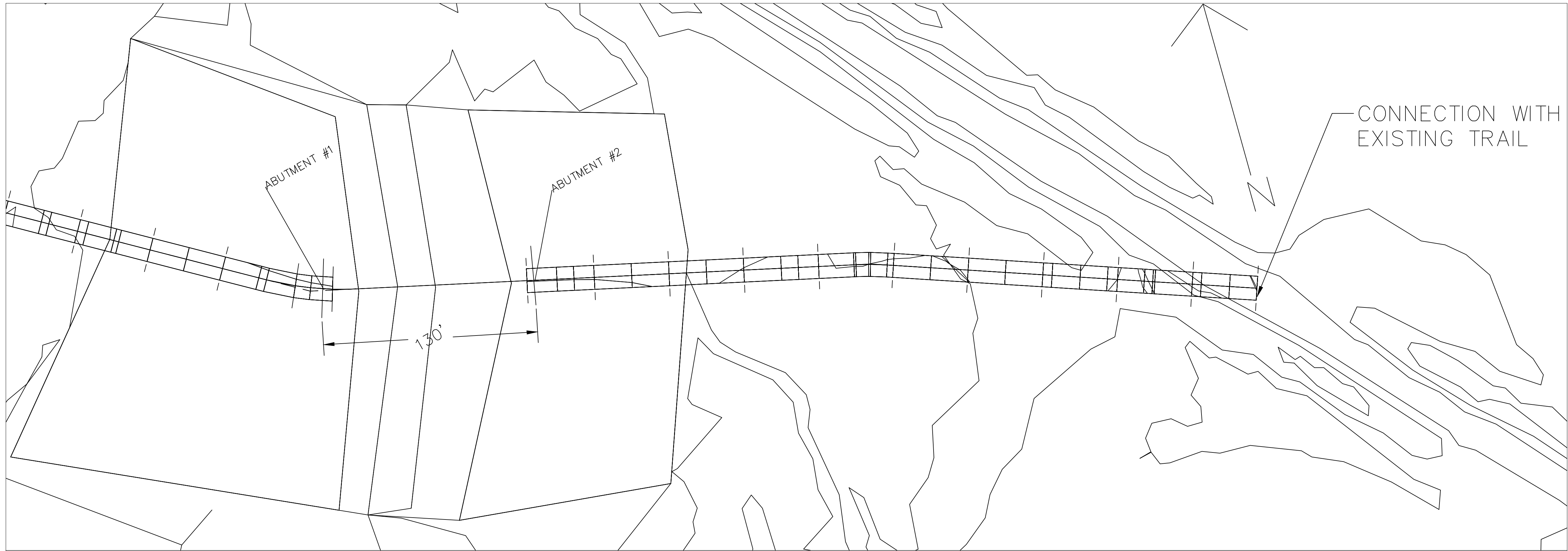

horizontal alignment PROFILE

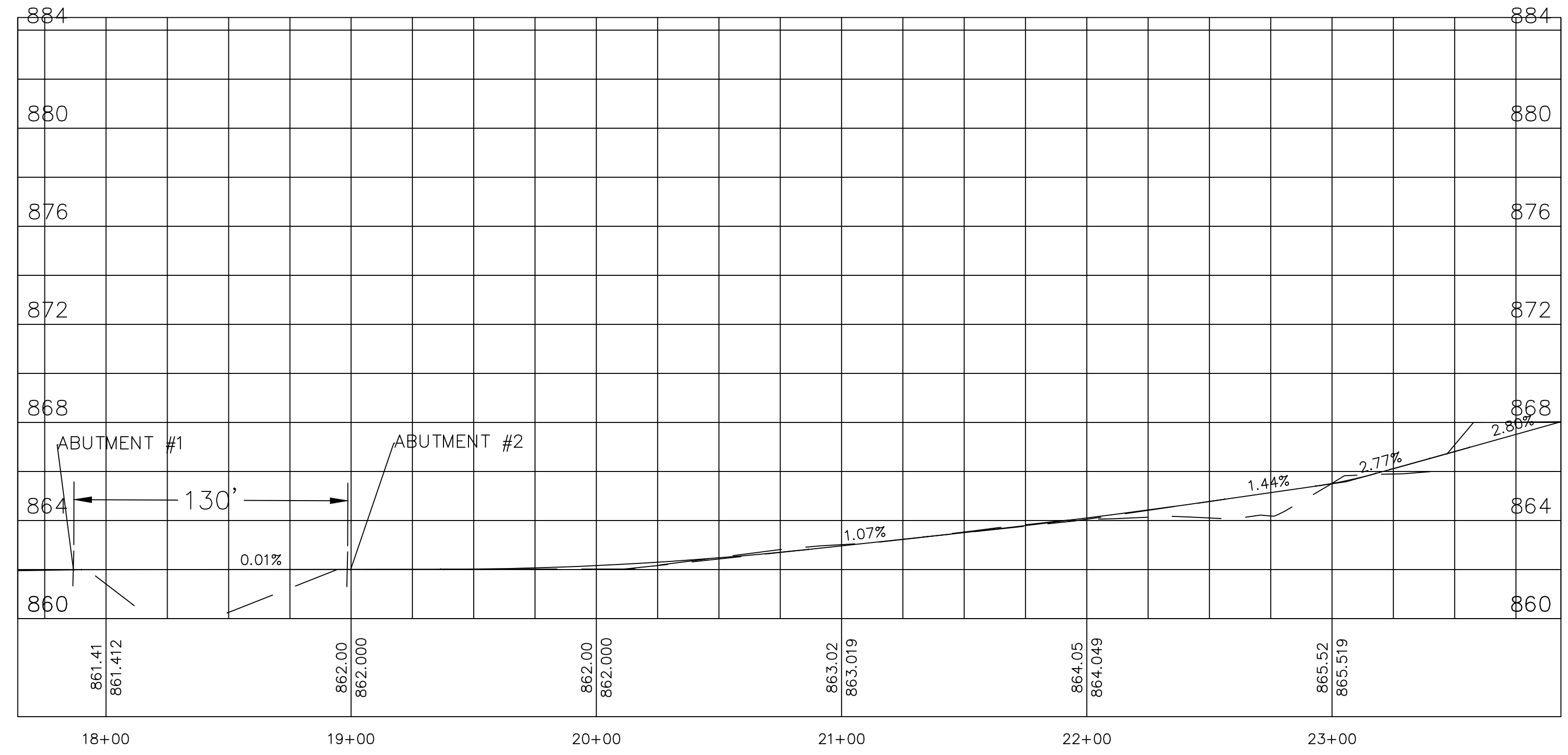

PROJECT: CEE: 4850
 DATE: 05/06/21
 DRAWN BY: MICHELLE NITSCHKE
 REVISION:

THE UNIVERSITY OF IOWA
CIVIL AND ENVIRONMENTAL ENGINEERING
 4105 SEAMANS CENTER FOR THE
 ENGINEERING ARTS AND SCIENCES
 103 S CAPITOL ST
 IOWA CITY, IOWA 52242
 PHONE: 319.335.5647
 FAX: 319.335.5660
 EMAIL: civil-hawks@iowa.edu



EDUCATIONAL - NOT FOR CONSTRUCTION

BRIDGE REPLACEMENT

CEDAR PRAIRIE TRAIL
 WATERLOO, IA

SHEET NAME
 WESTERN ALT.
 PLAN & PROFILE 3

SHEET NO.
4

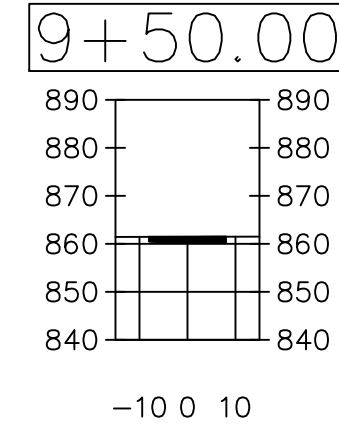
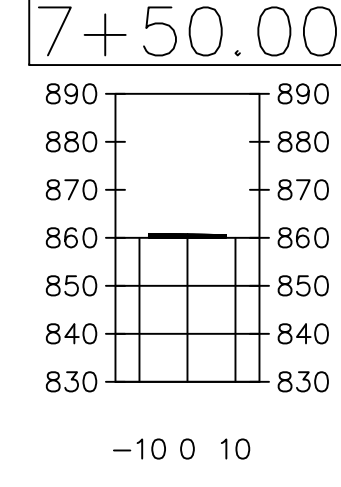
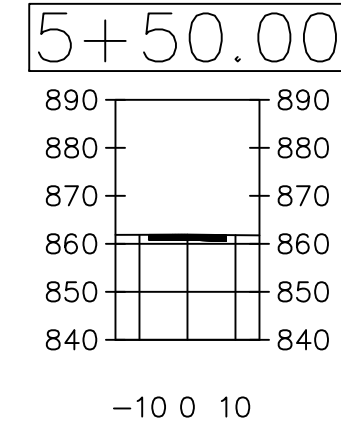
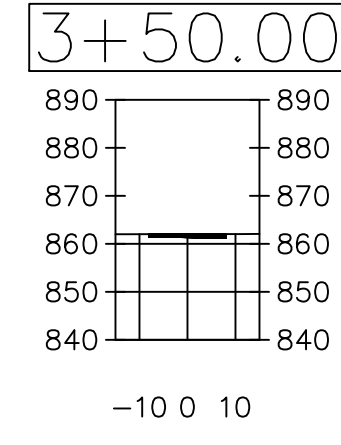
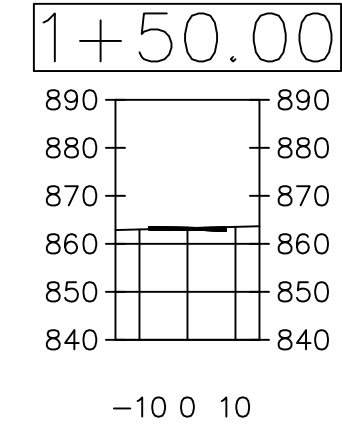
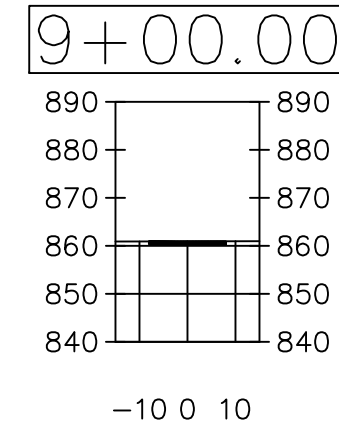
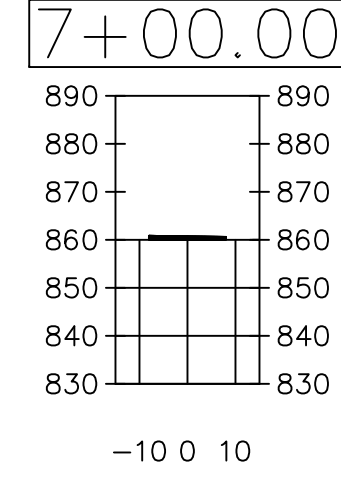
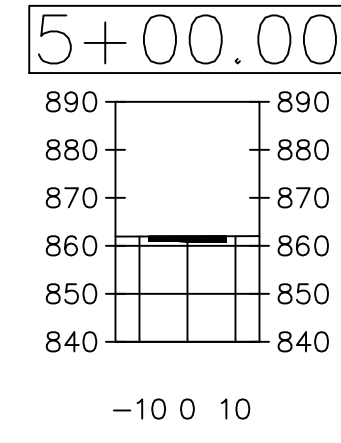
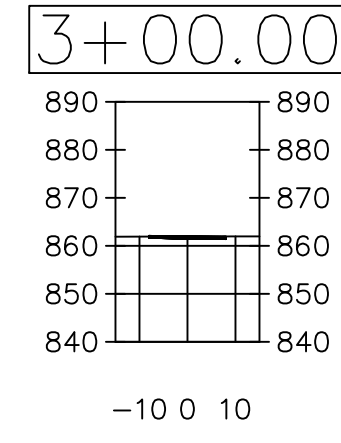
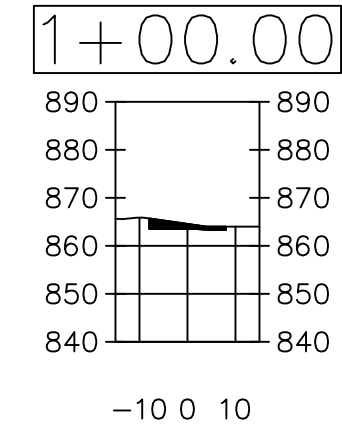
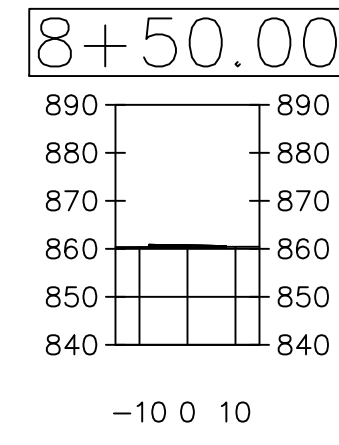
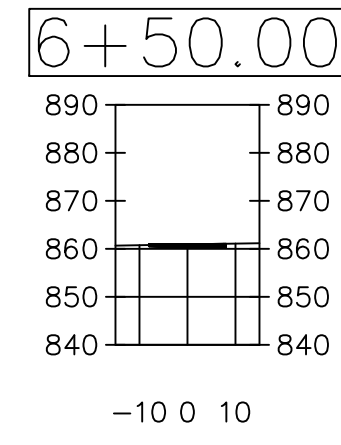
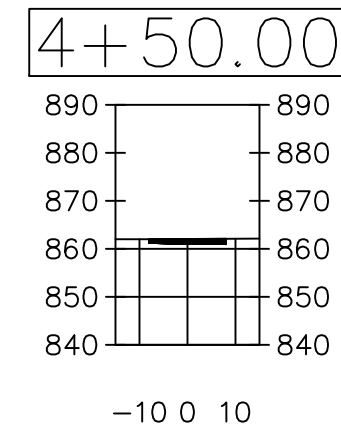
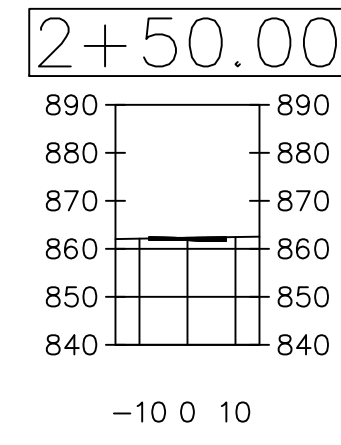
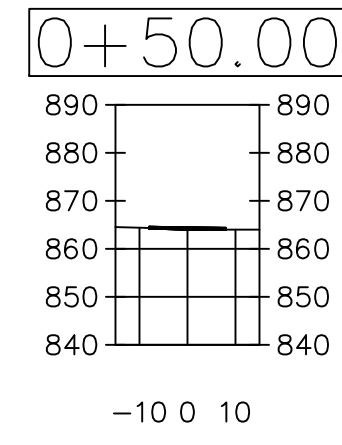
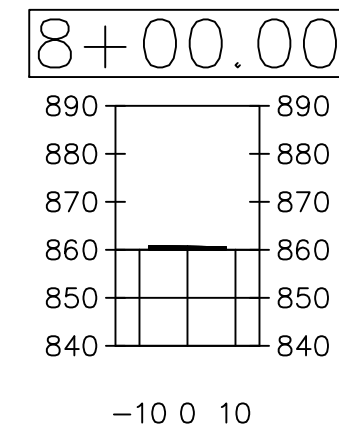
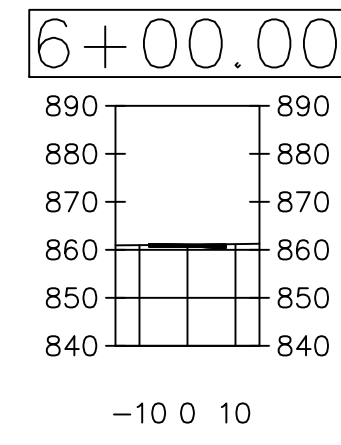
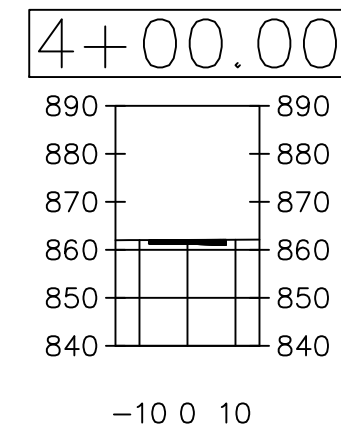
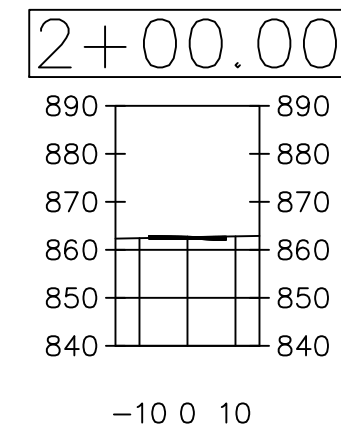
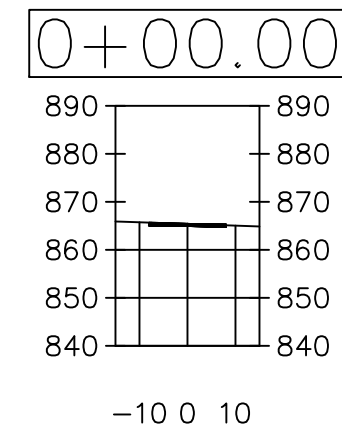

PROJECT: CEE: 4850
 DATE: 05/06/21
 DRAWN BY: MICHELLE NITSCHKE
 REVISION:

THE UNIVERSITY OF IOWA
CIVIL AND ENVIRONMENTAL ENGINEERING
 4105 SEAMANS CENTER FOR THE
 ENGINEERING ARTS AND SCIENCES
 103 S CAPITOL ST
 IOWA CITY, IOWA 52242
 PHONE: 319.335.5647
 FAX: 319.335.5660
 EMAIL: civil-hawks@iowa.edu

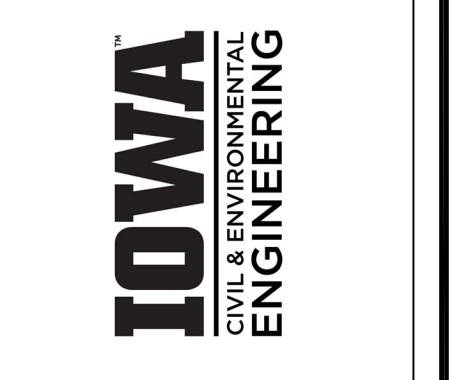

EDUCATIONAL - NOT
 FOR CONSTRUCTION

BRIDGE REPLACEMENT
 CEDAR PRAIRIE TRAIL
 WATERLOO, IA

SHEET NAME
 WESTERN ALT.
 CROSS SECTIONS 1

SHEET NO.
5

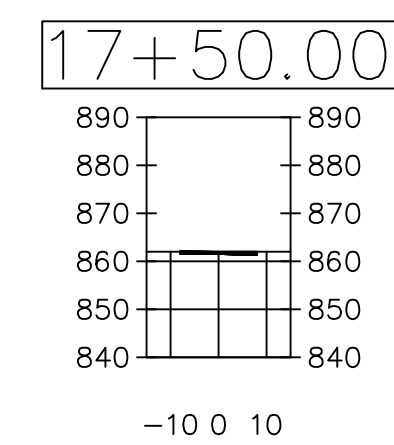
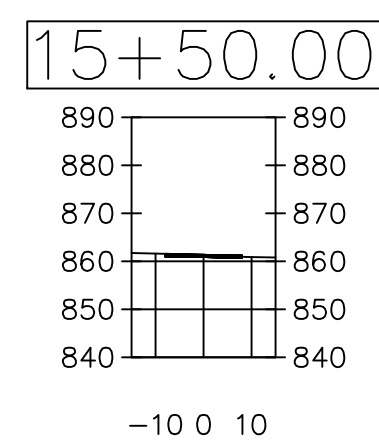
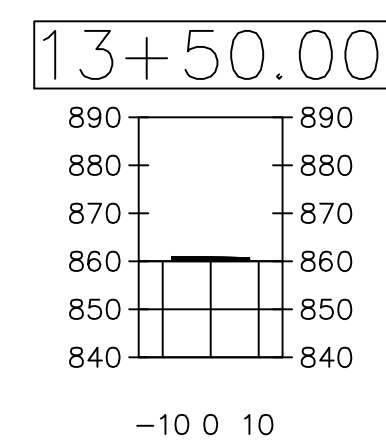
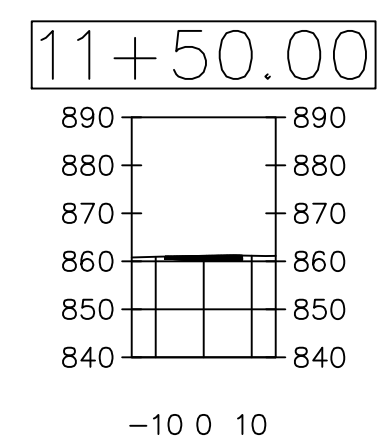
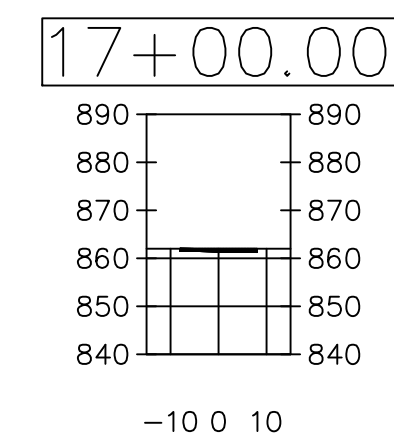
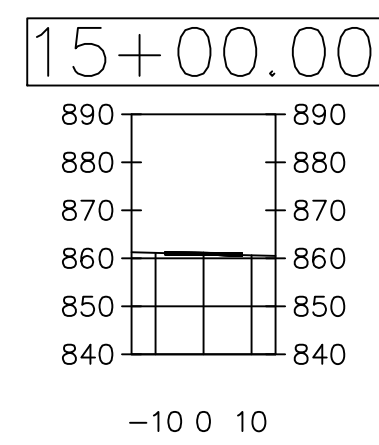
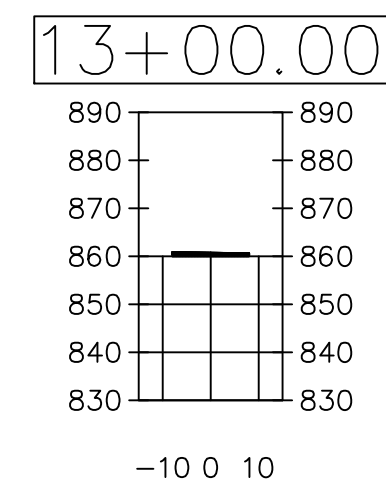
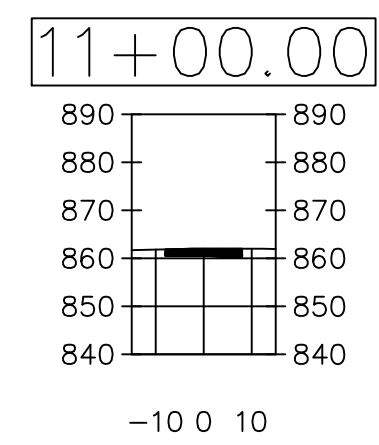
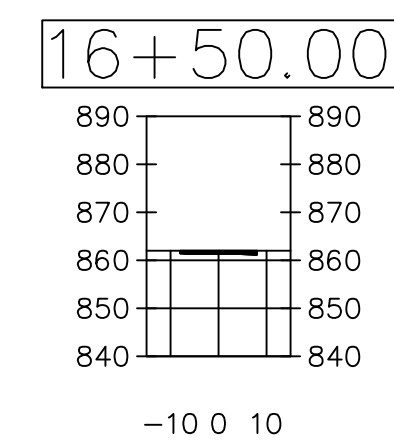
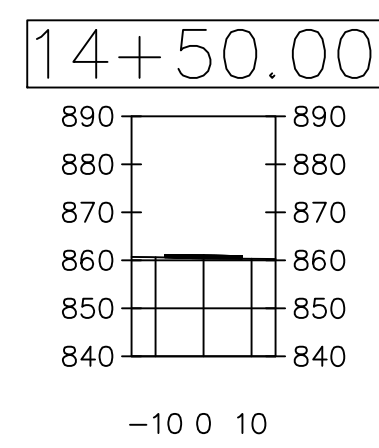
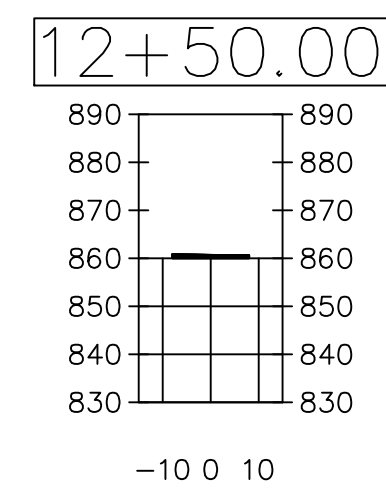
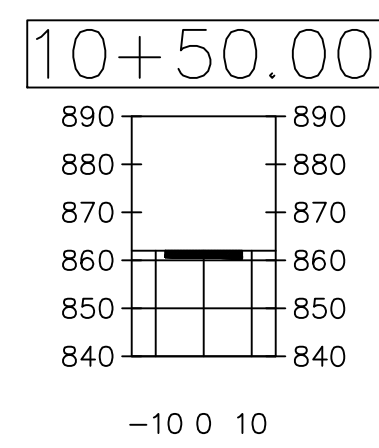
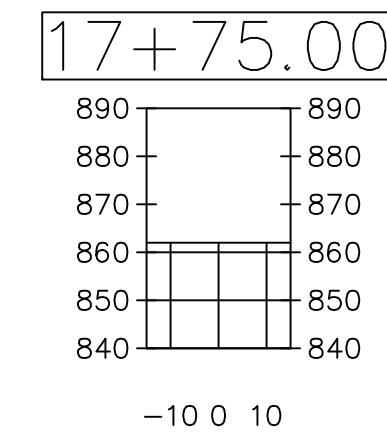
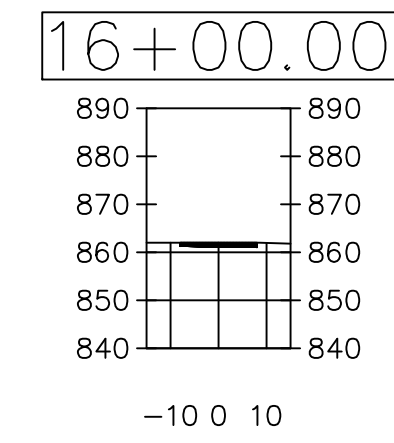
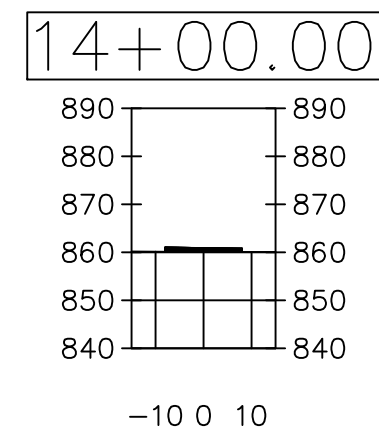
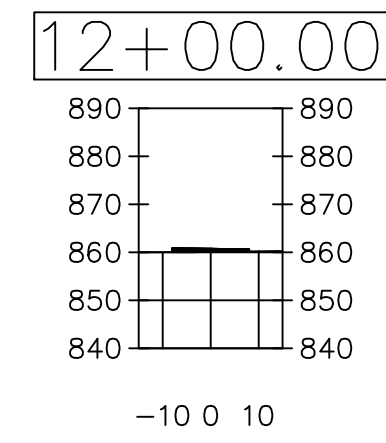
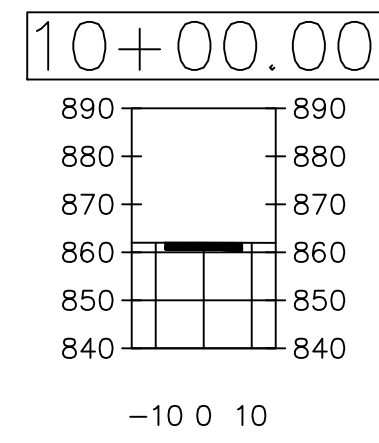

PROJECT: CEE: 4850
 DATE : 05/06/21
 DRAWN BY: MICHELLE NITSCHKE
 REVISION:

THE UNIVERSITY OF IOWA
CIVIL AND ENVIRONMENTAL ENGINEERING
 4105 SEAMANS CENTER FOR THE
 ENGINEERING ARTS AND SCIENCES
 103 S CAPITOL ST
 IOWA CITY, IOWA 52242
 PHONE: 319.335.5647
 FAX: 319.335.5660
 EMAIL: civil-hawks@iowa.edu

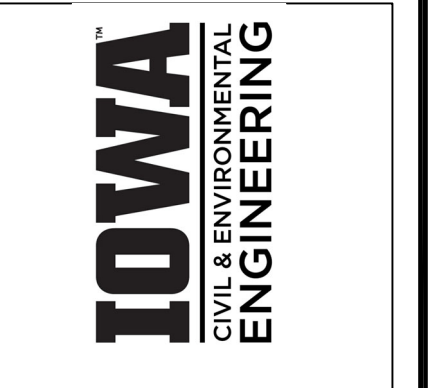

EDUCATIONAL - NOT
 FOR CONSTRUCTION

BRIDGE REPLACEMENT
 CEDAR PRAIRIE TRAIL
 WATERLOO, IA

SHEET NAME
 WESTERN ALT.
 CROSS SECTIONS 2

SHEET NO.
6

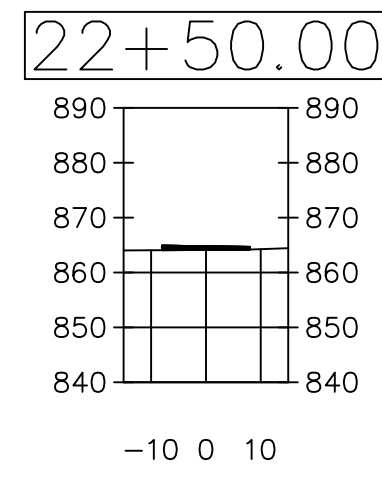
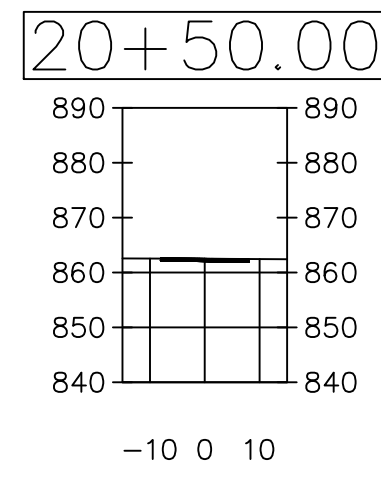
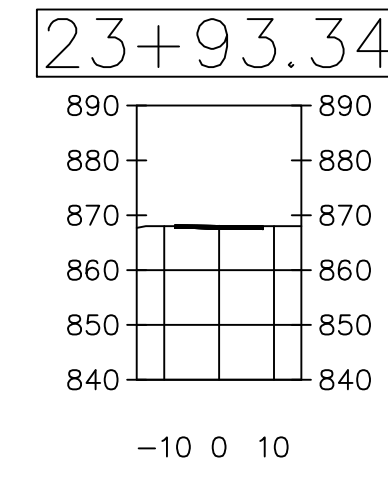
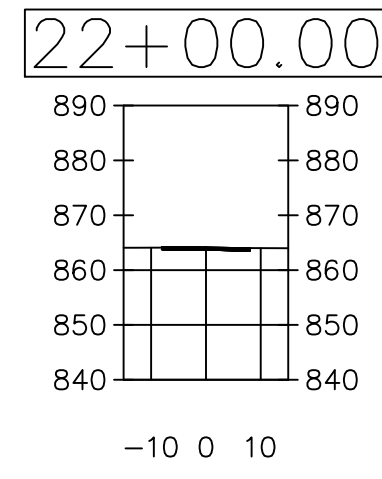
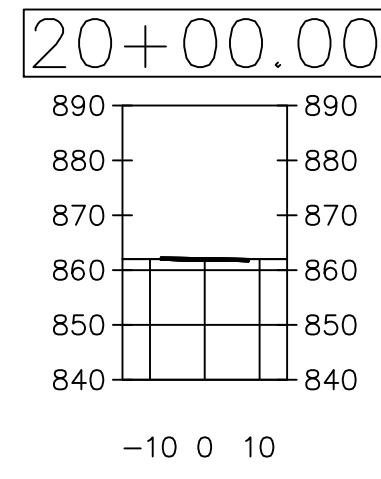
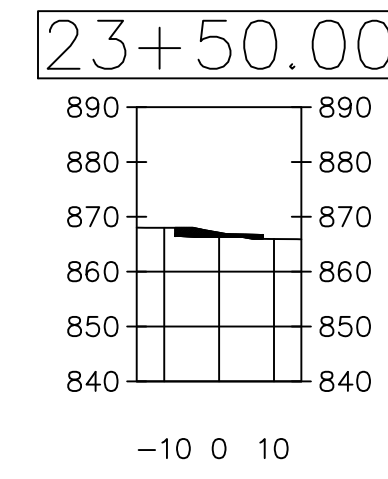
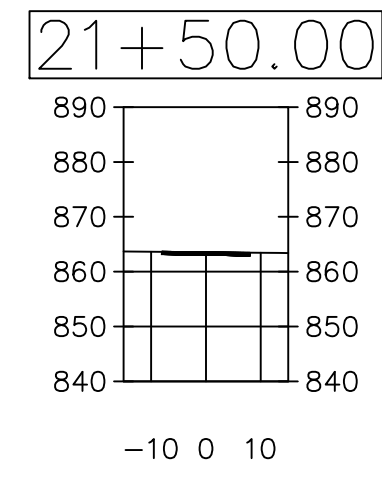
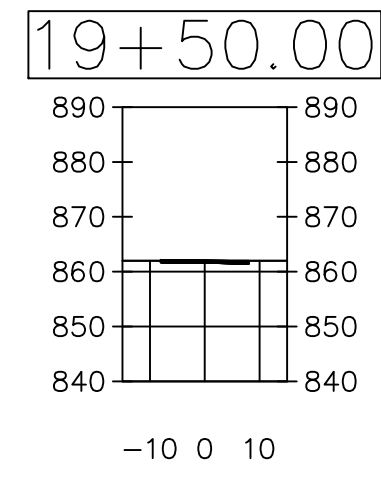
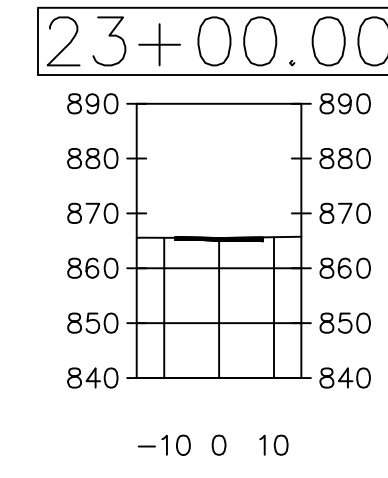
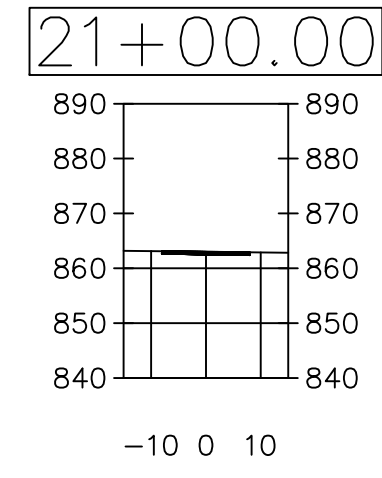
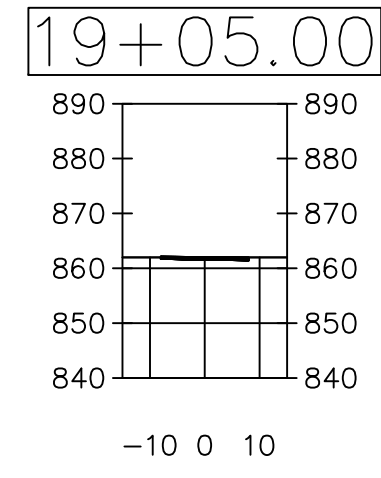

PROJECT: CEE: 4850
 DATE: 05/06/21
 DRAWN BY: MICHELLE NITSCHKE
 REVISION:

THE UNIVERSITY OF IOWA
CIVIL AND ENVIRONMENTAL ENGINEERING
 4105 SEAMANS CENTER FOR THE
 ENGINEERING ARTS AND SCIENCES
 103 S CAPITOL ST
 IOWA CITY, IOWA 52242
 PHONE: 319.335.5647
 FAX: 319.335.5660
 EMAIL: civil-hawks@iowa.edu

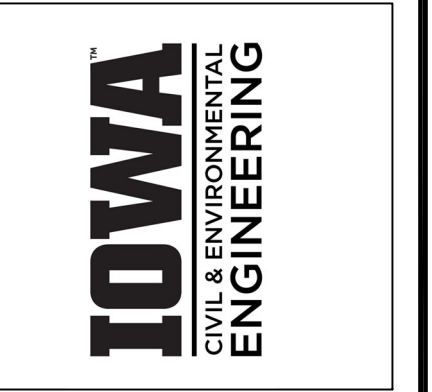

EDUCATIONAL - NOT
 FOR CONSTRUCTION

BRIDGE REPLACEMENT
 CEDAR PRAIRIE TRAIL
 WATERLOO, IA

SHEET NAME
 WESTERN ALT.
 CROSS SECTIONS 3

SHEET NO.
7

Total Volume Table						
Station	Fill Area	Cut Area	Fill Volume	Cut Volume	Cumulative Fill Vol	Cumulative Cut Vol
0+00.00	0.65	0.65	0.00	0.00	0.00	0.00
0+50.00	5.30	0.00	5.51	0.60	5.51	0.60
1+00.00	0.00	10.96	4.91	10.15	10.42	10.75
1+50.00	2.04	0.77	1.89	10.87	12.31	21.62
2+00.00	1.76	0.53	3.52	1.21	15.82	22.82
2+50.00	0.73	1.34	2.31	1.73	18.13	24.55
3+00.00	0.64	0.35	1.28	1.56	19.41	26.11
3+50.00	0.00	3.50	0.58	3.59	19.99	29.70
4+00.00	0.00	6.19	0.00	9.03	19.99	38.73
4+50.00	0.00	8.27	0.00	13.42	19.99	52.16
5+00.00	0.00	9.19	0.00	16.16	19.99	68.32
5+50.00	0.00	9.96	0.00	17.73	19.99	86.05
6+00.00	0.50	1.13	0.47	10.27	20.46	96.32
6+50.00	0.64	1.48	1.06	2.41	21.51	98.73
7+00.00	11.45	0.00	11.19	1.37	32.71	100.10
7+50.00	10.84	0.00	20.64	0.00	53.34	100.10
8+00.00	10.14	0.00	19.42	0.00	72.76	100.10
8+50.00	5.02	0.00	14.03	0.00	86.80	100.10
9+00.00	0.00	2.40	4.64	2.22	91.44	102.33
9+50.00	0.00	9.63	0.00	11.14	91.44	113.46

Total Volume Table						
Station	Fill Area	Cut Area	Fill Volume	Cut Volume	Cumulative Fill Vol	Cumulative Cut Vol
10+00.00	0.00	16.75	0.00	24.42	91.44	137.89
10+50.00	0.00	16.95	0.00	31.21	91.44	169.10
11+00.00	0.00	17.16	0.00	31.59	91.44	200.69
11+50.00	0.00	5.30	0.00	20.80	91.44	221.49
12+00.00	9.90	0.00	9.13	4.95	100.57	226.45
12+50.00	11.18	0.00	19.45	0.00	120.03	226.45
13+00.00	11.84	0.00	21.29	0.00	141.32	226.45
13+50.00	12.22	0.00	22.27	0.00	163.59	226.45
14+00.00	12.79	0.00	23.15	0.00	186.74	226.45
14+50.00	8.86	0.00	20.04	0.00	206.79	226.45
15+00.00	4.33	0.00	12.22	0.00	219.00	226.45
15+50.00	0.80	0.62	4.75	0.57	223.75	227.02
16+00.00	0.00	6.11	0.74	6.23	224.49	233.25
16+50.00	0.00	3.50	0.00	8.89	224.49	242.14
17+00.00	0.00	2.28	0.00	5.35	224.49	247.49
17+50.00	0.10	1.16	0.09	3.20	224.58	250.69
17+75.00	0.00	0.00	0.04	0.55	224.62	251.24

Total Volume Table							
Station	Fill Area	Cut Area	Fill Volume	Cut Volume	Cumulative Fill Vol	Cumulative Cut Vol	
19+05.00	0.55	0.41	0.00	0.00	0.00	0.00	
19+50.00	0.66	0.33	1.02	0.61	1.02	0.61	
20+00.00	2.61	0.00	3.03	0.30	4.05	0.91	
20+50.00	0.21	0.46	2.61	0.43	6.66	1.34	
21+00.00	0.00	0.81	0.19	1.18	6.85	2.52	
21+50.00	0.04	0.44	0.03	1.16	6.88	3.68	
22+00.00	0.89	0.02	0.86	0.42	7.74	4.11	
22+50.00	10.75	0.00	10.78	0.02	18.52	4.12	
23+00.00	0.30	1.02	10.23	0.94	28.75	5.06	
23+50.00	2.90	6.97	2.97	7.40	31.72	12.46	
23+93.34	0.54	0.44	2.76	5.95	34.48	18.41	

PROJECT: CEE: 4850
DATE : 05/06/21
DRAWN BY: MICHELLE NITSCHKE
REVISION:

THE UNIVERSITY OF IOWA
CIVIL AND ENVIRONMENTAL ENGINEERING
4105 SEAMANS CENTER FOR THE
ENGINEERING ARTS AND SCIENCES
103 S CAPITOL ST
IOWA CITY, IOWA 52242
PHONE: 319.335.5647
FAX: 319.335.5660
EMAIL: civil-hawks@iowa.edu

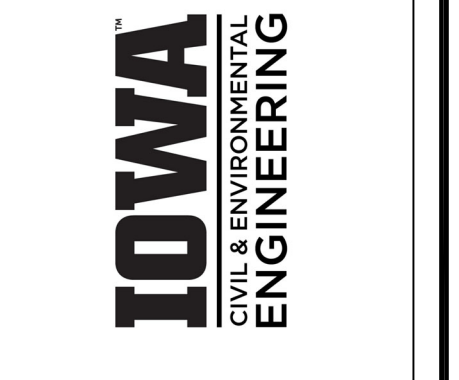

EDUCATIONAL - NOT FOR CONSTRUCTION

BRIDGE REPLACEMENT
CEDAR PRAIRIE TRAIL
WATERLOO, IA

SHEET NAME
WESTERN ALT.
VOLUME TABLE

SHEET NO.
8

Material Table			
Station	Area	Volume	Cumulative Volume
0+00.00	6.67	0.00	0.00
0+50.00	6.67	12.35	12.35
1+00.00	6.67	12.35	24.69
1+50.00	6.67	12.35	37.04
2+00.00	6.67	12.35	49.38
2+50.00	6.67	12.35	61.73
3+00.00	6.67	12.35	74.07
3+50.00	6.67	12.35	86.42
4+00.00	6.67	12.35	98.77
4+50.00	6.67	12.35	111.11
5+00.00	6.67	12.35	123.46
5+50.00	6.67	12.35	135.80
6+00.00	6.67	12.35	148.15
6+50.00	6.67	12.35	160.49
7+00.00	6.67	12.35	172.84
7+50.00	6.67	12.35	185.19
8+00.00	6.67	12.35	197.53
8+50.00	6.67	12.35	209.88
9+00.00	6.67	12.35	222.22
9+50.00	6.67	12.35	234.57

Material Table			
Station	Area	Volume	Cumulative Volume
10+00.00	6.67	12.35	246.91
10+50.00	6.67	12.35	259.26
11+00.00	6.67	12.35	271.60
11+50.00	6.67	12.35	283.95
12+00.00	6.67	12.35	296.30
12+50.00	6.67	12.35	308.64
13+00.00	6.67	12.35	320.99
13+50.00	6.67	12.35	333.33
14+00.00	6.67	12.35	345.68
14+50.00	6.67	12.35	358.02
15+00.00	6.67	12.35	370.37
15+50.00	6.67	12.35	382.72
16+00.00	6.67	12.35	395.06
16+50.00	6.67	12.35	407.41
17+00.00	6.67	12.35	419.75
17+50.00	6.67	12.35	432.10
17+75.00	0.00	3.09	435.19

Material Table			
Station	Area	Volume	Cumulative Volume
19+05.00	6.67	0.00	0.00
19+50.00	6.67	11.11	11.11
20+00.00	6.67	12.35	23.46
20+50.00	6.67	12.35	35.80
21+00.00	6.67	12.35	48.15
21+50.00	6.67	12.35	60.49
22+00.00	6.67	12.35	72.84
22+50.00	6.67	12.35	85.19
23+00.00	6.67	12.35	97.53
23+50.00	6.67	12.35	109.88
23+93.34	6.67	10.70	120.58

PROJECT: CEE: 4850
DATE : 05/06/21
DRAWN BY: MIHCELLE NITSCHKE
REVISION:

THE UNIVERSITY OF IOWA
CIVIL AND ENVIRONMENTAL ENGINEERING
4105 SEAMANS CENTER FOR THE
ENGINEERING ARTS AND SCIENCES
103 S CAPITOL ST
IOWA CITY, IOWA 52242
PHONE: 319.335.5647
FAX: 319.335.5660
EMAIL: civil-hawks@iowa.edu

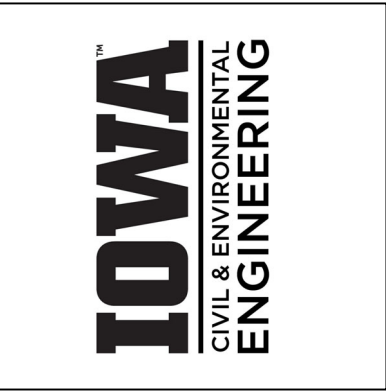

EDUCATIONAL - NOT
FOR CONSTRUCTION

BRIDGE REPLACEMENT
CEDAR PRAIRIE TRAIL
WATERLOO, IA

SHEET NAME
WESTERN ALT.
MATERIAL TABLE

SHEET NO.
9

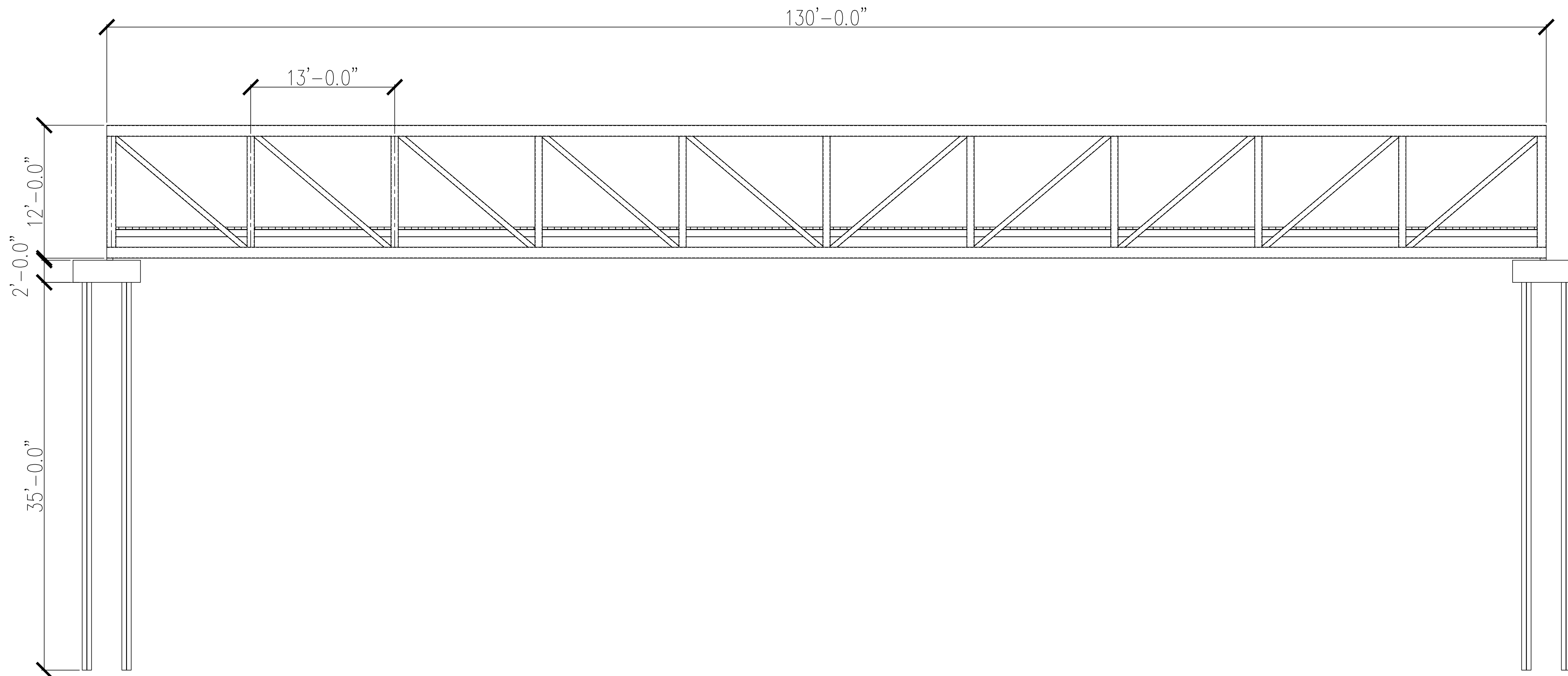

SCALE 3/16"=1'

PROJECT:	CEE: 4860
DATE :	05/14/2021
DRAWN BY:	CMF
REVISION:	

THE UNIVERSITY OF IOWA
CIVIL AND ENVIRONMENTAL ENGINEERING
 4105 SEAMANS CENTER FOR THE
 ENGINEERING ARTS AND SCIENCES
 103 S CAPITOL ST
 IOWA CITY, IOWA 52242
 PHONE: 319.335.5647
 FAX: 319.335.5660
 EMAIL: civil-hawks@iowa.edu



EDUCATIONAL - NOT
FOR CONSTRUCTION

BRIDGE REPLACEMENT
 CEDAR PRAIRIE TRAIL
 WATERLOO, IA

SHEET NAME
 WESTERN ALT.
 BRIDGE

SHEET NO.
10

TRUSS DETAILS

TRUSS IS SYMMETRIC ABOUT CENTERLINE

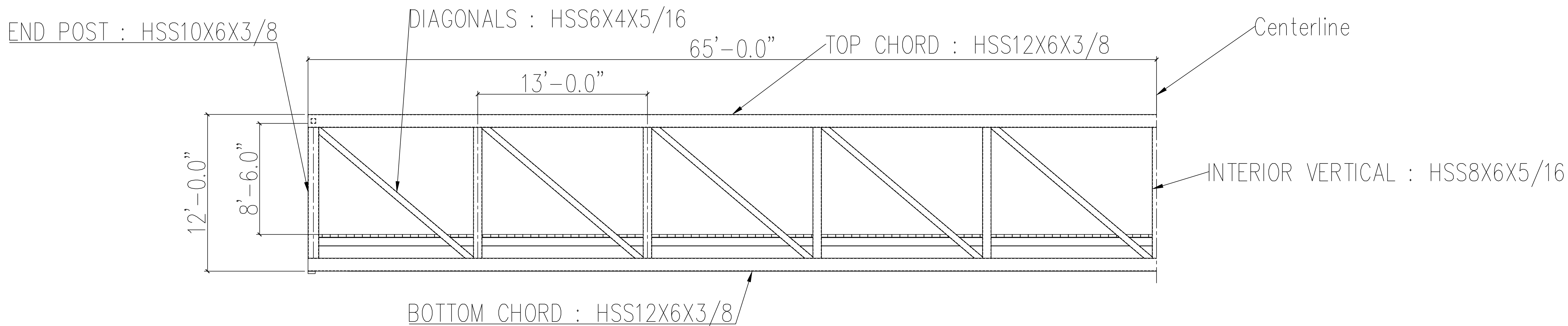

Scale 1/4" = 1'

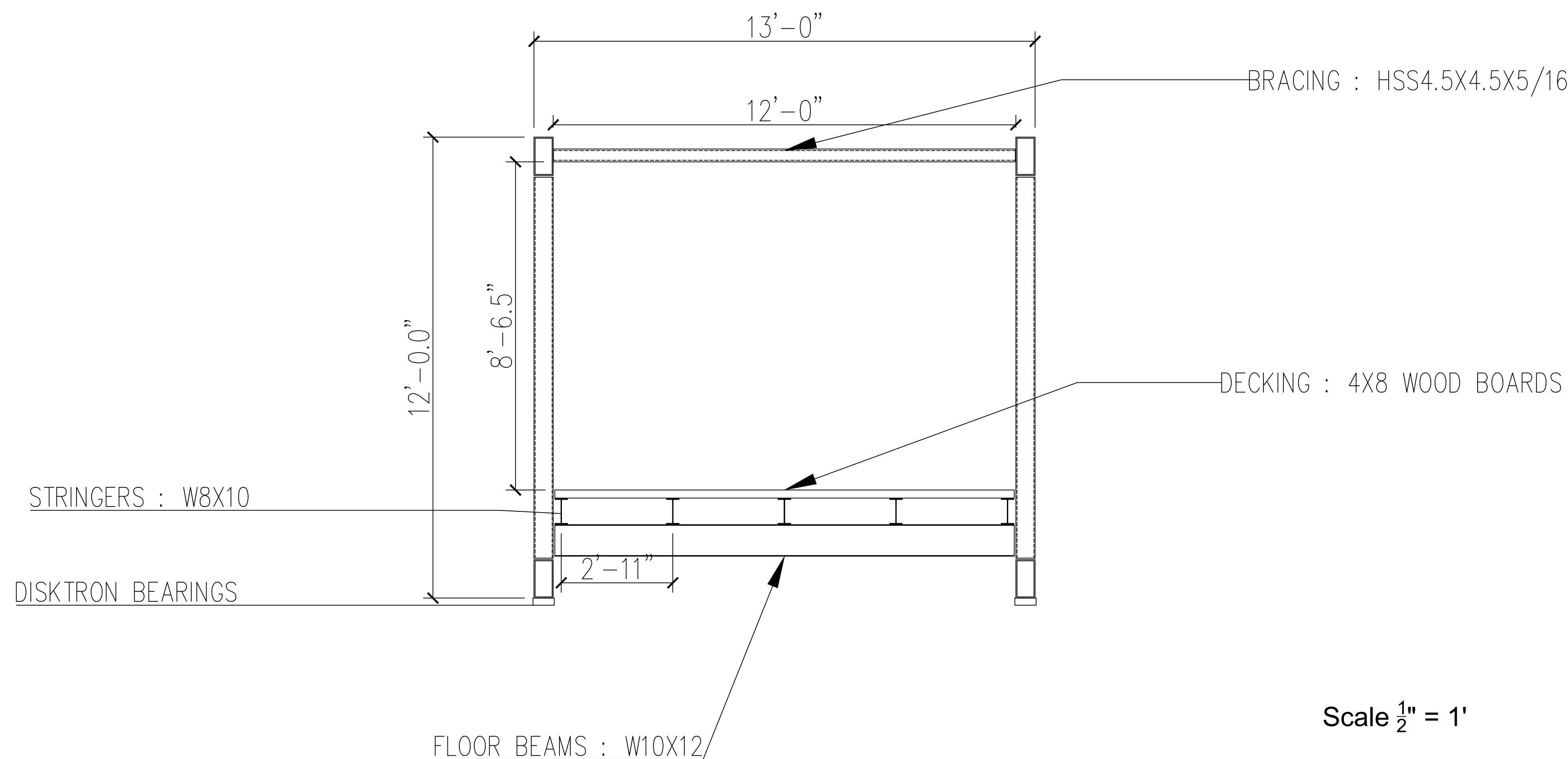

Scale 1/2" = 1'

PROJECT:	CEE: 4850
DATE :	05/14/2021
DRAWN BY:	CMF
REVISION:	

THE UNIVERSITY OF IOWA
CIVIL AND ENVIRONMENTAL ENGINEERING
 4105 SEAMANS CENTER FOR THE
 ENGINEERING ARTS AND SCIENCES
 103 S CAPITOL ST
 IOWA CITY, IOWA 52242
 PHONE: 319.335.5647
 FAX: 319.335.5660
 EMAIL: civil-hawks@iowaeu.edu



EDUCATIONAL - NOT FOR CONSTRUCTION

BRIDGE REPLACEMENT
 CEDAR PRAIRIE TRAIL
 WATERLOO, IA

SHEET NAME
 WESTERN ALT.
 BRIDGE DETAIL

SHEET NO.
11

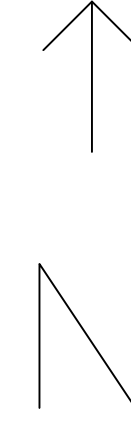
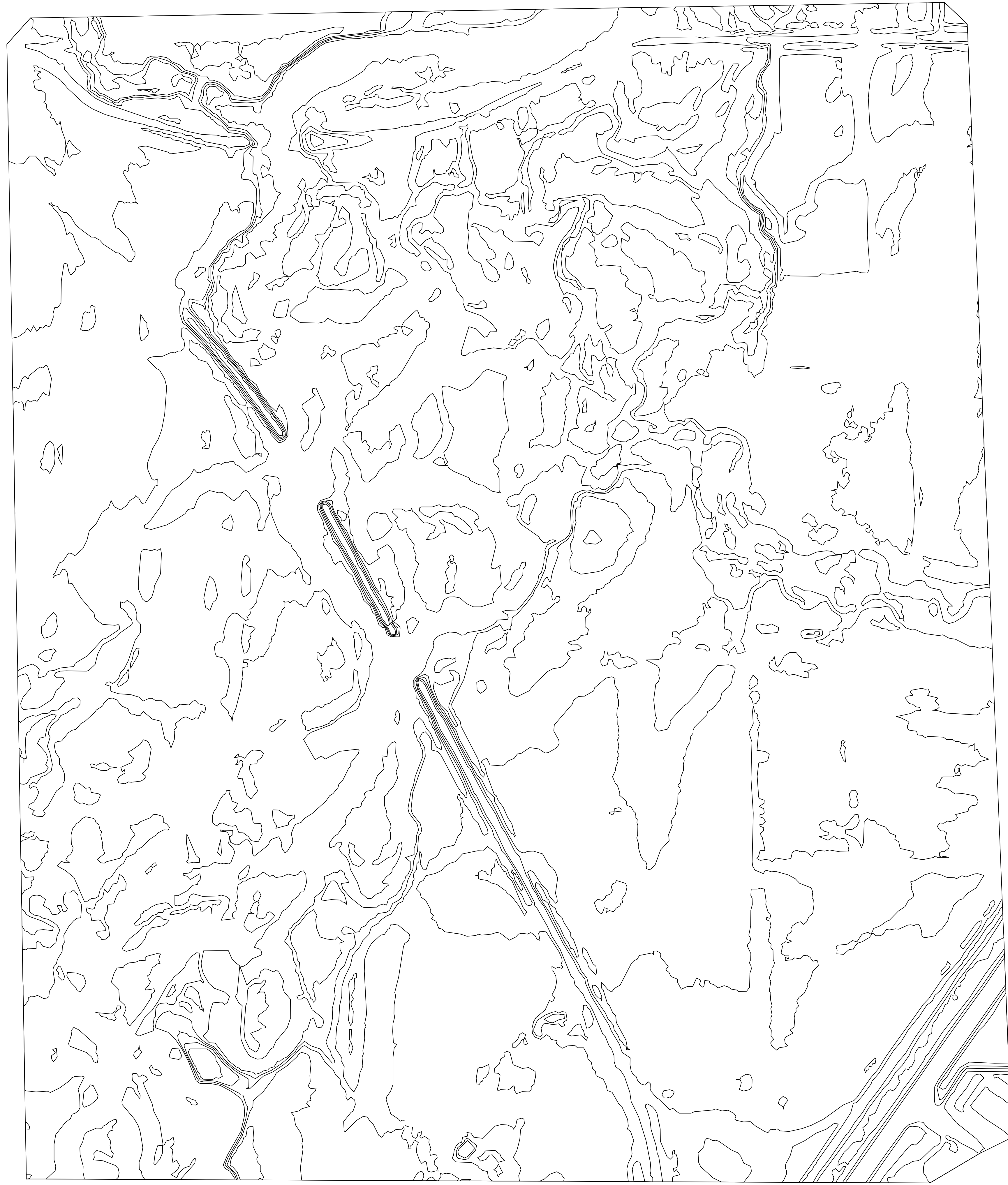

SHEET NAME
EMBANKM
CURRENT

SHEET NO.
13

BRIDGE REPLACEMENT

EDUCATIONAL
FOR CONSTRU



CIVIL AND ENVIRONMENTAL ENGINEERING
4105 SEAMANS CENTER FOR THE
ENGINEERING ARTS AND SCIENCES
103 S CAPITOL ST
IOWA CITY, IOWA 52242
PHONE: 319.335.5647
FAX: 319.335.5660
EMAIL: civil-hawks@iowae.edu

PROJECT: CEE-485C
DATE : 05/14/2021
DRAWN BY: LUCY DENT
REVISION:

This document was created by an application that isn't licensed to use [novaPDF](#).
Purchase a license to generate PDF files without this notice.

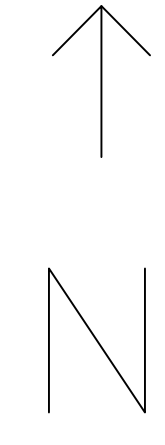
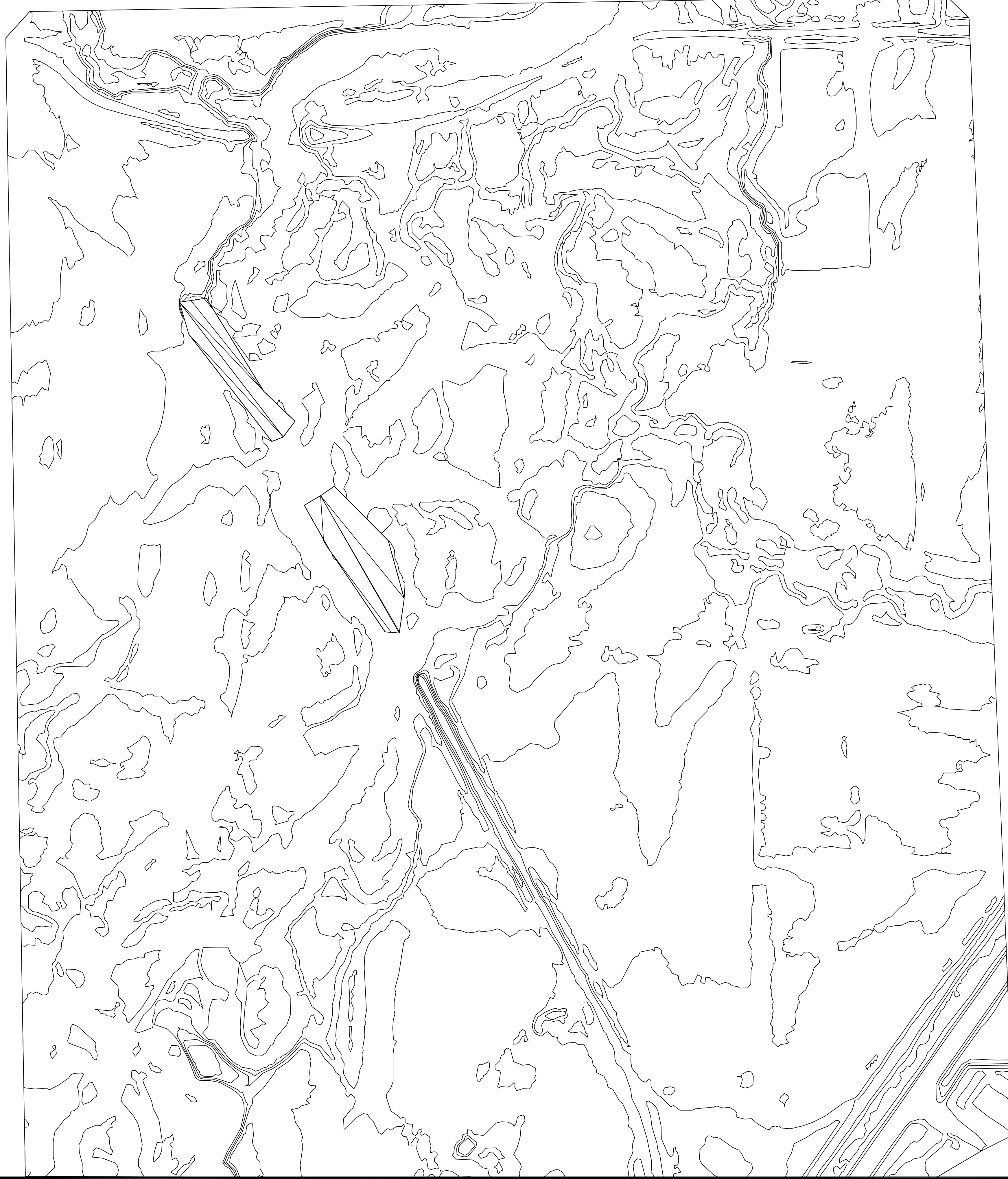

SHEET NAME
EMBANKE
NEW ELEV

SHEET NO.
14

BRIDGE REPLACEMENT

EDUCATIONAL
FOR CONSTRU

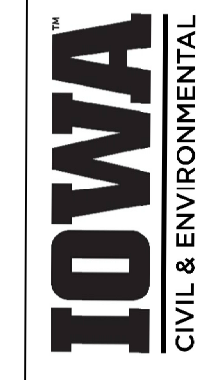

THE UNIVERSITY OF IOWA
CIVIL AND ENVIRONMENTAL ENGINEERING
4105 SEAMANS CENTER FOR THE
ENGINEERING ARTS AND SCIENCES
103 S CAPITOL S
IOWA CITY, IOWA 52242
PHONE: 319.335.5647
FAX: 319.335.5660
EMAIL: civil-hawks@iowa.edu

PROJECT: CEE-485C
DATE : 05/14/2021
DRAWN BY: LUCY DENT
REVISION:

This document was created by an application that isn't licensed to use [novaPDF](#).
Purchase a license to generate PDF files without this notice.