

SAZA CONSULTING

CONSTRUCTION BID PLANS OF PROPOSED
DOWNTOWN TO RIVERFRONT PROJECT

RIVERVIEW PARK
KEOKUK, IA 52632
RFP # 02-spring2020



SHEET NO.

INDEX OF SHEETS

1	TITLE PAGE
2	SITE PLAN
3	PARKING LOT
4-5	UNION DEPOT TRAIL PLAN AND PROFILE
6-8	UNION DEPOT TRAIL SECTIONS SHEETS
9-10	HIGHWAY TRAIL PLAN AND PROFILE
11	HIGHWAY TRAIL SECTION SHEETS
12	GATEWAY TO RIVERVIEW TRAIL PLAN AND PROFILE
13	GATEWAY TO RIVERVIEW TRAIL SECTION SHEETS
14-16	RIVERVIEW PARK TRAIL PLAN AND PROFILE
17-19	RIVERVIEW PARK TRAIL SECTION SHEETS
20	GAZEBO STRUCTURAL PLAN
21-24	PARK STRUCTURE FLOOR PLAN
25	PARK STRUCTURE ELEVATIONS

SHEET NAME
TITLE PAGE

DOWNTOWN TO RIVERFRONT

RIVERVIEW PARK
KEOKUK, IA 52632

PROVISIONAL - NOT
FOR CONSTRUCTION

CEE logo BW - noText.tif

THE UNIVERSITY OF IOWA CIVIL AND ENVIRONMENTAL ENGINEERING

4105 SEAMANS CENTER FOR THE
ENGINEERING ARTS AND SCIENCES
103 S CAPITOL ST
IOWA CITY, IOWA 52242
PHONE: 319.335.5647
FAX: 319.335.5660
EMAIL: civil-hawks@uiowa.edu





PROJECT: CEE: 4850
DATE : 5/08/20
DRAWN BY: Stephanie Krogh
REVISION:

SHEET NO.

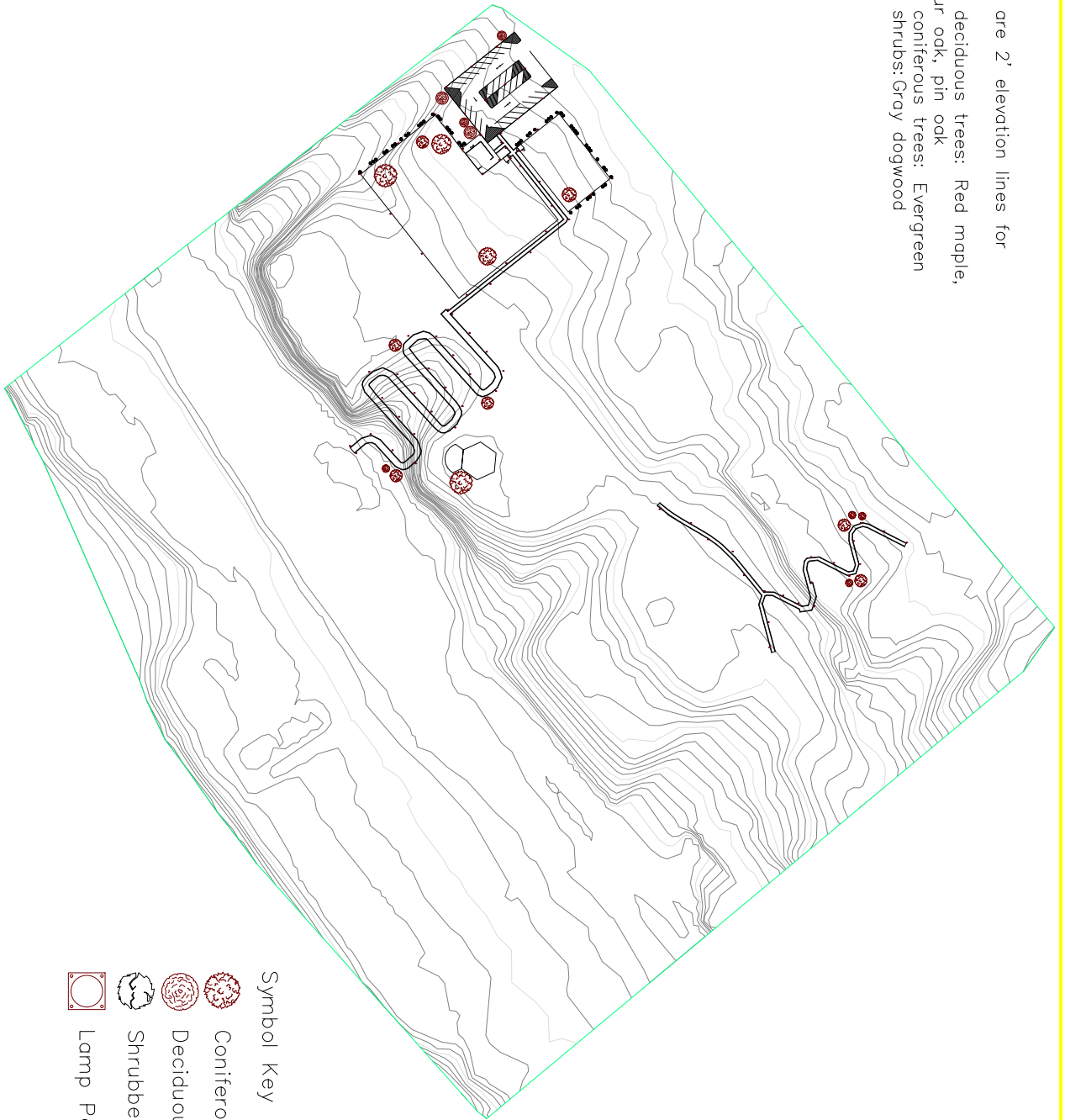
01

- NOTES
- *Elevation lines are 2' elevation lines for existing site.
 - *Recommended deciduous trees: Red maple, silver maple, bur oak, pin oak
 - *Recommended coniferous trees: Evergreen
 - *Recommended shrubs: Gray dogwood



- Symbol Key
-  Coniferous Tree
 -  Deciduous Tree
 -  Shrubbery
 -  Lamp Post

PROJECT:	CEE:4850
DATE :	5/08/20
DRAWN BY:	Stephanie Krogh
REVISION:	

THE UNIVERSITY OF IOWA
CIVIL AND ENVIRONMENTAL ENGINEERING
 4105 SEAMANS CENTER FOR THE
 ENGINEERING ARTS AND SCIENCES
 103 S CAPITOL ST
 IOWA CITY, IOWA 52242
 PHONE: 319.335.5647
 FAX: 319.335.5660
 EMAIL: civil-hawks@iowa.edu

DOWNTOWN TO RIVERFRONT
 RIVERVIEW PARK
 KEOKUK, IA 52632

SHEET NAME: SITE PLAN
 SHEET NO. 02

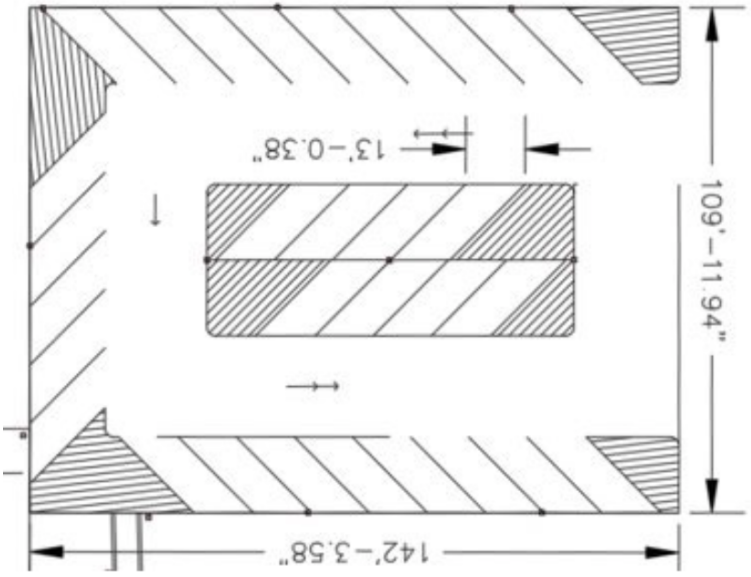
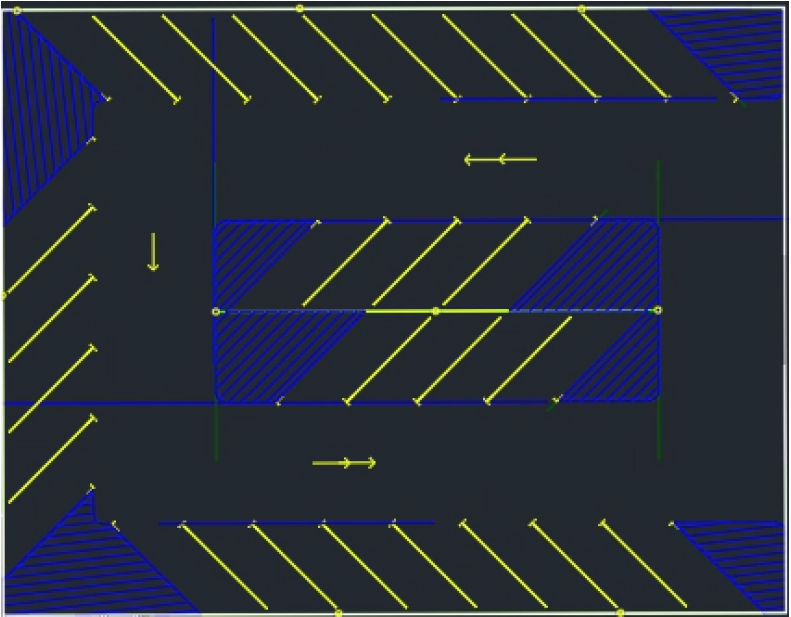

- DIAGONAL PARKING LOT SPACE
DIMENSION 12'x 24'
- ONE-WAY TRAFFIC FLOW
- ASSUME FAIR SUBGRADE CONDITION
- 8" AGGREGATE BASE
- 2" HOT MIX ASPHALT SURFACE

DOWNTOWN TO RIVERFRONT

RIVERVIEW PARK
KEOKUK, IA 52632

CAUTION, NOT FOR CONSTRUCTION

CDE logo 04 - noRed.HH

**THE UNIVERSITY OF IOWA
CIVIL AND ENVIRONMENTAL ENGINEERING**

4105 SEAMANS CENTER FOR THE
ENGINEERING ARTS AND SCIENCES
103 S CAPITOL ST
IOWA CITY, IOWA 52242
PHONE: 319.335.5647
FAX: 319.335.5660
EMAIL: civil-hawks@uiowa.edu

PROJECT:	CEE: 4850
DATE :	05/08/2020
DRAWN BY:	AEW
REVISION:	

SHEET NAME
PARKING LOT
PLAN
SHEET NO.

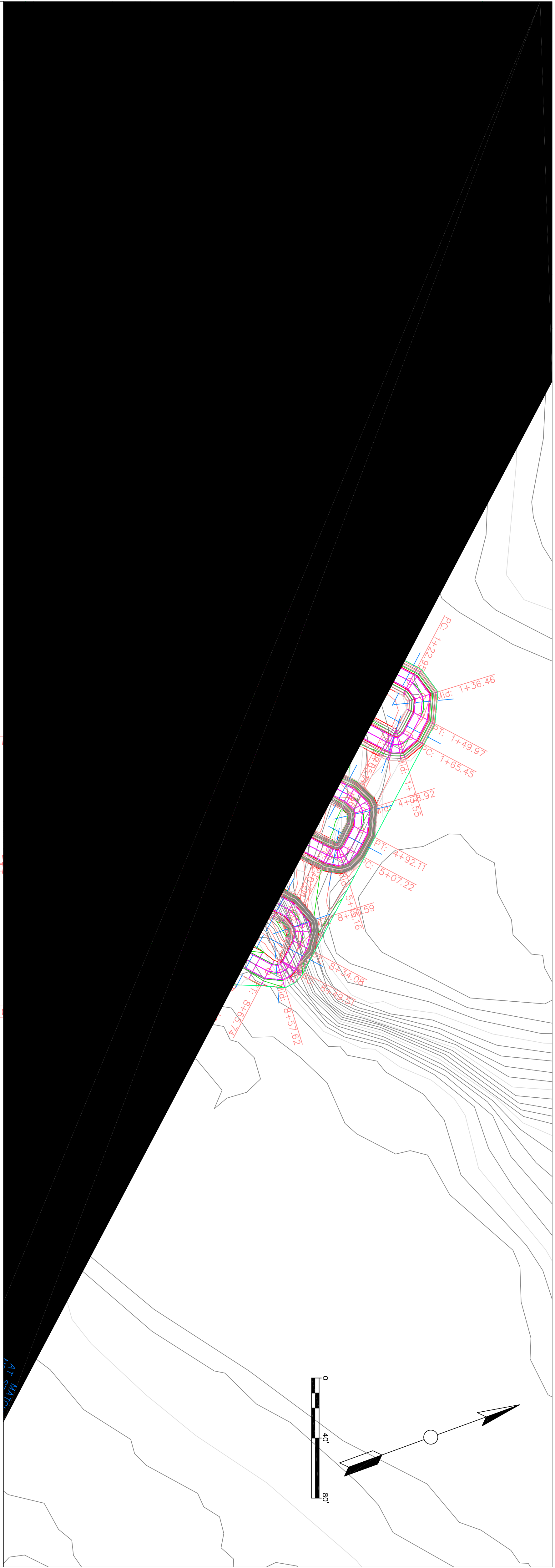

UD Trail Alt Horizontal Alignment Actual PROFILE

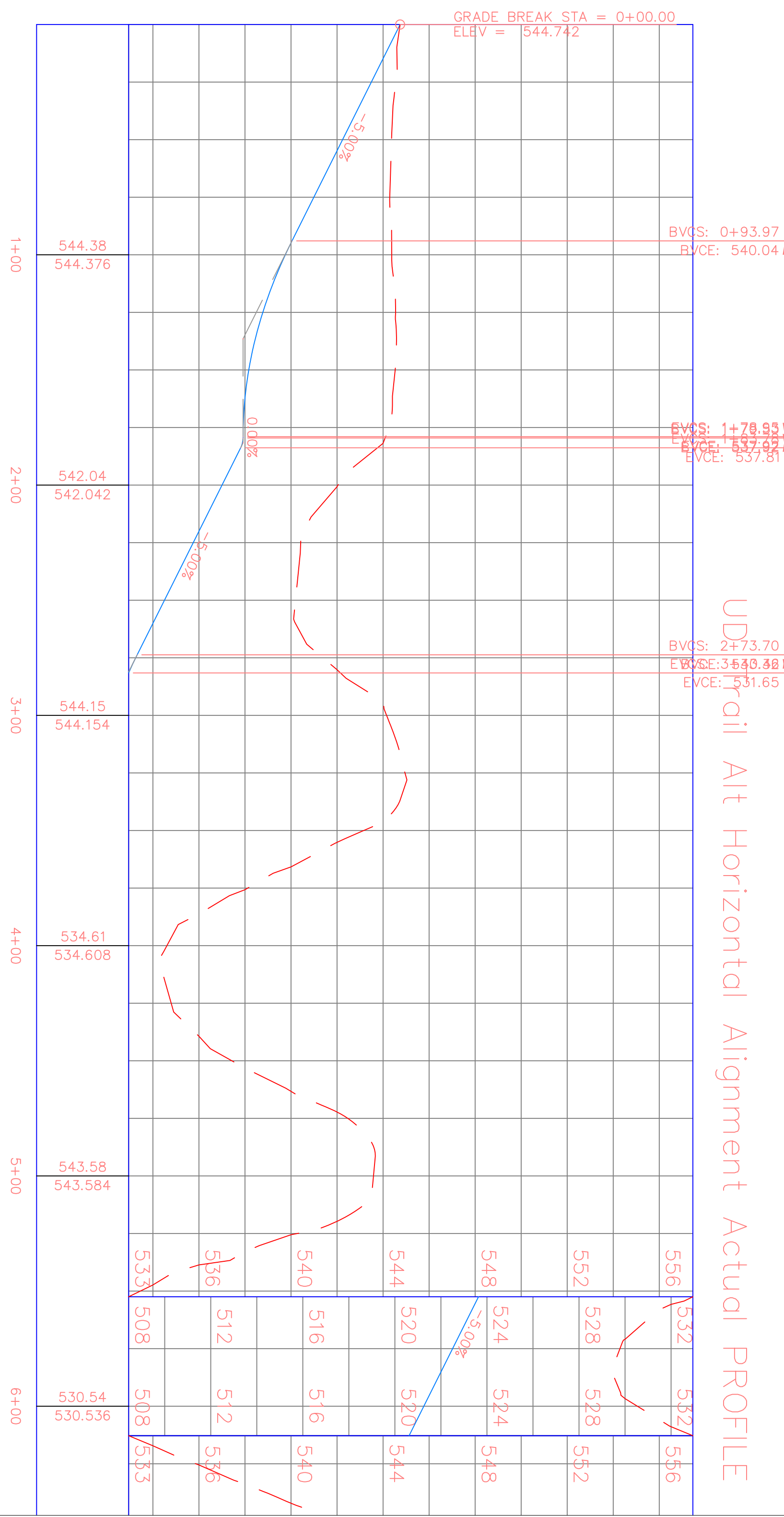

DOWNTOWN TO RIVERFRONT

RIVERVIEW PARK
KEOKUK, IA 52632

OPTIONAL - NOT
FOR CONSTRUCTION

CEE logo BW -- noText.tif

THE UNIVERSITY OF IOWA CIVIL AND ENVIRONMENTAL ENGINEERING

4105 SEAMANS CENTER FOR THE
ENGINEERING ARTS AND SCIENCES
103 S CAPITOL ST
IOWA CITY, IOWA 52242
PHONE: 319.335.5647
FAX: 319.335.5660
EMAIL: civil-hawks@uiowa.edu

PROJECT:	CEE: 4850
DATE :	5/08/20
DRAWN BY:	Stephanie Krogh
REVISION:	

SHEET NAME
DEPOT TRAIL
PLAN AND PROFILE 1

SHEET NO.

04

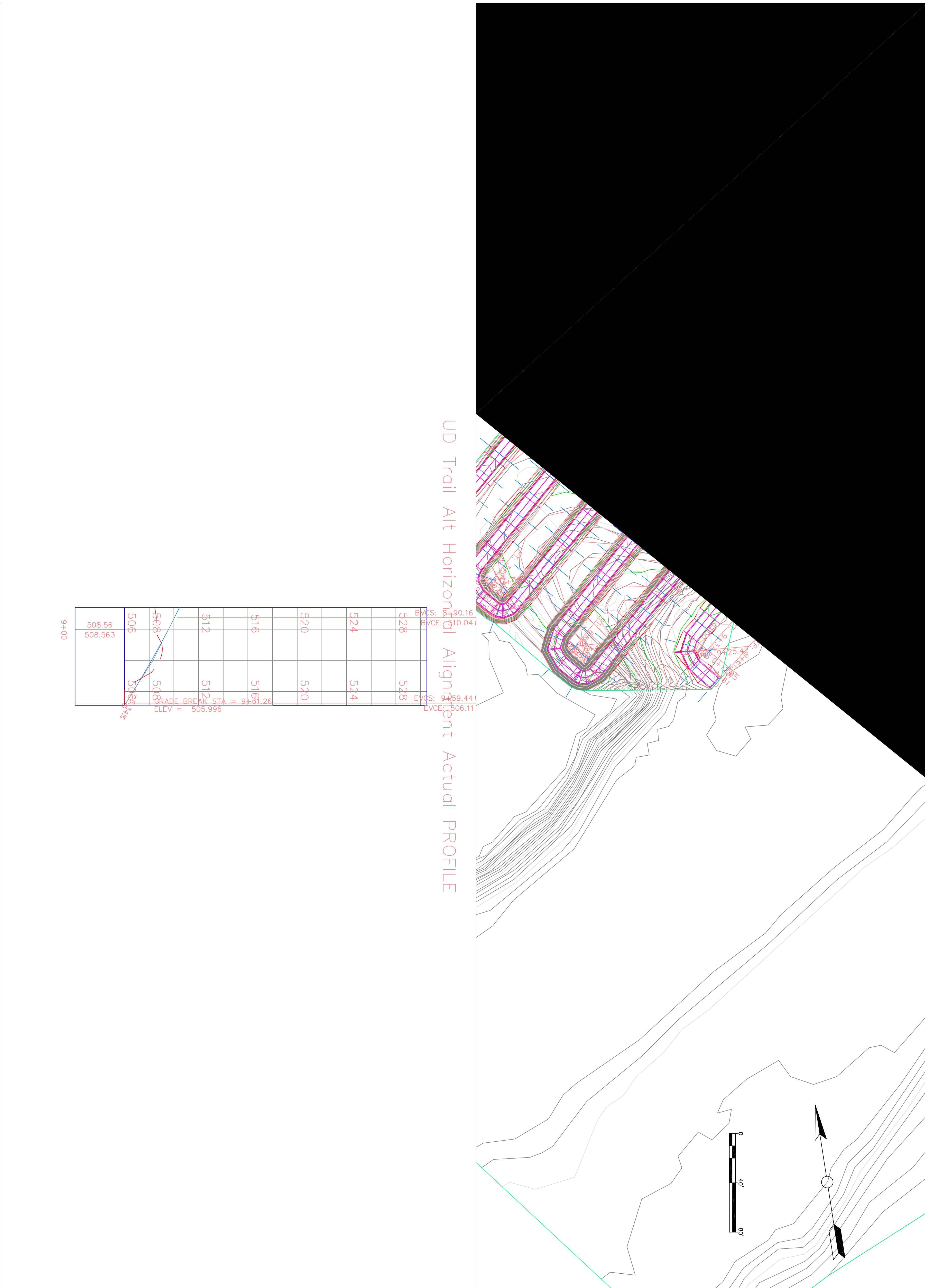

9+00	508.56	508	512	516	520	524	528	BVCS: 10.04	BVCE: 509.16
	508.563	508	512	516	520	524	528	EVCS: 509.44	EVCE: 506.11
		GRADE BREAK STA = 9+61.26						ELEV = 505.996	

DOWNTOWN TO RIVERFRONT

RIVERVIEW PARK
KEOKUK, IA 52632

OPTIONAL - NOT CONSTRUCTION

CEE logo BW - noText.tif

THE UNIVERSITY OF IOWA
CIVIL AND ENVIRONMENTAL ENGINEERING
 4105 SEAMANS CENTER FOR THE
 ENGINEERING ARTS AND SCIENCES
 103 S CAPITOL ST
 IOWA CITY, IOWA 52242
 PHONE: 319.335.5647
 FAX: 319.335.5660
 EMAIL: civil-hawks@iowa.edu

PROJECT:	CEE: 4850
DATE :	5/08/20
DRAWN BY:	Stephanie Krogh
REVISION:	

SHEET NAME

DEPOT TRAIL
PLAN AND PROFILE 2

SHEET NO.
2

05

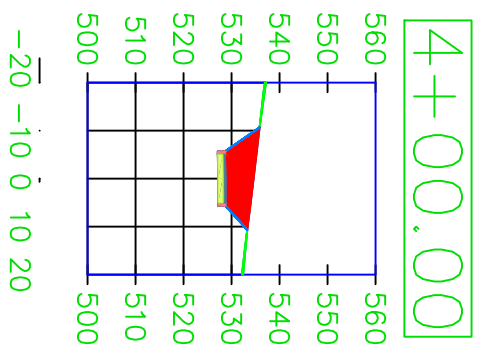
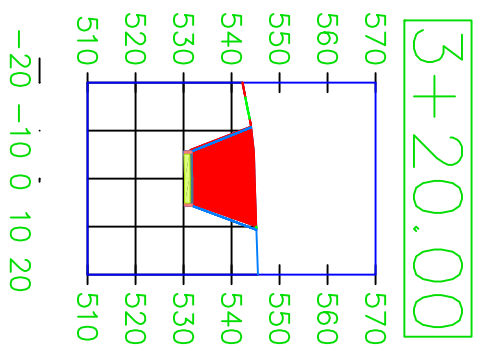
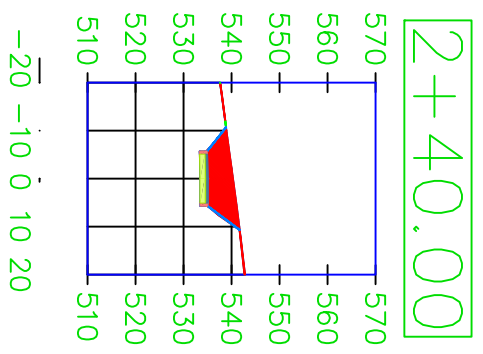
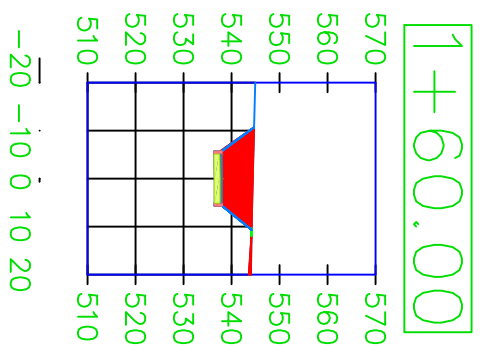
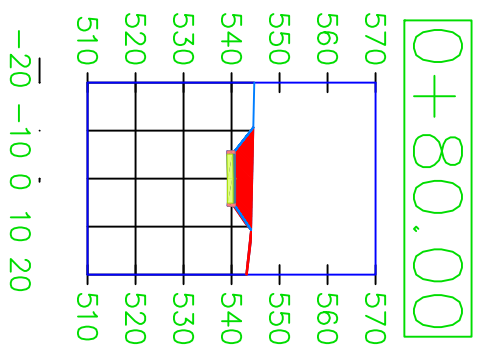
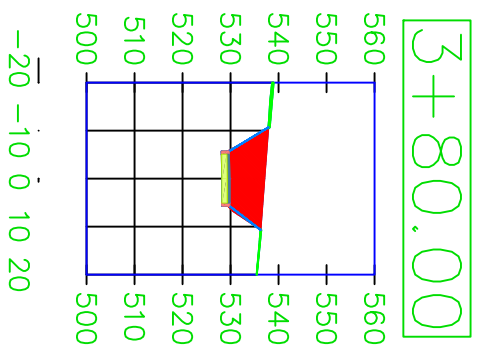
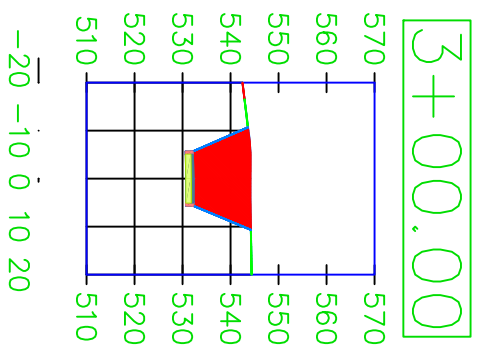
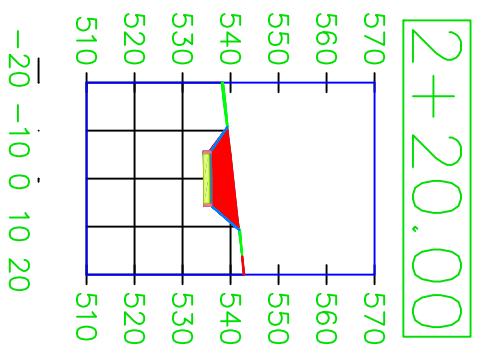
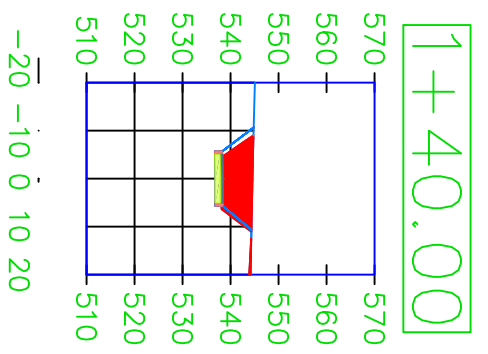
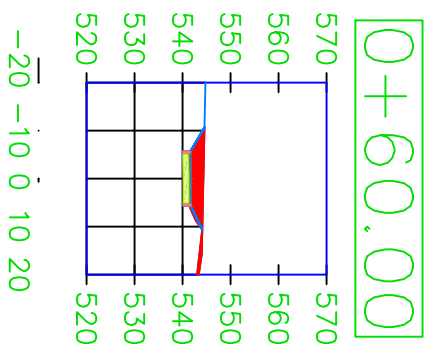
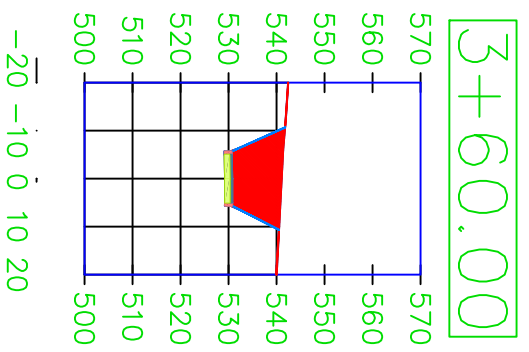
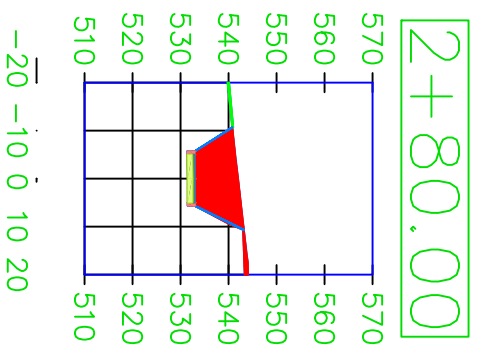
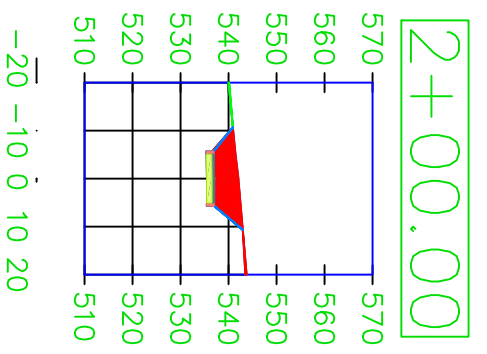
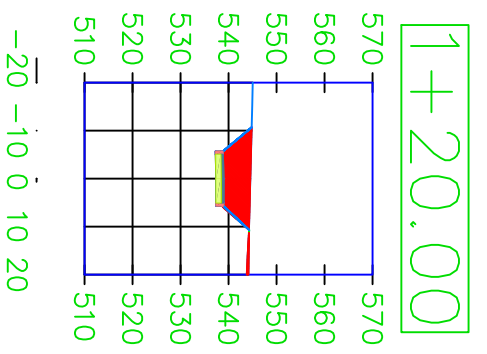
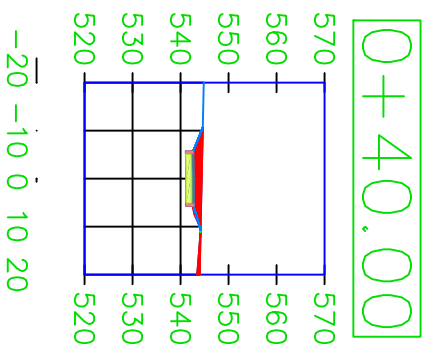
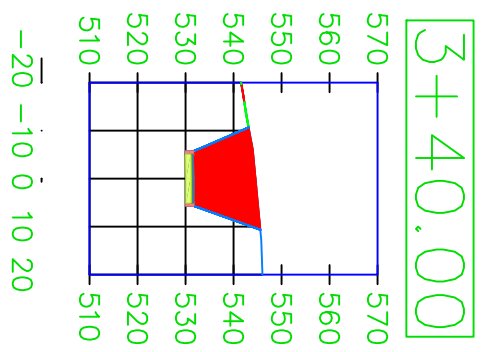
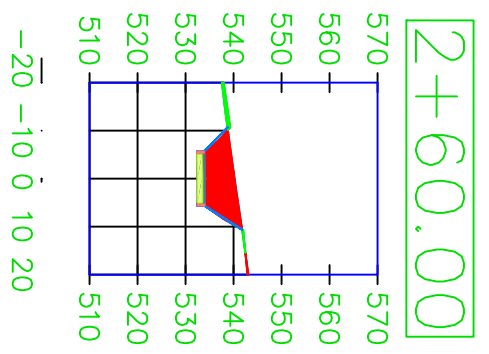
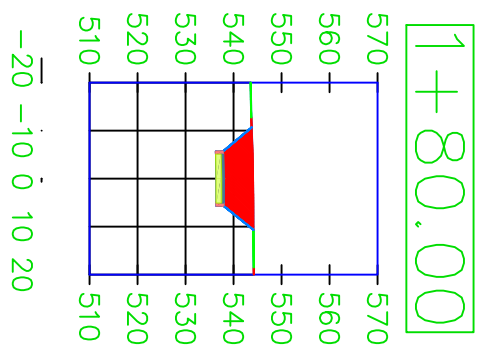
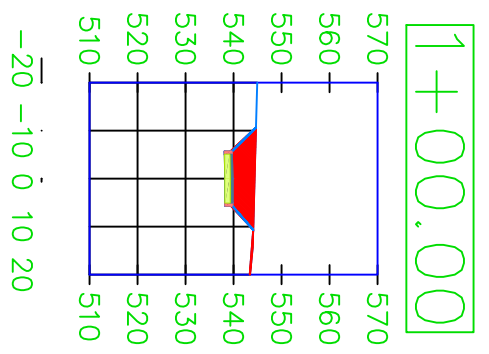
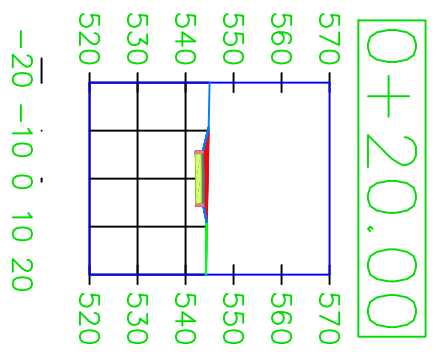

PROJECT: CEE: 4850
 DATE : 5/08/20
 DRAWN BY: Stephanie Krogh
 REVISION:

**THE UNIVERSITY OF IOWA
 CIVIL AND ENVIRONMENTAL ENGINEERING**

4105 SEAMANS CENTER FOR THE
 ENGINEERING ARTS AND SCIENCES
 103 S CAPITOL ST
 IOWA CITY, IOWA 52242
 PHONE: 319.335.5647
 FAX: 319.335.5660
 EMAIL: civil-hawks@uiowa.edu

CEE logo BW -- noText.tif

OPTIONAL - NOT
 CONSTRUCTION

DOWNTOWN TO RIVERFRONT

RIVERVIEW PARK
 KEOKUK, IA 52632

SHEET NAME

DEPOT TRAIL
 SECTION SHEET 1

SHEET NO.

06

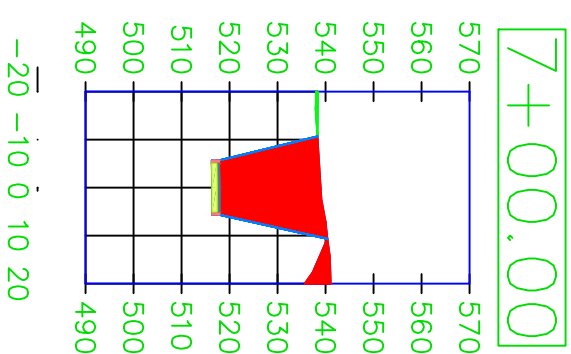
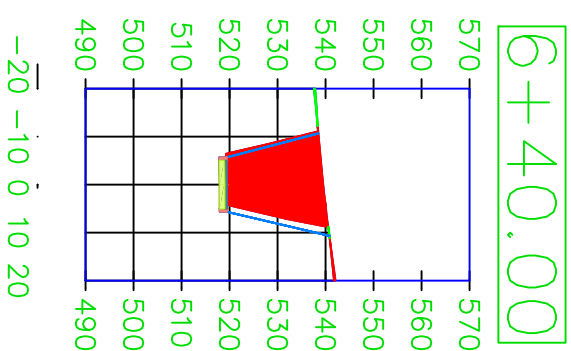
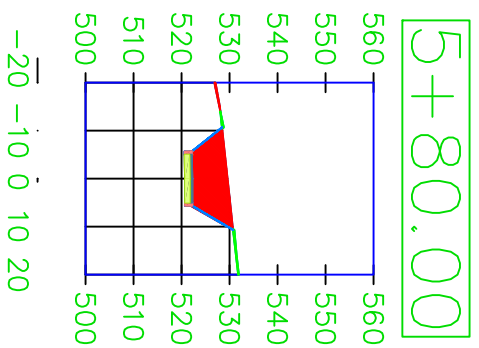
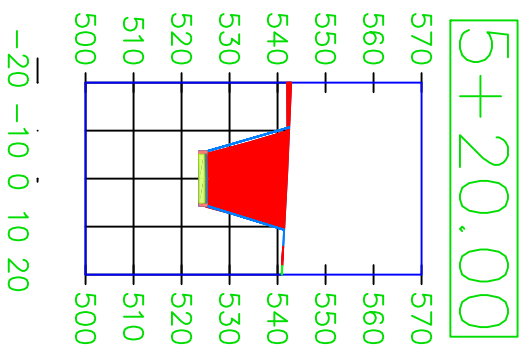
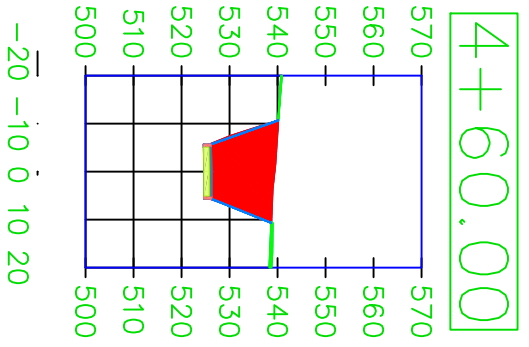
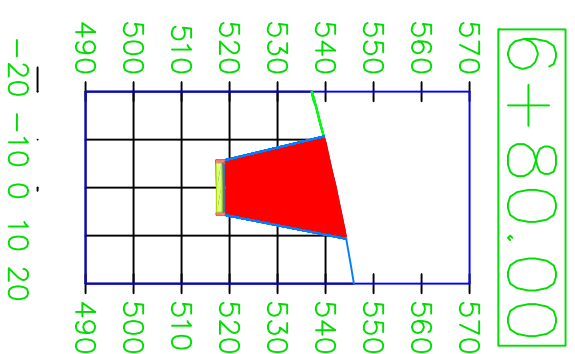
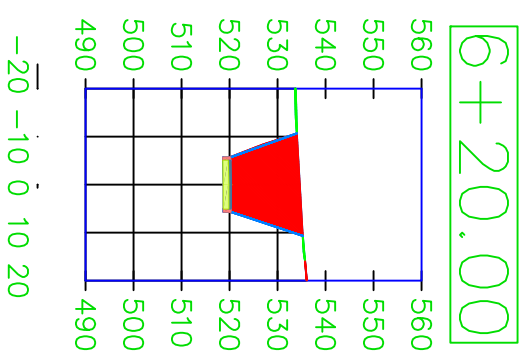
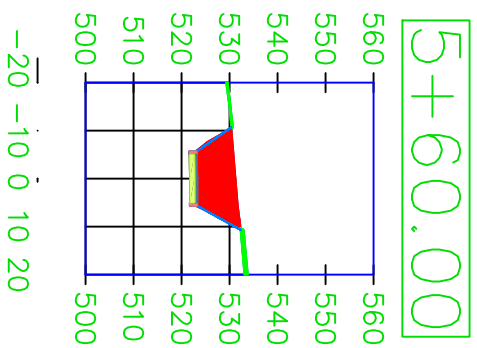
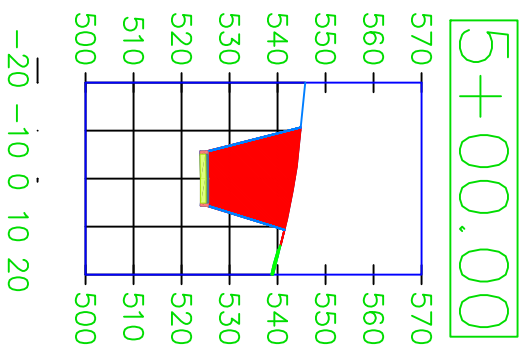
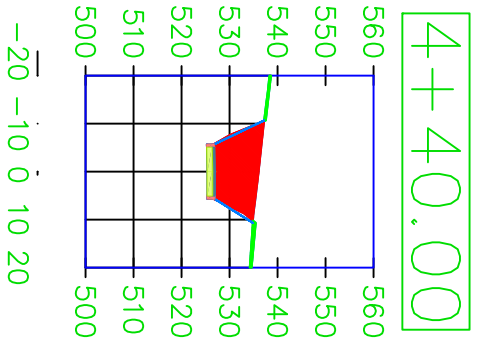
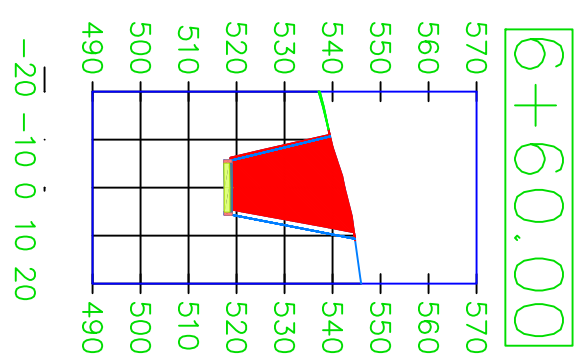
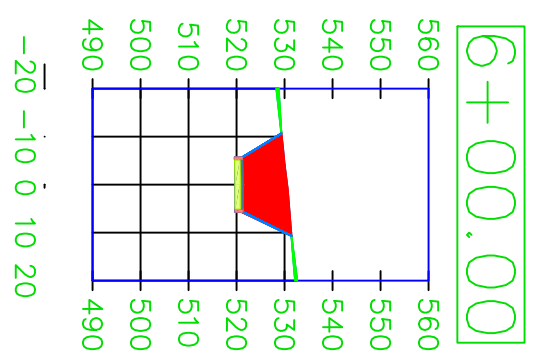
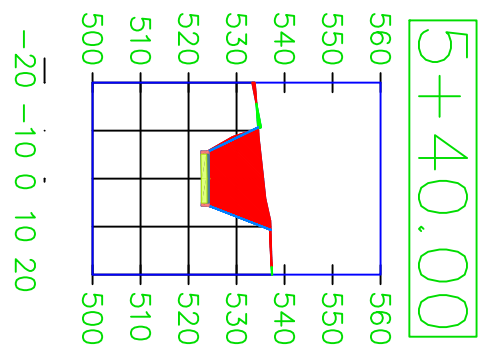
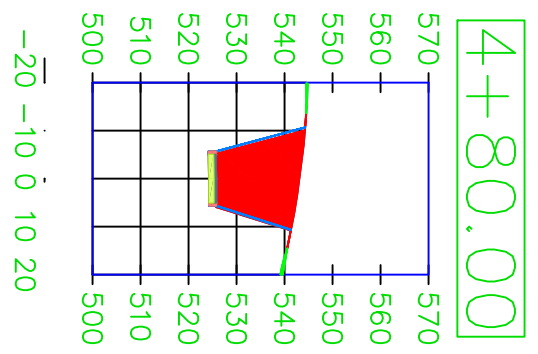
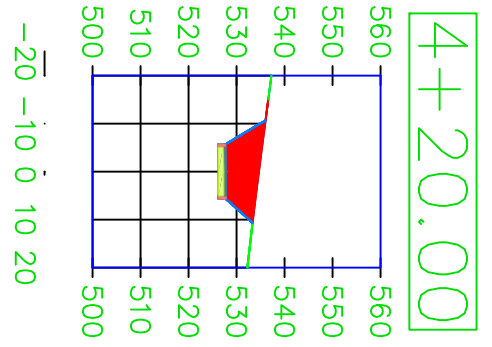

PROJECT: CEE: 4850
 DATE : 5/08/20
 DRAWN BY: Stephanie Krogh
 REVISION:

**THE UNIVERSITY OF IOWA
 CIVIL AND ENVIRONMENTAL ENGINEERING**

4105 SEAMANS CENTER FOR THE
 ENGINEERING ARTS AND SCIENCES
 103 S CAPITOL ST
 IOWA CITY, IOWA 52242
 PHONE: 319.335.5647
 FAX: 319.335.5660
 EMAIL: civil-hawks@uiowa.edu

CEE logo BW -- noText.tif

OPTIONAL - NOT
 CONSTRUCTION

DOWNTOWN TO RIVERFRONT

RIVERVIEW PARK
 KEOKUK, IA 52632

SHEET NAME

DEPOT TRAIL
 SECTION SHEET 2

SHEET NO.

07

2

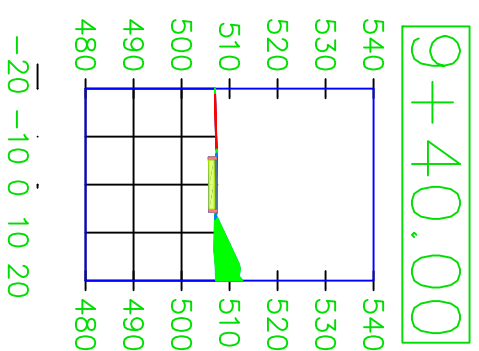
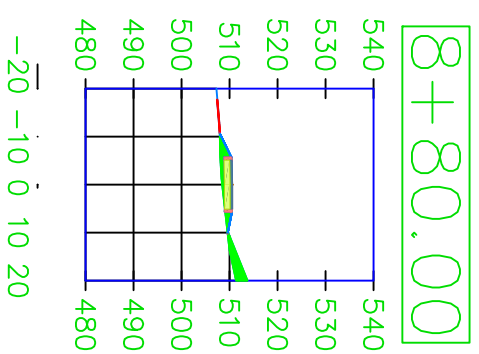
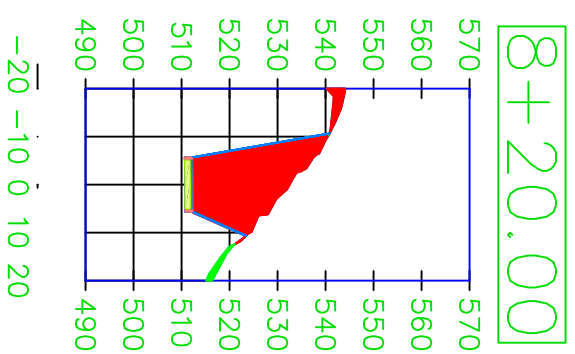
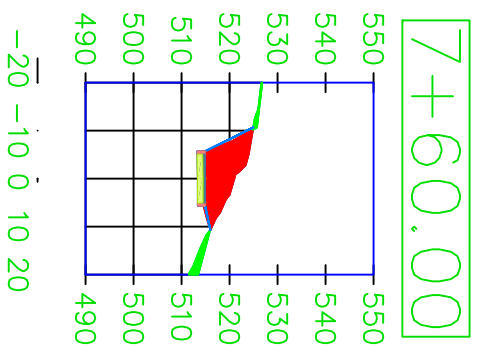
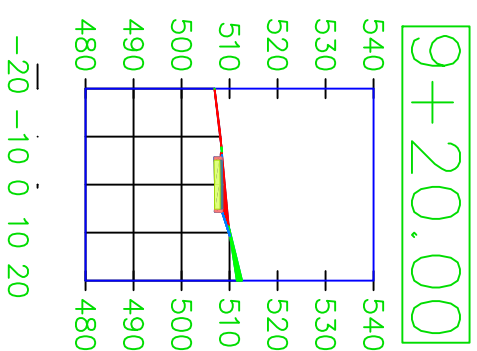
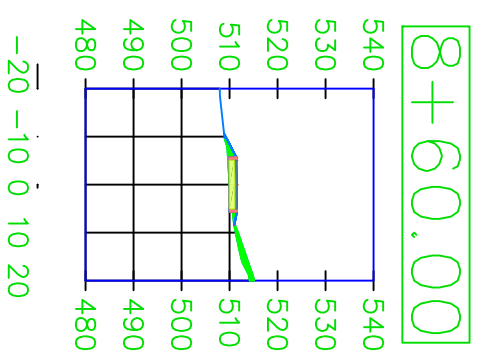
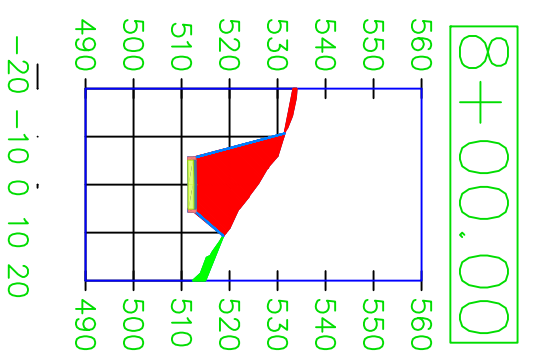
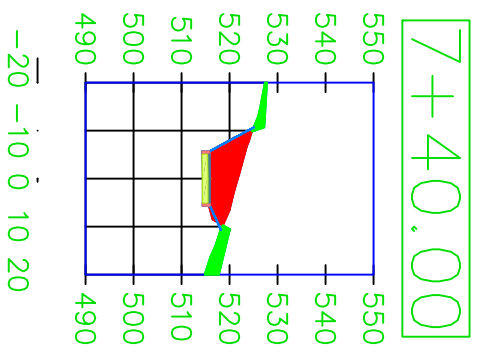
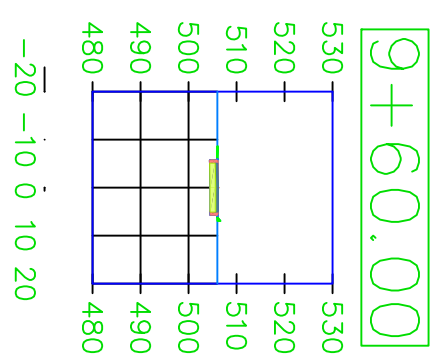
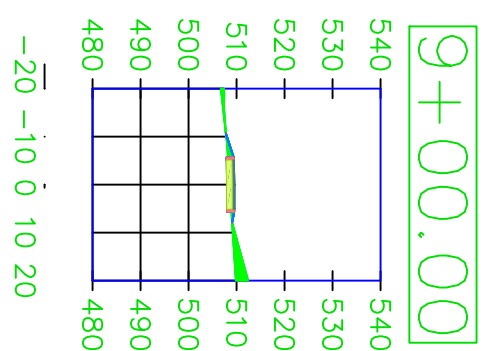
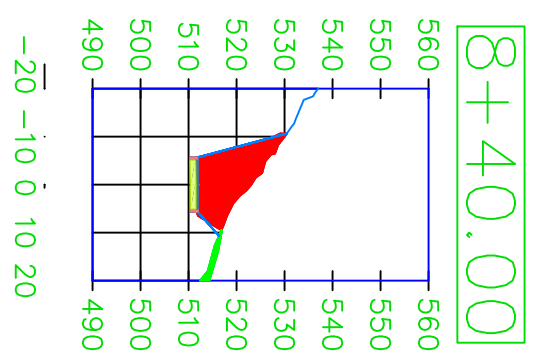
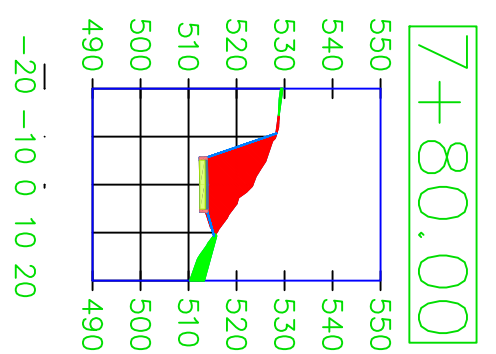
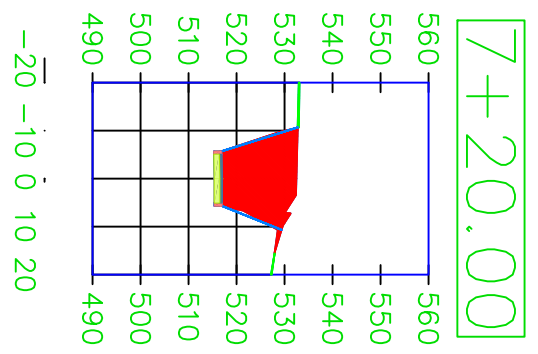

OPTIONAL - NOT
CONSTRUCTION

CEE logo BW -- noText.tif

THE UNIVERSITY OF IOWA
CIVIL AND ENVIRONMENTAL ENGINEERING
 4105 SEAMANS CENTER FOR THE
 ENGINEERING ARTS AND SCIENCES
 103 S CAPITOL ST
 IOWA CITY, IOWA 52242
 PHONE: 319.335.5647
 FAX: 319.335.5660
 EMAIL: civil-hawks@uiowa.edu

PROJECT: CEE: 4850
 DATE : 5/08/20
 DRAWN BY: Stephanie Krogh

REVISION:

DOWNTOWN TO RIVERFRONT

RIVERVIEW PARK
 KEOKUK, IA 52632

SHEET NAME
 DEPOT TRAIL
 SECTION SHEET 3
 SHEET NO. 3

08

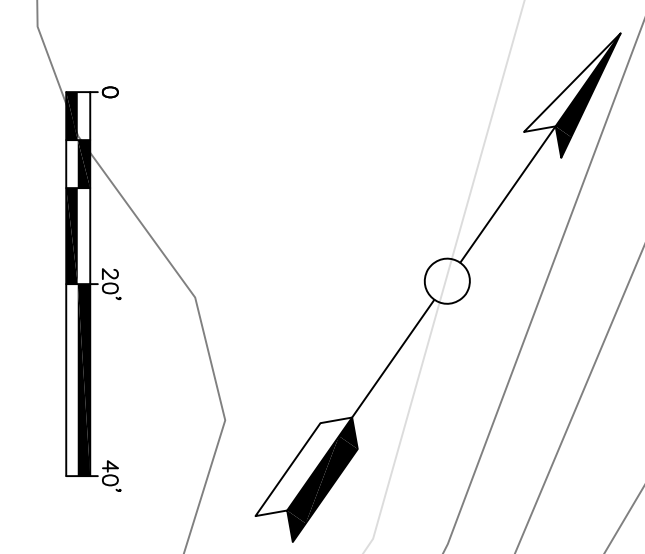
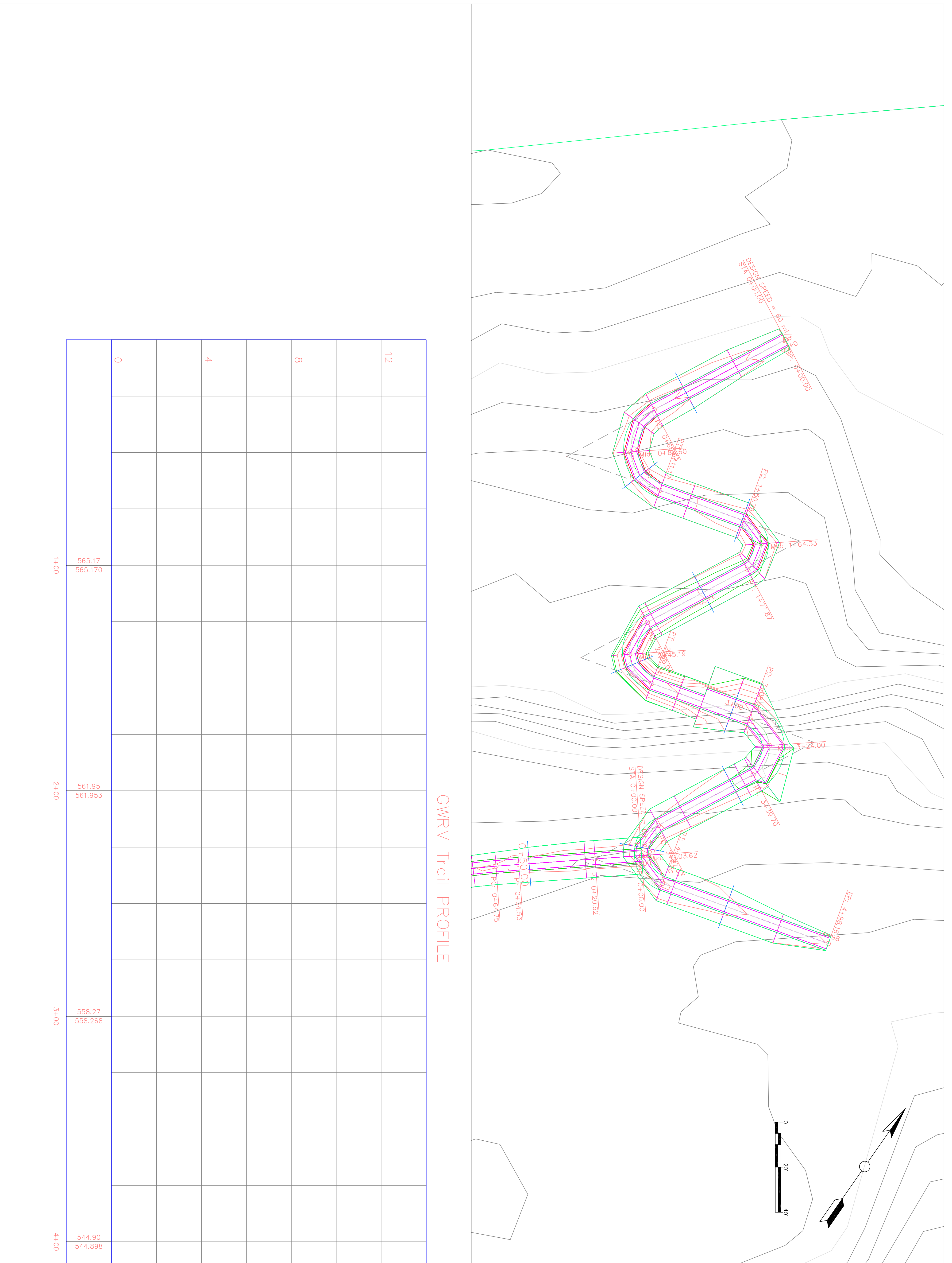

DOWNTOWN TO RIVERFRONT

RIVERVIEW PARK
KEOKUK, IA 52632

CAUTIONAL - NOT
CONSTRUCTION

CEE logo BW - noText.tif

THE UNIVERSITY OF IOWA CIVIL AND ENVIRONMENTAL ENGINEERING

4105 SEAMANS CENTER FOR THE
ENGINEERING ARTS AND SCIENCES
103 S CAPITOL ST
IOWA CITY, IOWA 52242
PHONE: 319.335.5647
FAX: 319.335.5660
EMAIL: civil-hawks@uiowa.edu

PROJECT:	CEE: 4850
DATE :	5/08/20
DRAWN BY:	Alexandra Martinez
REVISION:	

SHEET NAME
HIGHWAY TRAIL
PLAN AND PROFILE SHEET

SHEET NO. 1

9



GWRV Trail PROFILE

00	44	88	1212
----	----	----	------

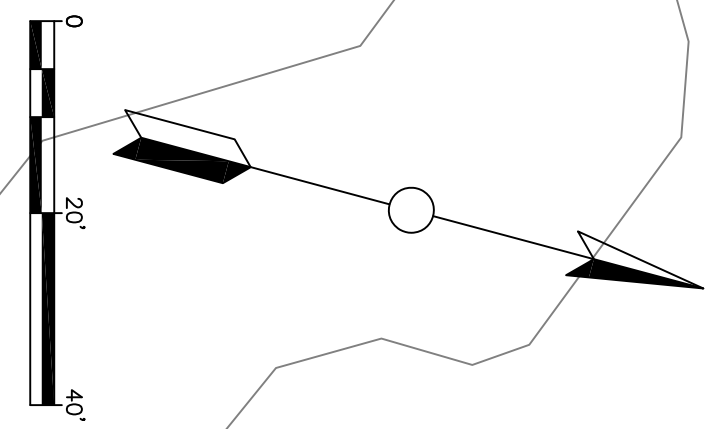

DOWNTOWN TO RIVERFRONT

RIVERVIEW PARK
KEOKUK, IA 52632

OPTIONAL - NOT FOR CONSTRUCTION

CEE logo BW - noText.tif

THE UNIVERSITY OF IOWA CIVIL AND ENVIRONMENTAL ENGINEERING

4105 SEAMANS CENTER FOR THE
ENGINEERING ARTS AND SCIENCES
103 S CAPITOL ST
IOWA CITY, IOWA 52242
PHONE: 319.335.5647
FAX: 319.335.5660
EMAIL: civil-hawks@uiowa.edu

PROJECT:	CEE: 4850
DATE :	5/08/20
DRAWN BY:	Alexandra Martinez
REVISION:	

SHEET NAME
HIGHWAY TRAIL
PLAN AND PROFILE SHI

SHEET NO.

10

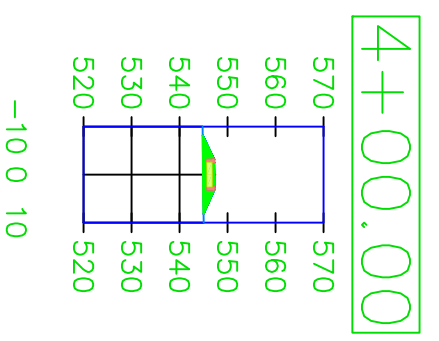
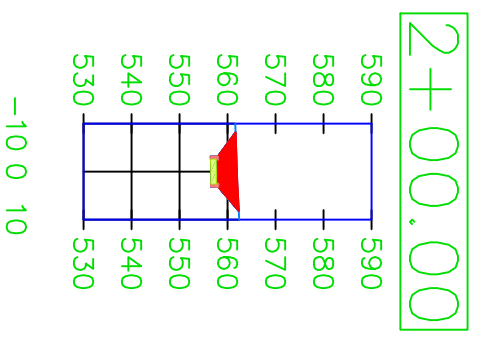
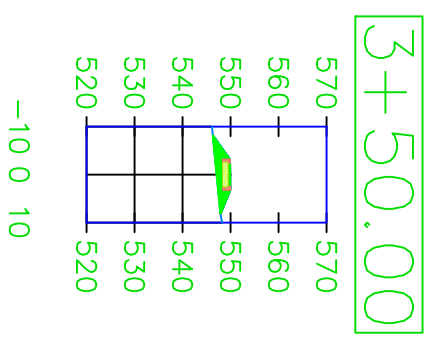
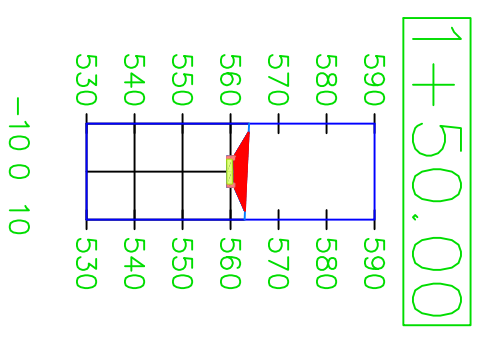
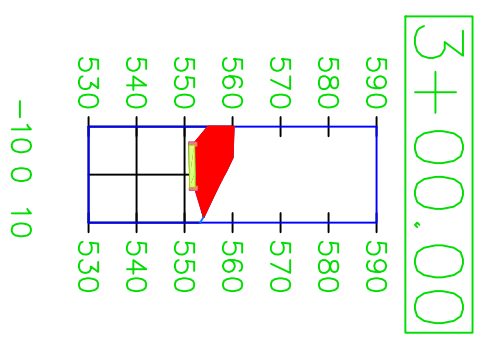
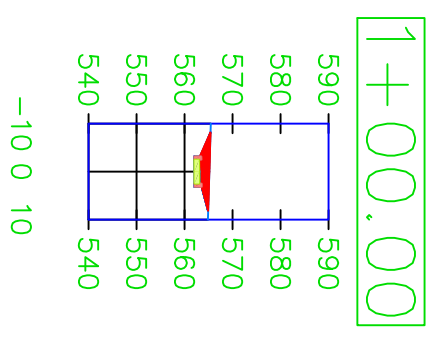
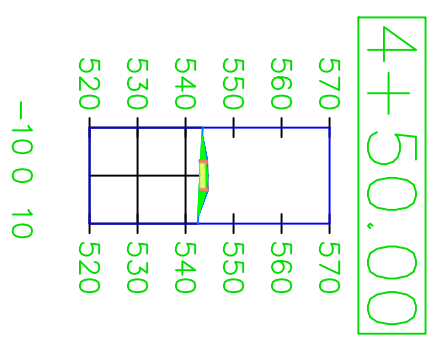
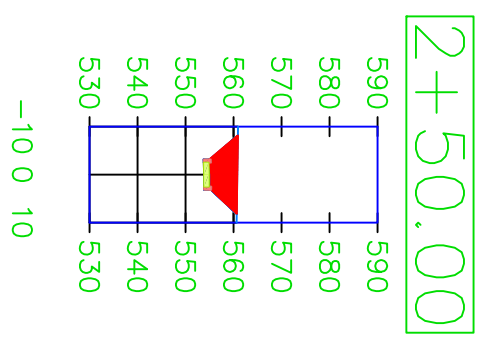
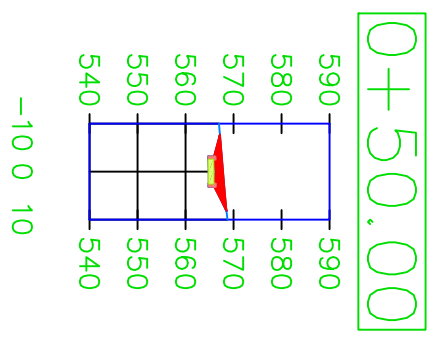

PROJECT:	CEE: 4850
DATE :	5/08/20
DRAWN BY:	Alexandra Martinez
REVISION:	

THE UNIVERSITY OF IOWA
CIVIL AND ENVIRONMENTAL ENGINEERING
 4105 SEAMANS CENTER FOR THE
 ENGINEERING ARTS AND SCIENCES
 103 S CAPITOL ST
 IOWA CITY, IOWA 52242
 PHONE: 319.335.5647
 FAX: 319.335.5660
 EMAIL: civil-hawks@uiowa.edu

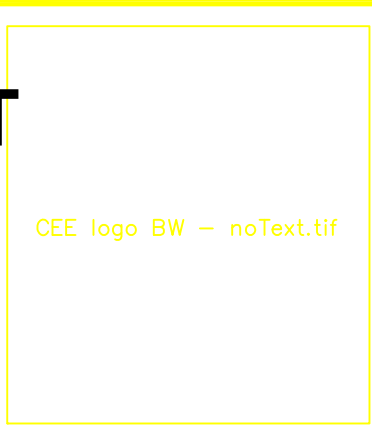

DOWNTOWN TO RIVERFRONT
 RIVERVIEW PARK
 KEOKUK, IA 52632

CAUTIONAL - NOT
 CONSTRUCTION

SHEET NAME
**HIGHWAY TRAIL
 SECTION SHEET**

SHEET NO. 11

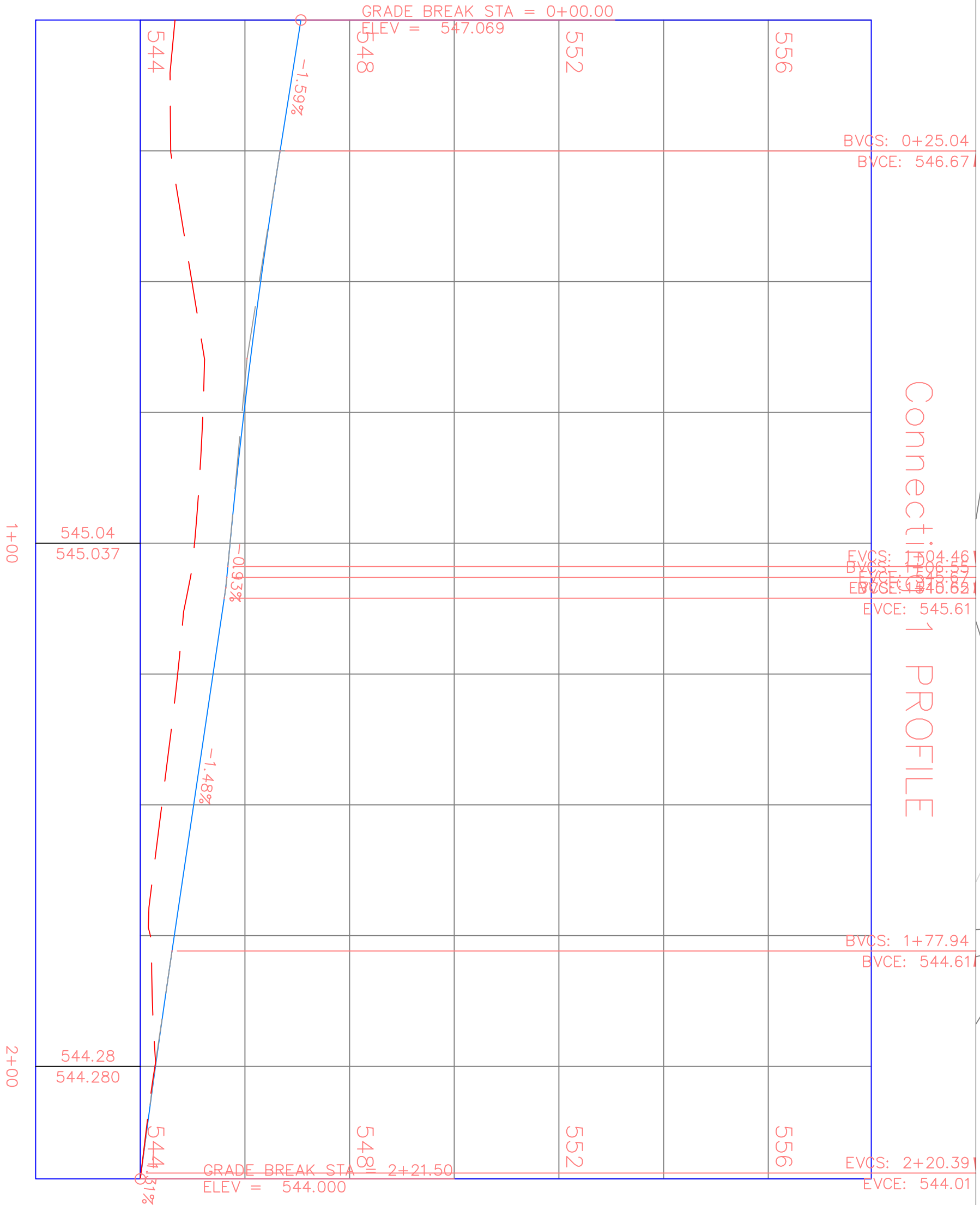
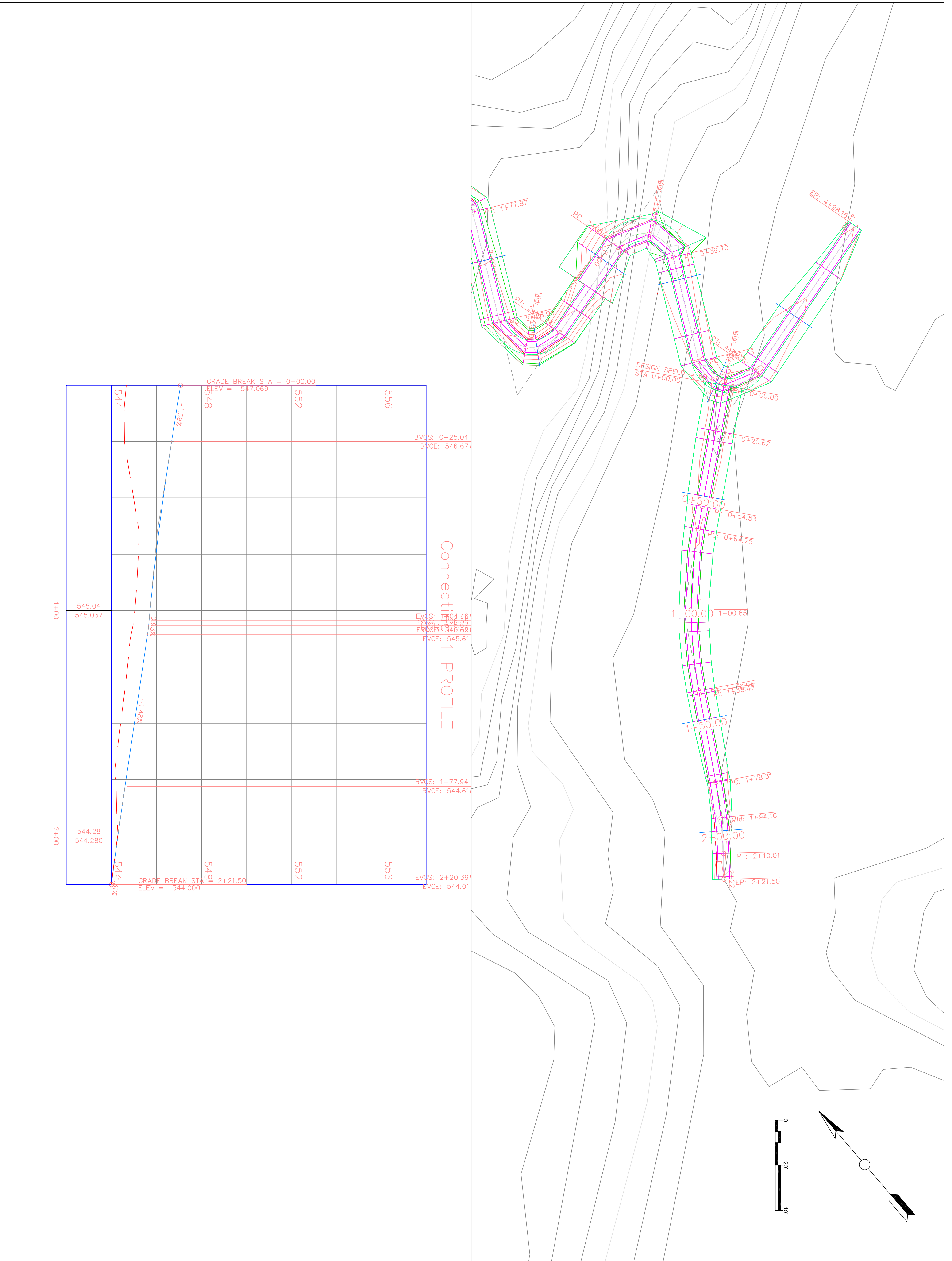

CONNECTING PROFILE

DOWNTOWN TO RIVERFRONT

RIVERVIEW PARK
KEOKUK, IA 52632

OPTIONAL - NOT
CONSTRUCTION

CEE logo BW - noText.tif

THE UNIVERSITY OF IOWA CIVIL AND ENVIRONMENTAL ENGINEERING

4105 SEAMANS CENTER FOR THE
ENGINEERING ARTS AND SCIENCES
103 S CAPITOL ST
IOWA CITY, IOWA 52242
PHONE: 319.335.5647
FAX: 319.335.5660
EMAIL: civil-hawks@uiowa.edu

PROJECT:	CEE: 4850
DATE :	5/08/20
DRAWN BY:	Alexandra Martinez
REVISION:	

SHEET NAME
GATEWAY TO RIVERFRON
PLAN AND PROFILE SHEET

SHEET NO | 1

12

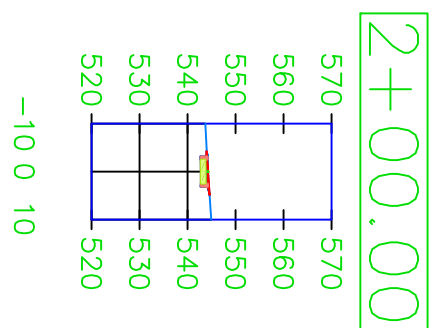
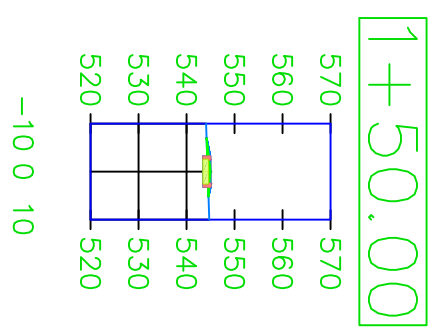
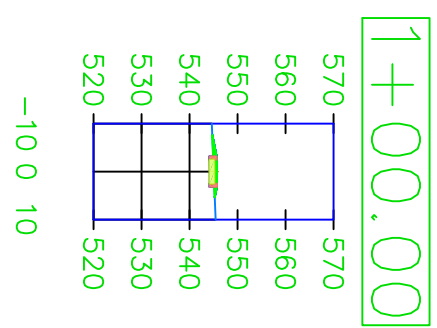
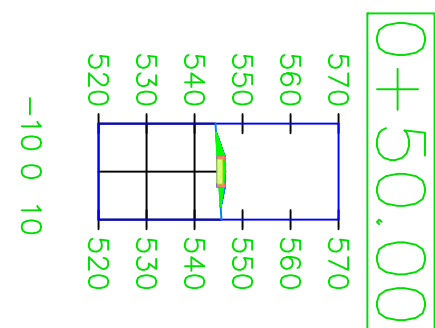

DOWNTOWN TO RIVERFRONT

RIVERVIEW PARK
KEOKUK, IA 52632

OPTIONAL - NOT
CONSTRUCTION

CEE logo BW -- noText.tif

THE UNIVERSITY OF IOWA CIVIL AND ENVIRONMENTAL ENGINEERING

4105 SEAMANS CENTER FOR THE
ENGINEERING ARTS AND SCIENCES
103 S CAPITOL ST
IOWA CITY, IOWA 52242
PHONE: 319.335.5647
FAX: 319.335.5660
EMAIL: civil-hawks@uiowa.edu

PROJECT:	CEE: 4850
DATE :	5/08/20
DRAWN BY:	Alexandra Martinez
REVISION:	

SHEET NAME

GATEWAY TO RIVERFRONT TRAIL
SECTION SHEET

SHEET NO.

13

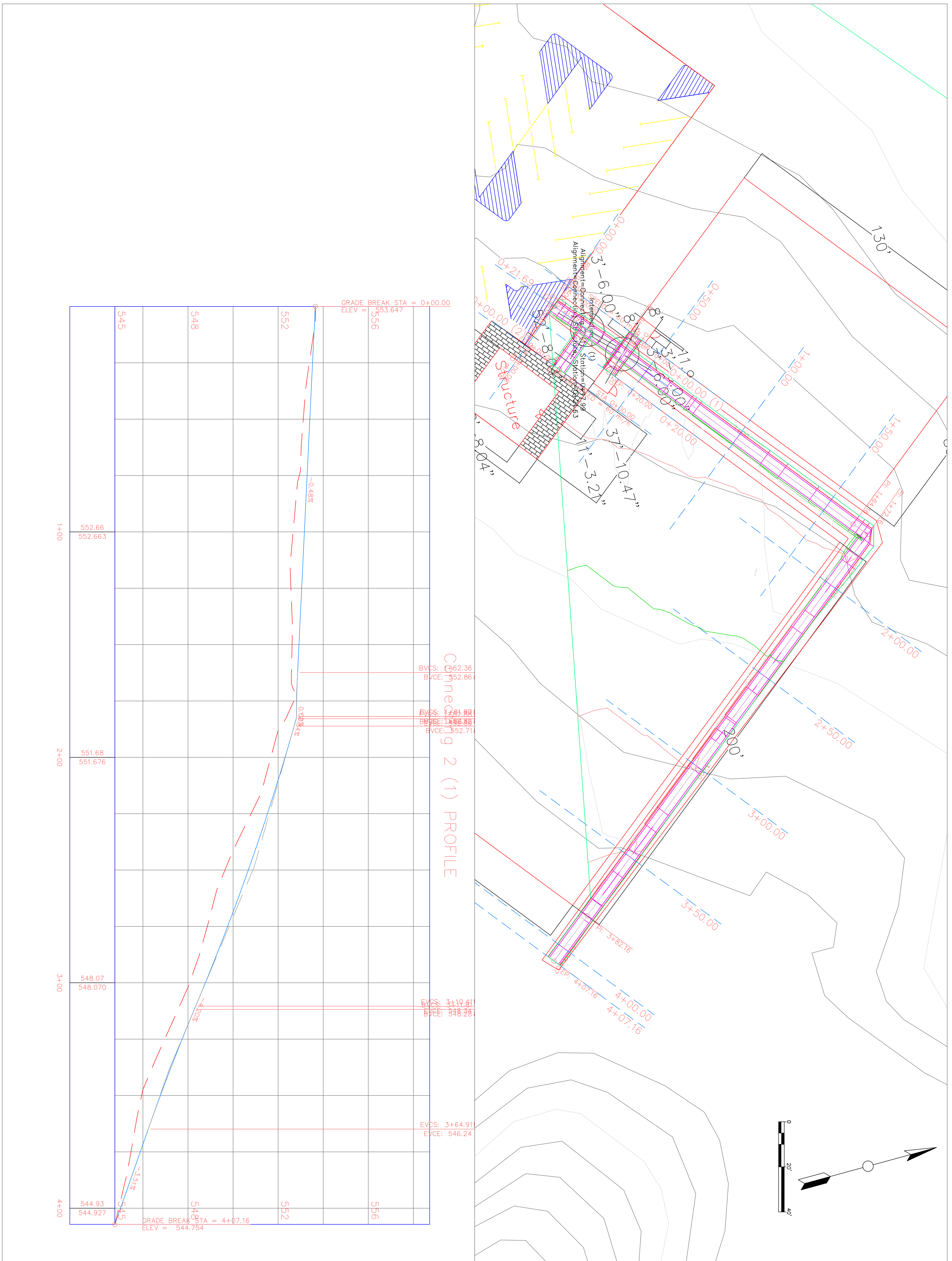

DOWNTOWN TO RIVERFRONT

RIVERVIEW PARK
KEOKUK, IA 52632

CAUTIONAL - NOT
CONSTRUCTION

CEE logo BW - noText.tif

THE UNIVERSITY OF IOWA CIVIL AND ENVIRONMENTAL ENGINEERING

4105 SEAMANS CENTER FOR THE
ENGINEERING ARTS AND SCIENCES
103 S CAPITOL ST
IOWA CITY, IOWA 52242
PHONE: 319.335.5647
FAX: 319.335.5660
EMAIL: civil-hawks@uiowa.edu

PROJECT:	CEE: 4850
DATE :	5/08/20
DRAWN BY:	Alexandra Martinez
REVISION:	

SHEET NAME
RIVERVIEW PARK TRAIL
PLAN AND PROFILE SHEET
SHEET NO. 1

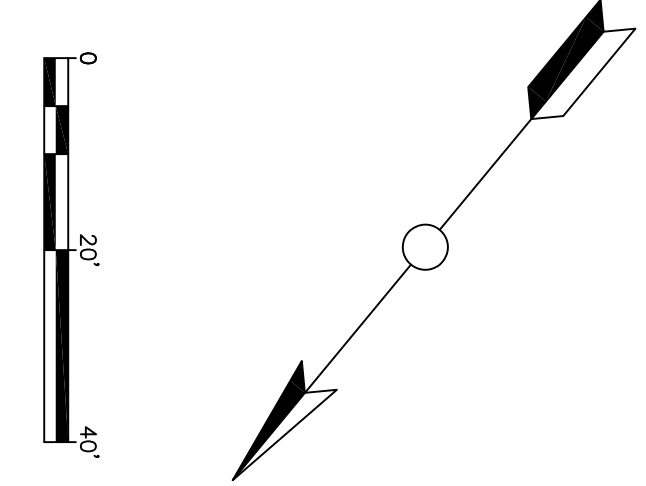
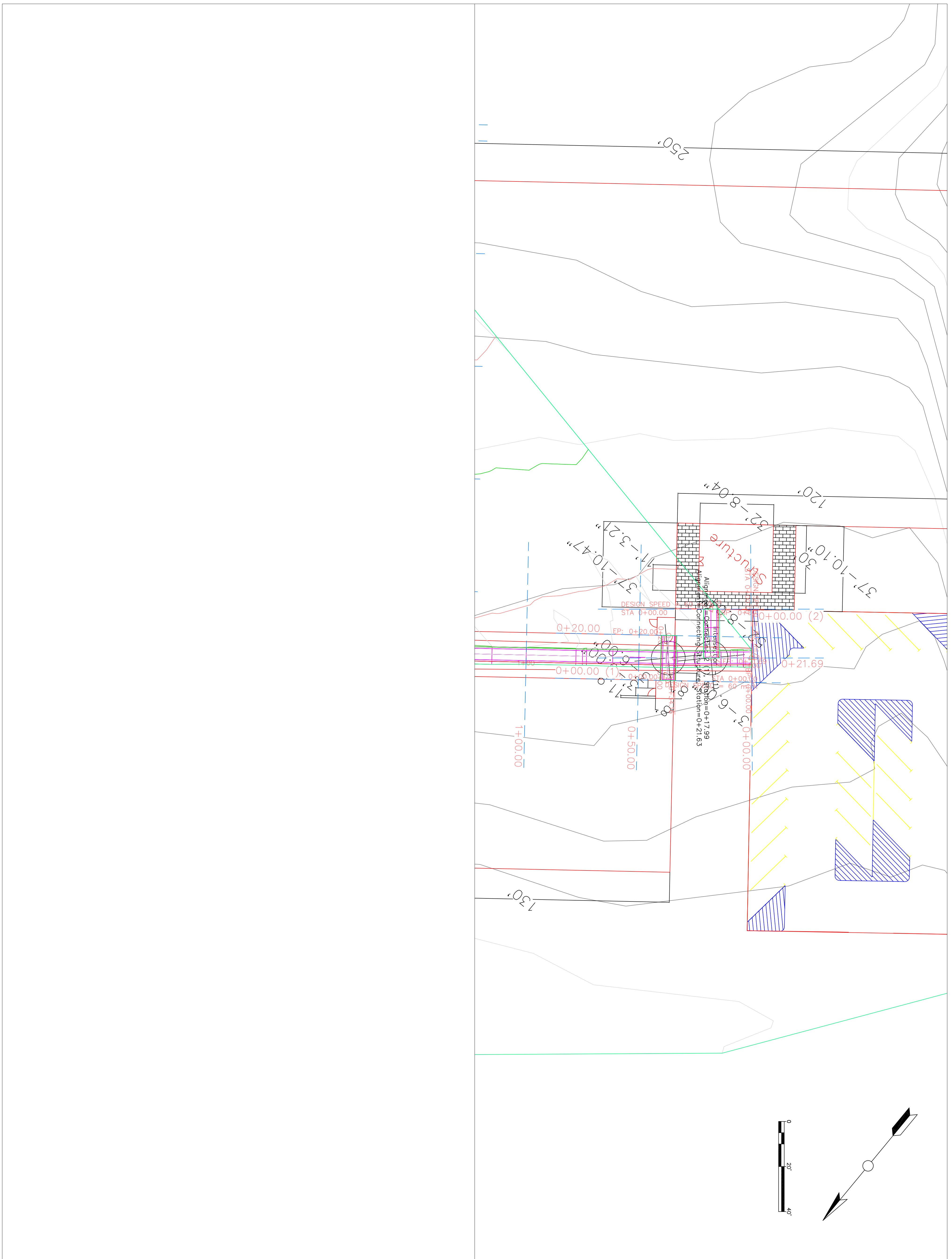

DOWNTOWN TO RIVERFRONT

RIVERVIEW PARK
KEOKUK, IA 52632

OPTIONAL - NOT FOR CONSTRUCTION

CEE logo BW - noText.tif

THE UNIVERSITY OF IOWA CIVIL AND ENVIRONMENTAL ENGINEERING

4105 SEAMANS CENTER FOR THE
ENGINEERING ARTS AND SCIENCES
103 S CAPITOL ST
IOWA CITY, IOWA 52242
PHONE: 319.335.5647
FAX: 319.335.5660
EMAIL: civil-hawks@uiowa.edu

PROJECT:	CEE: 4850
DATE :	5/08/20
DRAWN BY:	Alexandra Martinez
REVISION:	

SHEET NAME
RIVERVIEW PARK TRAIL
PLAN AND PROFILE SHEET

SHEET NO. 1

15

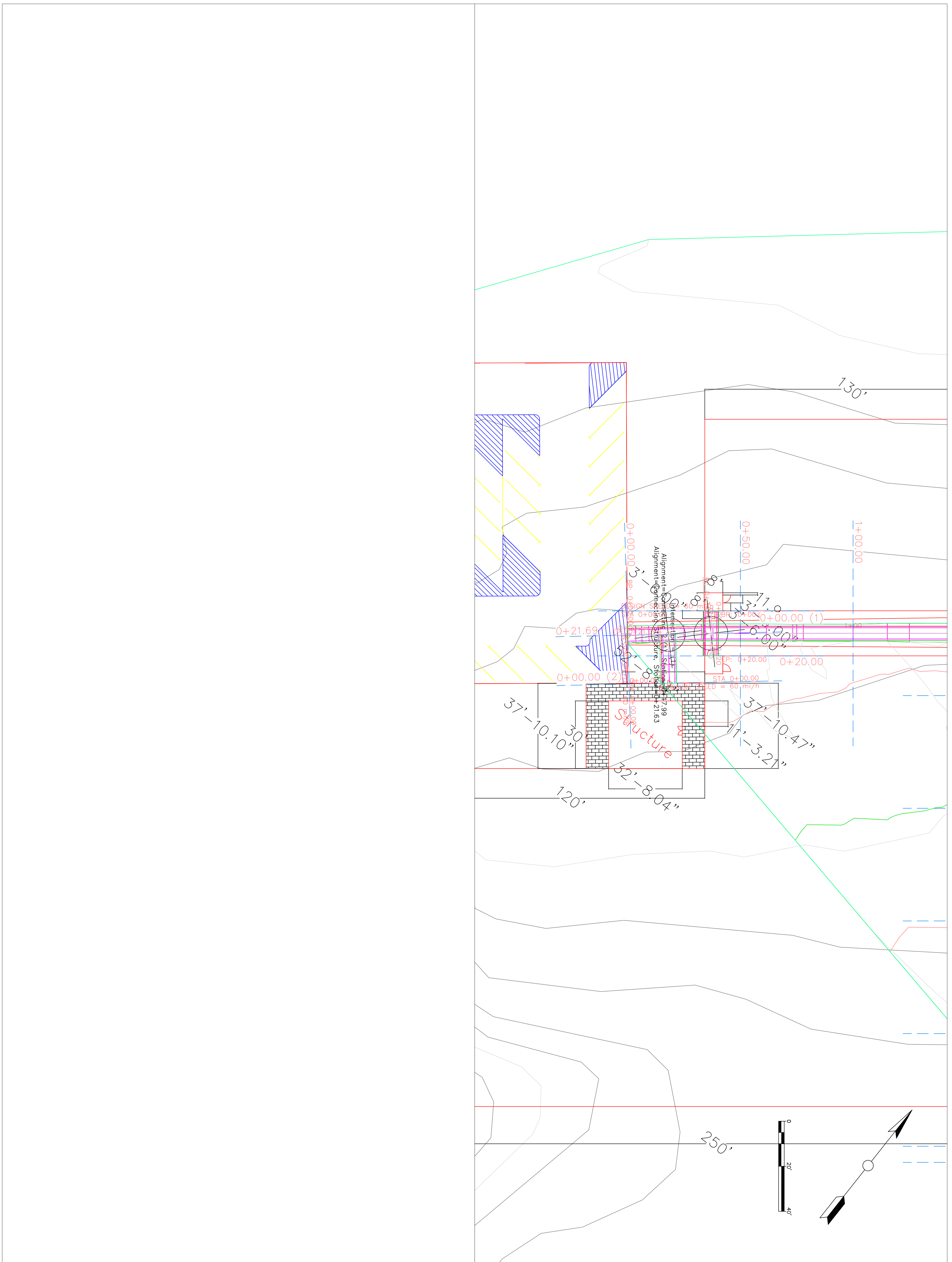

DOWNTOWN TO RIVERFRONT

RIVERVIEW PARK
KEOKUK, IA 52632

OPTIONAL - NOT
FOR CONSTRUCTION

CEE logo BW - noText.tif

THE UNIVERSITY OF IOWA CIVIL AND ENVIRONMENTAL ENGINEERING

4105 SEAMANS CENTER FOR THE
ENGINEERING ARTS AND SCIENCES
103 S CAPITOL ST
IOWA CITY, IOWA 52242
PHONE: 319.335.5647
FAX: 319.335.5660
EMAIL: civil-hawks@uiowa.edu

PROJECT: CEE: 4850

DATE : 5/08/20

DRAWN BY: Alexandra Martinez

REVISION:

SHEET NAME

RIVERVIEW PARK TRAIL
PLAN AND PROFILE SHEET

SHEET NO. 1

16

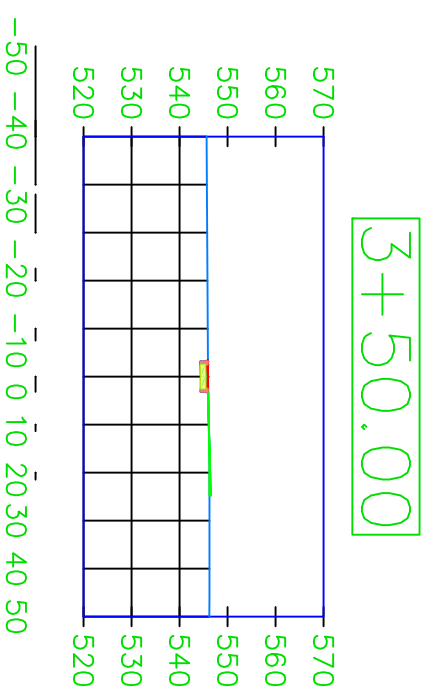
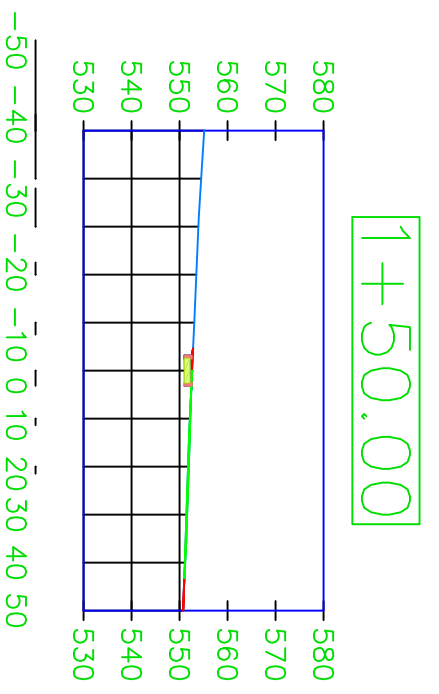
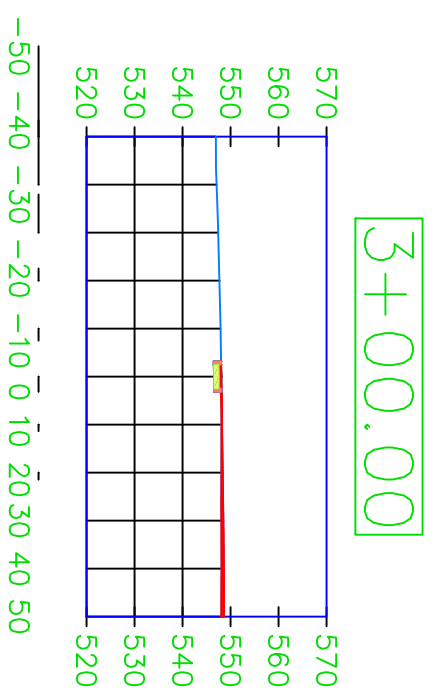
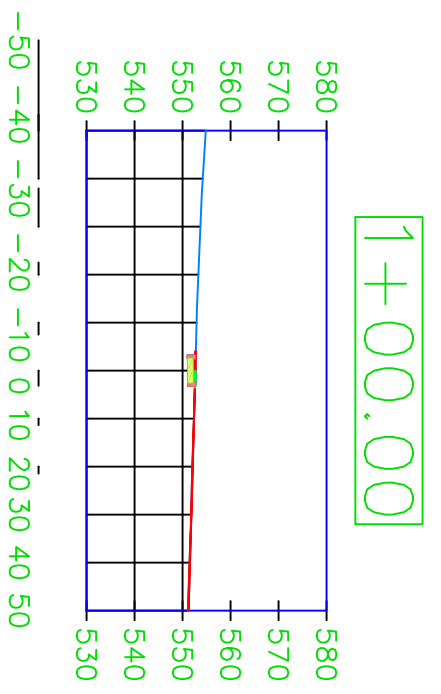
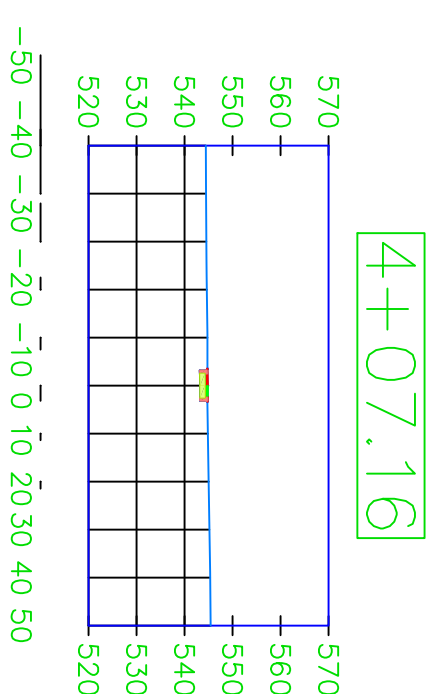
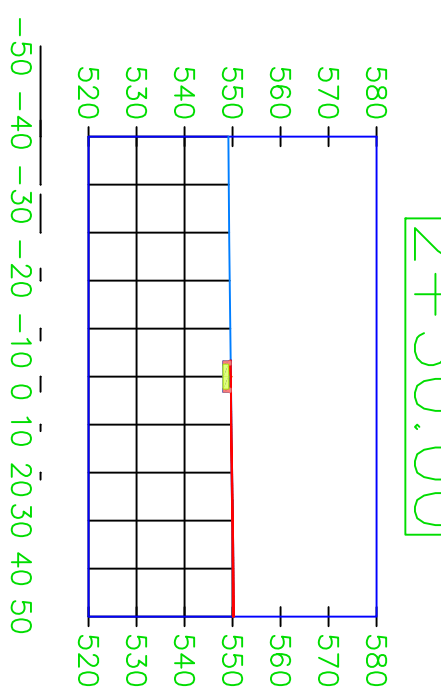
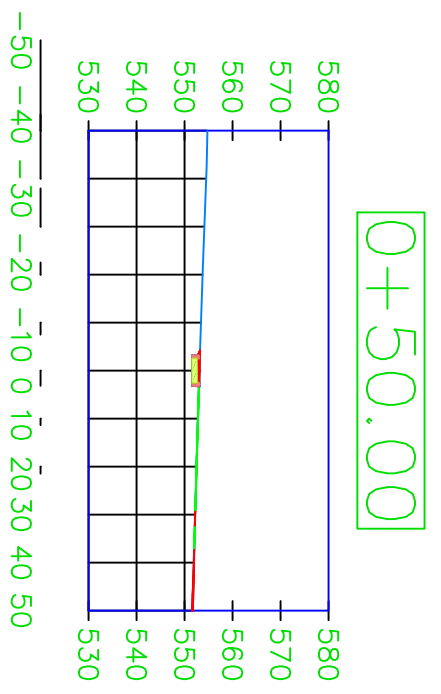
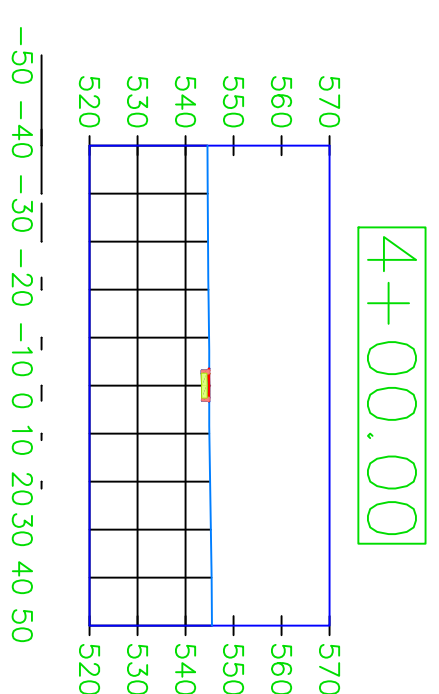
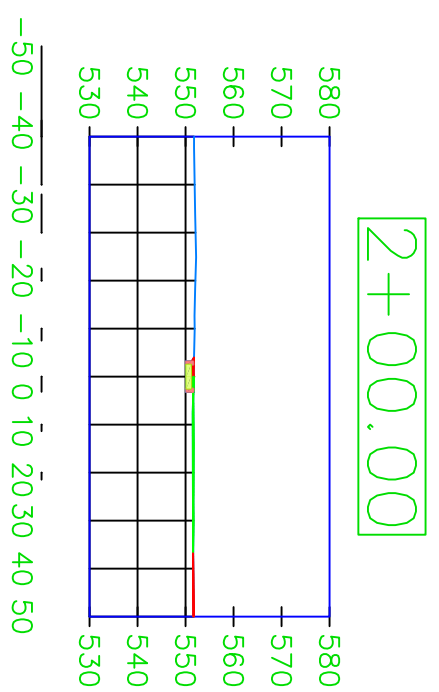
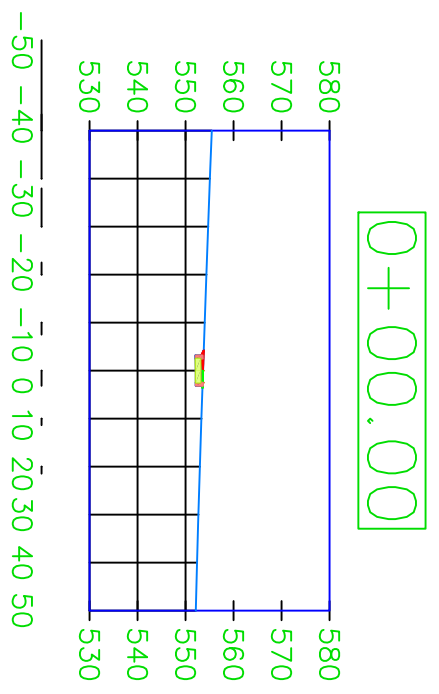

PROJECT:	CEE: 4850
DATE :	5/08/20
DRAWN BY:	Alexandra Martinez
REVISION:	

THE UNIVERSITY OF IOWA
CIVIL AND ENVIRONMENTAL ENGINEERING
 4105 SEAMANS CENTER FOR THE
 ENGINEERING ARTS AND SCIENCES
 103 S CAPITOL ST
 IOWA CITY, IOWA 52242
 PHONE: 319.335.5647
 FAX: 319.335.5660
 EMAIL: civil-hawks@uiowa.edu

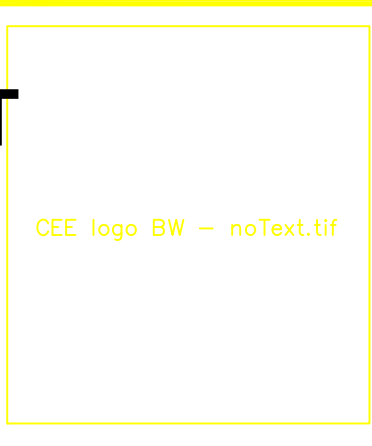

CAUTIONAL - NOT
 CONSTRUCTION

DOWNTOWN TO RIVERFRONT

RIVERVIEW PARK
 KEOKUK, IA 52632

SHEET NAME
 RIVERVIEW PARK TRAIL
 SECTION SHEET 1
 SHEET NO. 17

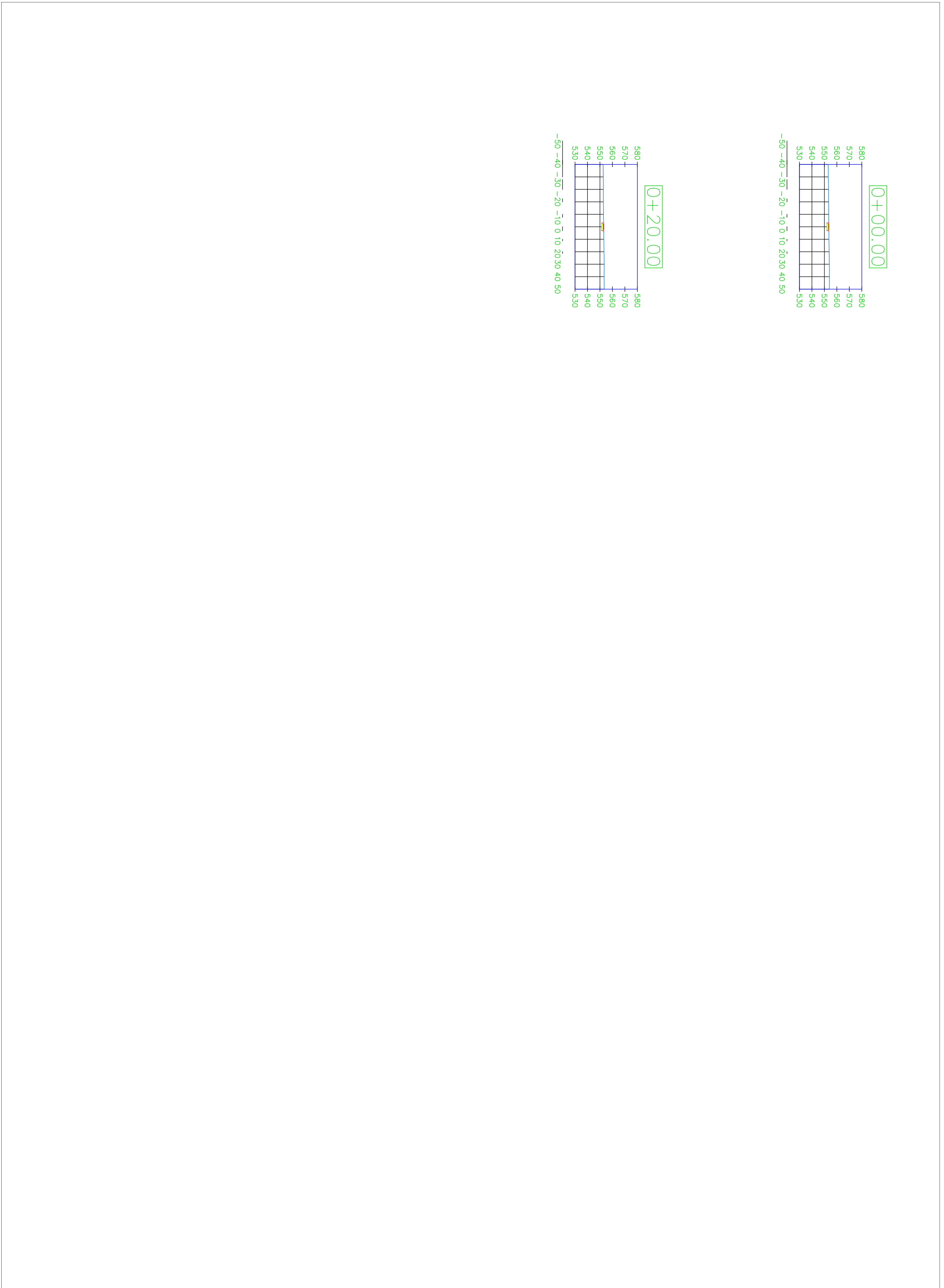

DOWNTOWN TO RIVERFRONT

RIVERVIEW PARK
KEOKUK, IA 52632

CAUTIONAL - NOT
CONSTRUCTION

CEE logo BW -- noText.tif

THE UNIVERSITY OF IOWA CIVIL AND ENVIRONMENTAL ENGINEERING

4105 SEAMANS CENTER FOR THE
ENGINEERING ARTS AND SCIENCES
103 S CAPITOL ST
IOWA CITY, IOWA 52242
PHONE: 319.335.5647
FAX: 319.335.5660
EMAIL: civil-hawks@uiowa.edu

PROJECT: CEE: 4850

DATE : 5/08/20

DRAWN BY: Alexandra Martinez

REVISION:

SHEET NAME

RIVERVIEW PARK TRAIL
SECTION SHEET 2

SHEET NO.

18

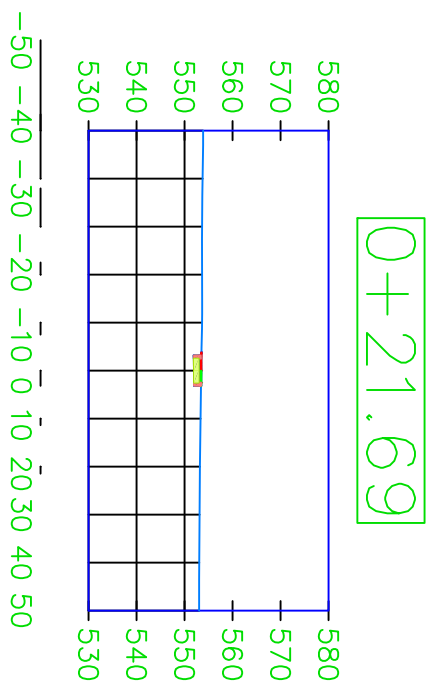
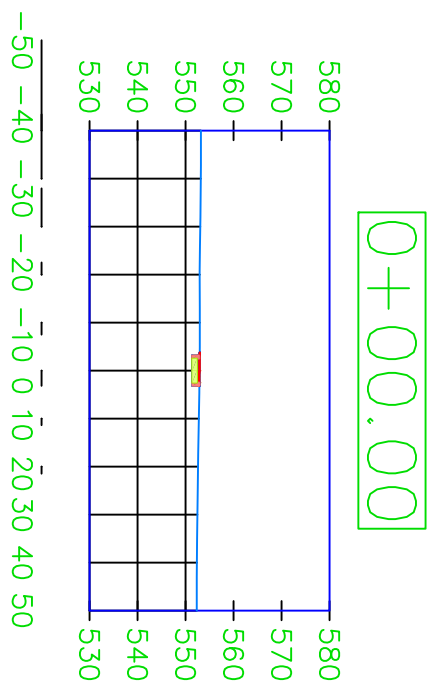

CUTIONAL - NOT
CONSTRUCTION

CEE Logo BW -- noText.tif

**THE UNIVERSITY OF IOWA
CIVIL AND ENVIRONMENTAL ENGINEERING**

4105 SEAMANS CENTER FOR THE
ENGINEERING ARTS AND SCIENCES
103 S CAPITOL ST
IOWA CITY, IOWA 52242
PHONE: 319.335.5647
FAX: 319.335.5660
EMAIL: civil-hawks@uiowa.edu

PROJECT: CEE: 4850

DATE : 5/08/20

DRAWN BY: Alexandra Martinez

REVISION:

DOWNTOWN TO RIVERFRONT

RIVERVIEW PARK
KEOKUK, IA 52632

SHEET NAME

RIVERVIEW PARK TRAIL
SECTION SHEET 3

SHEET NO.

19

- Note:
1. This is the floor plan of structure.
 2. The right bathroom is for man and the left i for woman
 3. The storm shelter can protect 50 peoples.

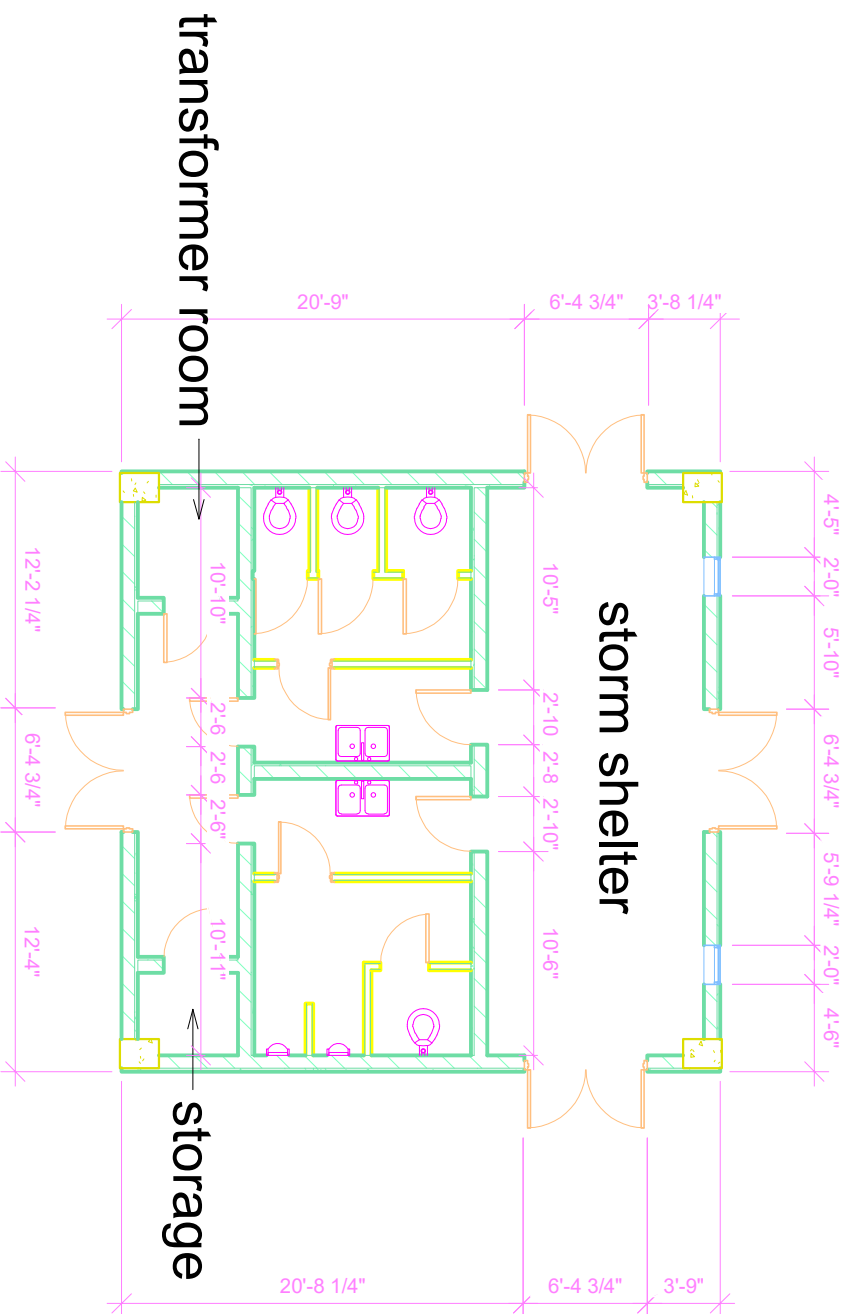

- Note:
- 1.This is the front view of the structure.
 - 2.The top 1/3 part of the wall is used by light weight concreteand the other is used by common bricks.
 - 3.below the floor it is the column footing(below level 4 footing)
 - 4.There are three Howe 6 panel trusses
 - 5.The roof is made by acoustic
 - 6.the dimension of each rectangular footing is 6ft times 6 ft times 28in
 - 7.the total height of the structure is 15 ft
 - 8.the concrete column extruded underground by 10ft
 - 9.

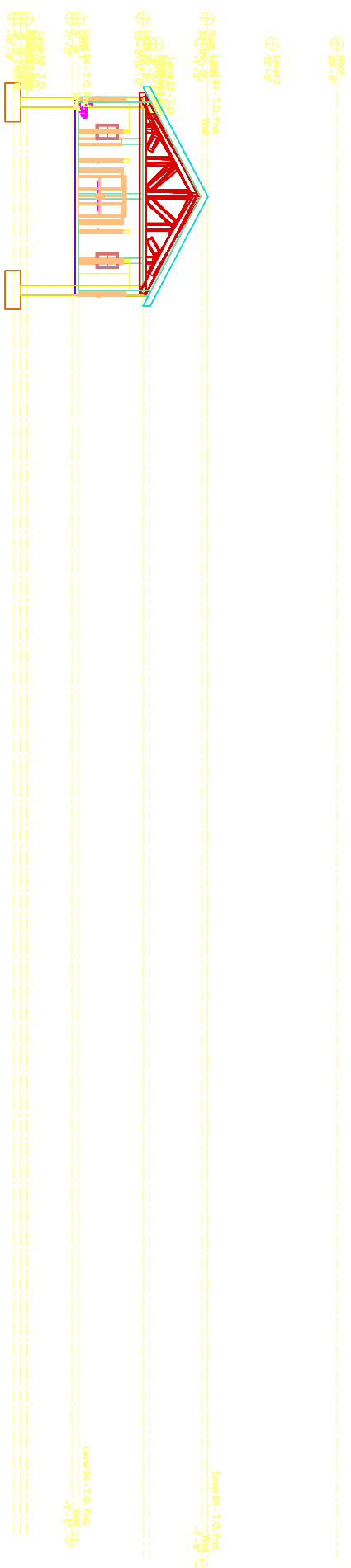

PROJECT:	CEE: 4850
DATE :	5/4/2020
DRAWN BY:	SAZA
REVISION:	

THE UNIVERSITY OF IOWA
 CIVIL AND ENVIRONMENTAL ENGINEERING
 4105 SEAMANS CENTER FOR THE
 ENGINEERING ARTS AND SCIENCES
 103 S CAPITOL ST
 IOWA CITY, IOWA 52242
 PHONE: 319.335.5647
 FAX: 319.335.5660
 EMAIL: civil-hawks@uiowa.edu



EDUCATIONAL, NOT FOR CONSTRUCTION

riverfront park
 Keokuk
 Keokuk

SHEET NAME	structure riverfront
SHEET NO.	2

Note:
 This is the back view of the structure
 The back view has two windows and one door access to the stormshelter.

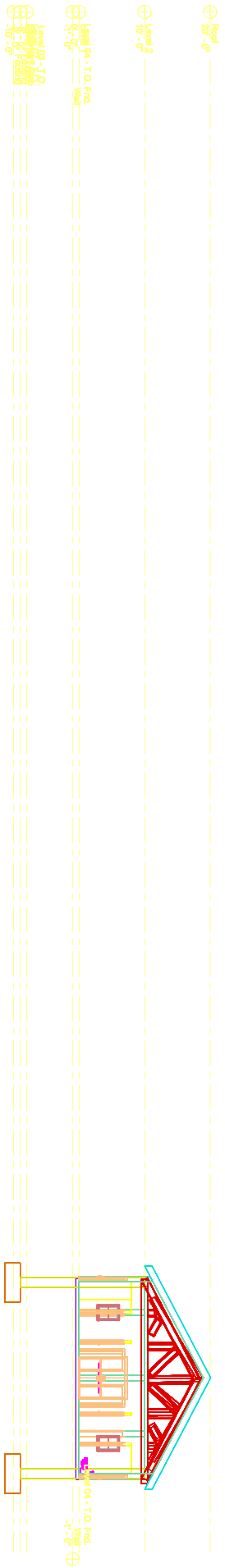

PROJECT:	CEE: 4850
DATE :	4/17/2020
DRAWN BY:	Zihan Wang
REVISION:	

THE UNIVERSITY OF IOWA
CIVIL AND ENVIRONMENTAL ENGINEERING
 4105 SEAMANS CENTER FOR THE
 ENGINEERING ARTS AND SCIENCES
 103 S CAPITAL ST
 IOWA CITY, IOWA 52242
 PHONE: 319.335.5647
 FAX: 319.335.5660
 EMAIL: civil-hawks@uiowa.edu



riverfront
 riverfront park
 Keokuk

SHEET NAME
 3
 back

SHEET NO.
23

Note:
 This is the right view of the structure
 The trusses is 6 panel Howe made by wood.
 There is one door on the right side that can access to
 storm shelter.

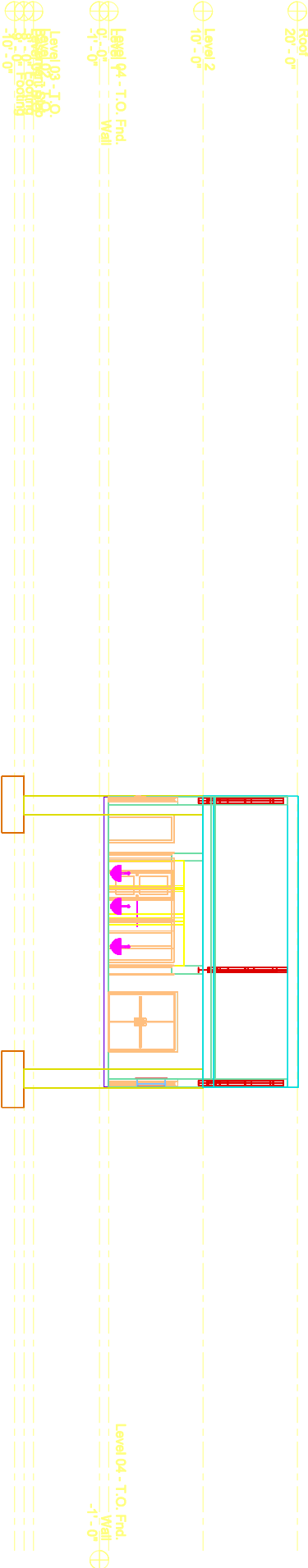

PROJECT:	CEE: 4850
DATE :	4/17/2020
DRAWN BY:	Zihan Wang
REVISION:	

THE UNIVERSITY OF IOWA
 CIVIL AND ENVIRONMENTAL ENGINEERING
 4105 SEAMANS CENTER FOR THE
 ENGINEERING ARTS AND SCIENCES
 103 S CAPITAL ST
 IOWA CITY, IOWA 52242
 PHONE: 319.335.5647
 FAX: 319.335.5660
 EMAIL: civil-hawks@uiowa.edu



riverfront
 riverfront
 Keukok

SHEET NAME
 4
 right
 SHEET NO.
24

Note:
This is the left view of the structure
The left view has a door access to storm shelter

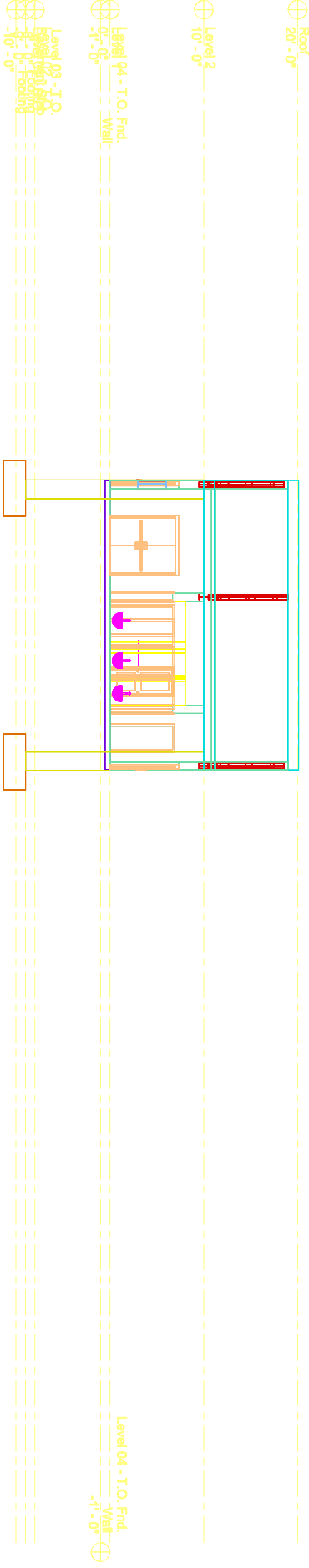

PROJECT:	CEE: 4850
DATE :	4/17/2020
DRAWN BY:	Zihan Wang
REVISION:	

THE UNIVERSITY OF IOWA
 CIVIL AND ENVIRONMENTAL ENGINEERING
 4105 SEAMANS CENTER FOR THE
 ENGINEERING ARTS AND SCIENCES
 103 S CAPITAL ST
 IOWA CITY, IOWA 52242
 PHONE: 319.335.5647
 FAX: 319.335.5660
 EMAIL: civil-hawks@uiowa.edu



riverfront
 riverfront park
 Keokuk

SHEET NAME
 3
 back

SHEET NO.
25

EDUCATIONAL, NOT FOR CONSTRUCTION